



Planning & Building Department  
6280 W 800N  
McCordsville, IN 46055  
Phone: 317.335.3604  
Email: [building@mccordsville.org](mailto:building@mccordsville.org)

---

### **PUBLIC HEARING INFORMATION**

Case #: BZA-20-013

Title: Chris William's request for Special Exception

Meeting Date: this zoning petition is currently scheduled to be heard at the November 4th Board of Zoning Appeals meeting.

\*Meeting agenda and staff report will be available on the website by end of business day on the Friday preceding the applicable meeting. Go to [www.mcccordsville.org](http://www.mcccordsville.org) and click on "Agendas & Minutes".



**MCCORDSVILLE BOARD OF ZONING APPEALS  
SPECIAL EXCEPTION APPLICATION**

Zoning Ordinance Section 10.04

**Applicant Information**

Name: Chris Williams

Current Address: 6188 W Broadway  
(Number) (Street)

McCordsville Ind 46055  
(City) (State) (Zip)

Phone No.: 317 473-9405 E-mail Address: ChrisW79164(A)@yahoo.com

**Property Owner Information** (the "owner" does not include tenants or contract buyers)

Name: Chris Williams

Current Address: 618 W Broadway  
(Number) (Street)

McCordsville Ind 46055  
(City) (State) (Zip)

Phone No.: 317 473 9405 E-mail Address: ChrisW79164(A)@yahoo.com

**Property Information**

Current Address: 6188 W Broadway  
(Number) (Street)

**OR** General Location (if no address has been assigned, please provide a street corner, subdivision lot number, or attach a legal description)

\_\_\_\_\_  
\_\_\_\_\_

**Administrative Officer Use Only:**

Existing Zoning: \_\_\_\_\_

Future Land Use: \_\_\_\_\_

Date Application Filed: \_\_\_\_\_

Docket No.: \_\_\_\_\_

**Special Exception Requested**

I am requesting a special exception as listed by Section \_\_\_\_\_ of the Zoning Ordinance to allow the following:

I WANT TO PUT A 18x21 CARPORT  
ON MY PROPERTY SO I CAN PARK MY  
VEHICLES IN

**Special Exception Criteria**

The McCordsville Zoning Ordinance establishes specific criteria that must be met in order for a special exception to be approved. Please answer each question below and if the response is "NO", describe why the special exception use requested does not meet the required criteria.

Will the special exception be served with adequate utilities, access roads, drainage, and other necessary facilities?

☒ YES

☐ NO, Please Explain (attach additional pages as necessary): \_\_\_\_\_

Will the special exception provide safe conditions that do not involve any element or cause any condition that may be dangerous, injurious, or noxious to any other property or persons, and comply with the development standards of the McCordsville Zoning Ordinance?

☒ YES

☐ NO, Please Explain (attach additional pages as necessary): \_\_\_\_\_

Will the special exception be sorted, oriented, and landscaped to produce a harmonious relationship of buildings and grounds to adjacent buildings and properties?

☒ YES

☐ NO, Please Explain (attach additional pages as necessary): \_\_\_\_\_

Will the special exception produce a total visual impression and environment which is consistent with the environment of the neighborhood?

☒ YES

☐ NO, Please Explain (attach additional pages as necessary): \_\_\_\_\_

Will the special exception organize vehicular access and parking to minimize traffic congestion in the area?



YES



NO, Please Explain (attach additional pages as necessary): \_\_\_\_\_

**Applicant's Signature**

The information included in and with this application is completely true and correct to the best of my knowledge and belief.

Ch A Wallin  
(Applicant's Signature)

10-8-20  
(Date)

**Owner's Signature** (the "owner" does not include tenants or contract buyers)

I authorize the filing of this application and will allow Town staff to enter this property for the purpose of processing this request. Further, I will allow a public notice sign to be placed and remain on the property until the processing of the request is complete.

Ch A Wallin  
(Owner's Signature)

10-8-20  
(Date)

Debban S. Williams  
(Owner's Signature)

10-8-2020  
(Date)



**Beacon**<sup>TM</sup>

Hancock County, IN

AREA FOR CARPORT

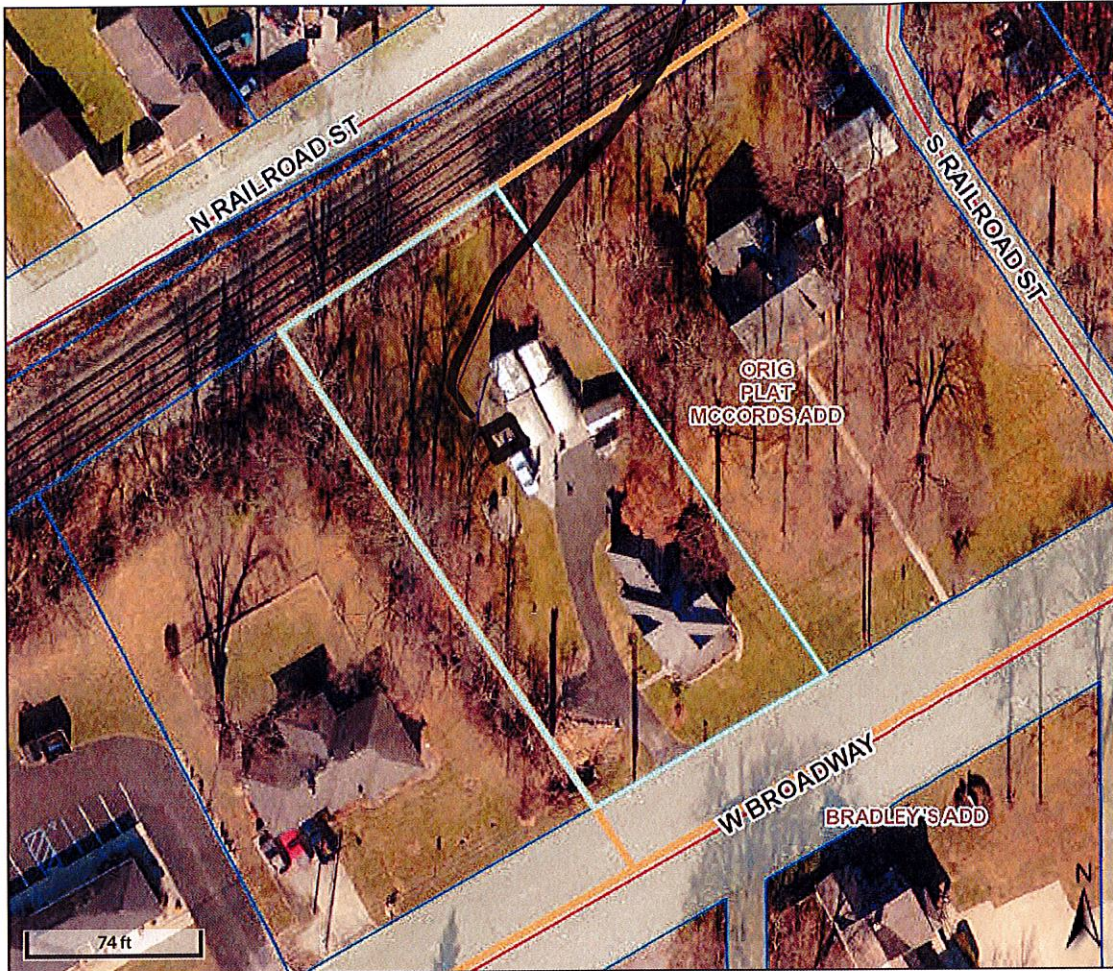

## Overview

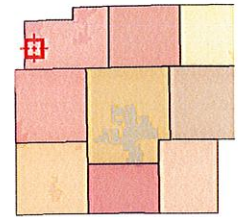

## Legend

## Roads

&lt;all other values&gt;

, PRIVATE

, PRIVATE

I, PUBLIC

S, PUBLIC

U, PUBLIC

Subdivisions

Rights of Way

Parcel Search

Parcel ID 30-01-26-101-004.002-018

Sec/Twp/Rng n/a

Property Address 6188 W Broadway  
McCordsville

Alternate ID 30-01-26-101-004.002-018

Class 1 Family Dwell - Platted Lot

Acreage 0.599

Owner Address Williams, Chris A &amp; Debbara S

6188 W Broadway

McCordsville, IN 46055

District MCCORDSVILLE TOWN

Brief Tax Description BRAD MC CORD WDL70

(Note: Not to be used on legal documents)

Date created: 10/6/2020

Last Data Uploaded: 10/6/2020 5:37:07 AM

Developed by Schneider  
GEOSPATIAL



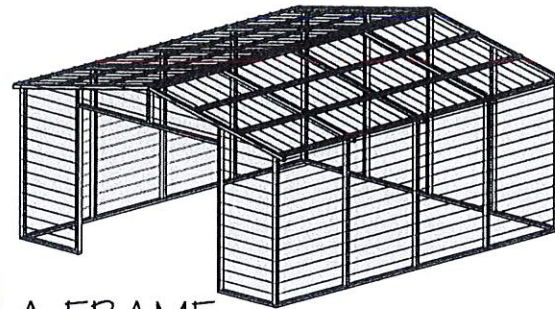
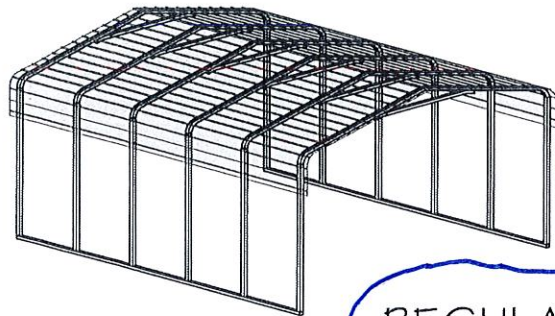

# REGULAR / A-FRAME 18'-0" WIDE CARPORT STYLE BUILDINGS

## DESIGN NOTES

1. ALL CONSTRUCTION SHALL BE PROVIDED IN ACCORDANCE WITH IBC 2012, OSHA, AISC 360, AISI 100, ASCE 7-10, AWS D 1.3 CODES AND ALL APPLICABLE LOCAL REQUIREMENTS.
2. BASE CONNECTIONS SHALL BE PROVIDED AS SHOWN ON FOUNDATION DETAILS SHEET.
3. ALL MATERIALS IDENTIFIED BY MANUFACTURER NAME MAY BE SUBSTITUTED WITH MATERIAL EQUAL OR EXCEEDING ORIGINAL.
4. ALL SHOP CONNECTIONS SHALL BE WELDED CONNECTIONS.
5. ALL FIELD CONNECTIONS SHALL BE #12x1" SDS (ESR-2196 OR EQ).
6. STEEL SHEATHING SHALL BE 29GA. CORRUGATED GALV. OR PAINTED STEEL - MAIN RIB HT. 3/4" (FY=80KSI) OR EQ.
7. ALL STRUCTURAL LIGHT GAUGE TUBING AND CHANNELS SHALL BE GRADE 50 STEEL.
8. STRUCTURAL TUBE TS2 1/2"x2 1/2" - 14GA. IS EQUIVALENT TO TS2 1/4"x2 1/4" - 12GA AND EITHER ONE MAY BE USED IN LIEU OF THE OTHER.
9. ALL DESIGN CRITERIA MUST BE INCREASED TO THE NEXT HIGHER INCREMENT BASED ON THE TABLES ON PAGE 4. NO INTERPOLATION IS ALLOWED.

## DESIGN CRITERIA

PREVAILING CODE:	INBC 2014 (IBC 2012)
USE GROUP:	U (CARPORTS, BARNS)
RISK CATEGORY:	I
1. DEAD LOAD (D)	D = 4 PSF
2. ROOF LIVE/SNOW LOAD (Lr)	Lr = 20 - 61 PSF (AS PER SNOW LOAD SEE TABLE 4)
3. SNOW LOAD (S)	
GROUND SNOW LOAD	P <sub>g</sub> = 20 - 90 PSF
IMPORTANCE FACTOR	I <sub>s</sub> = 0.8
THERMAL FACTOR	C <sub>t</sub> = 1.2
EXPOSURE FACTOR	C <sub>e</sub> = 1.0
ROOF SLOPE FACTOR	C <sub>s</sub> = 1.0
4. WIND LOAD (W)	
BASIC WIND SPEED	V <sub>ULT</sub> = 105 - 180 MPH
EXPOSURE	C
5. SEISMIC LOAD (E)	
DESIGN CATEGORY	D
IMPORTANCE FACTOR	I <sub>e</sub> = 1.00

### LOAD COMBINATIONS:

1. D + (Lr OR S)
2. D + (0.6W OR ±0.7E)
3. D + 0.75 (0.6W OR ±0.7E) + 0.75 (Lr OR S)
4. 0.6D + (0.6W OR ±0.7E)

## DRAWING INDEX

COVER SHEET	----	1
SCHEDULES & MEMBER -		
SECTIONS	----	2
FRAME SECTIONS & DETAILS	----	3
SPACING SCHEDULES -		
& ENCLOSURE NOTES	----	4
PURLIN & GIRT SCHEDULES	----	5
SHEATHING OPTIONS	----	6
SIDE WALL FRAMING		
& OPENINGS	----	7
END WALL FRAMING		
& OPENINGS	----	8-A, 8-B
CORNER BRACING DETAILS	----	9
OPTIONAL LEAN-TO ADDITION	----	10
FOUNDATION OPTIONS	----	11-A TO 11-D

MANUFACTURED BY:



457 N. Broadway,  
Joshua, TX 76058  
1-866-730-9865

ENGINEERED BY:



A&A ENGINEERING  
CIVIL & STRUCTURAL

6036 Renaissance Place, Toledo, OH 43623  
Tel. 419-292-1983 • Fax. 419-292-0955  
www.aa-engineers.com

## DRAWING INFORMATION

PROJECT: 18'-0" WIDE BUILDINGS

LOCATION: STATE OF INDIANA

PROJECT NO.: 033-20-0011

SHEET TITLE:

COVER SHEET

SHEET NO.: 1 / 11

DRAWN BY: A.W. DATE: 2/29/20

CHECKED BY: OAA DATE: 2/29/20

## LEGAL INFORMATION

- ANY DUPLICATION OF THIS DRAWING IN WHOLE OR PART IS STRICTLY FORBIDDEN. ANYONE DOING SO WILL BE PROSECUTED UNDER THE FULL EXTENT OF THE LAW.  
- DRAWINGS VALID UP TO DATE OF EXPIRATION.

SEAL:



## CUSTOMER INFORMATION

OWNER:  
ADDRESS:

## DESIGN LOADS

GROUND SNOW:

ROOF LIVE LOAD:

BASIC WIND SPEED:

## BUILDING INFORMATION

WIDTH:

LENGTH:

HEIGHT:

FRAME TYPE:

☐ A-FRAME  
☐ REGULAR

ENCLOSURE  
TYPE:

☐ FULL  
☐ PARTIAL  
☐ OPEN

## CERTIFICATION VALIDITY NOTICE

DATE OF PLANS  
EXPIRATION: **FEB 12 2021**

CERTIFICATION ON THESE DRAWINGS IS  
VALID FOR ONE YEAR FROM DATE OF ISSUE

STAMP EXPIRY: **07/31/2022**

DATE SIGNED: **FEB 12 2020**

TABLE 2.1: MEMBER PROPERTIES

NO.	LABEL	PROPERTY	DETAIL NO.
1	COLUMN POST	2.5" X 2.5" X 14GA TUBE	1
2	ROOF BEAM	2.5" X 2.5" X 14GA TUBE	1
3	BASE RAIL	2.5" X 2.5" X 14GA TUBE	1
4	PEAK BRACE	2.5" X 2.5" 14GA CHANNEL	4
5	KNEE BRACES	2.5" X 1.5" 14GA CHANNEL	4
6	CONNECTOR SLEEVE	2.25" X 2.25" X 12GA TUBE	2
7	BASE ANGLE	2" X 2" X 3" LG. 3/16" ANGLE	10
8	PURLIN	4.25" X 1.5" X 14GA / 18GA HAT CHANNEL	5
9	GIRT	4.25" X 1.5" X 14GA / 18GA HAT CHANNEL	5
9A	OPT. END WALL GIRT	2.5" X 1.5" 14GA CHANNEL	1
10	SHEATHING	29 GA CORRUGATED SHEET	8
11	END WALL POST	2.5" X 2.5" X 14GA TUBE	1
12	DOOR POST	2.5" X 2.5" X 14GA TUBE	1
13	SINGLE HEADER	2.5" X 2.5" X 14GA TUBE	1
14	DOUBLE HEADER	DBL. 2.5" X 2.5" X 14GA TUBE	1
15	SERVICE DOOR / WINDOW FRAMING	2.5" X 2.5" X 14GA TUBE	1
16	ANGLE BRACKET	2" X 2" X 2" LG. 14GA ANGLE	7
17	STRAIGHT BRACKET	2" X 2" X 4" LG. 14GA PLATE	6
18	PB SUPPORT	2.5" X 2.5" X 14GA TUBE	1
19	DIAGONAL BRACE	2" X 2" X 14 GA TUBE	3
20	GABLE BRACE	2" X 2" X 14 GA TUBE	3
21	DB BRACKET	2.25" X 2.25" X 6" LG. 14GA ANGLE	9
22	TRUSS SPACER	2.5" X 2.5" X 14GA TUBE	1
23	ALL FASTENERS	#12 X 1" SELF-DRILL SCREWS (ESR-2196 OR EQ) W/ NEOPRENE/STEEL WASHER	

TABLE 2.2: SHEATHING FASTENER SCHEDULE

LOCATION	CORNER PANELS	SIDE LAPS	EDGE LAPS	ELSEWHERE
SPACING	9" C/C	MIN. 1	4 1/2" C/C	9" C/C

FASTENER TYPE: #12X1" SELF-DRILL SCREWS (ESR-2196 OR EQ) W/ NEOPRENE/STEEL WASHER

\*SEE TYP. SHEATHING FASTENER SCHEDULE DIAGRAM ON PAGE 6.

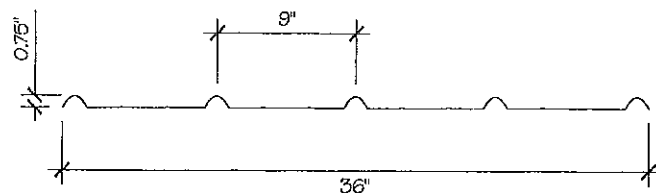

THICKNESS = 29GA  
29 GA CORRUGATED SHEATHING 8  
SCALE: NTS

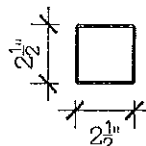

THICKNESS = 14GA  
2.5" X 2.5" 14GA TUBE 1  
SCALE: NTS

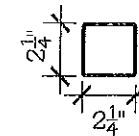

THICKNESS = 12GA  
2.25" X 2.25" 12GA TUBE 2  
SCALE: NTS

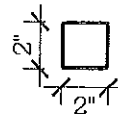

THICKNESS = 14GA  
2" X 2" 14GA TUBE 3  
SCALE: NTS

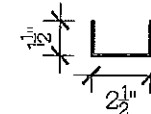

THICKNESS = 14GA  
2.5" X 1.5" 14GA CHANNEL 4  
SCALE: NTS

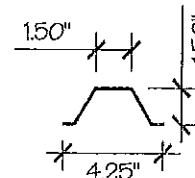

THICKNESS = 14GA / 18GA  
4.25" X 1.5" X 14GA / 18GA  
HAT CHANNEL 5  
SCALE: NTS

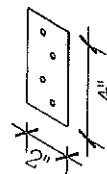

THICKNESS = 14GA  
STRAIGHT BRACKET 6  
SCALE: NTS

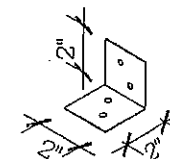

THICKNESS = 14GA  
ANGLE BRACKET 7  
SCALE: NTS

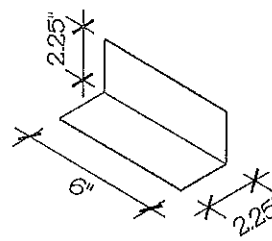

THICKNESS = 14GA  
DB BRACKET 9  
SCALE: NTS

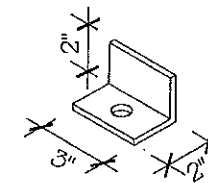

THICKNESS = 3/16"  
BASE ANGLE 10  
SCALE: NTS

MANUFACTURED BY:



457 N. Broadway,  
Joshua, TX 76058  
1-866-730-9865

ENGINEERED BY:



A&A ENGINEERING  
CIVIL & STRUCTURAL

6086 Renaissance Place, Toledo, OH 43623  
Tel. 419-292-1988 • Fax 419-292-0955  
www.a-a-engineers.com

## DRAWING INFORMATION

PROJECT: 18'-0" WIDE BUILDINGS

LOCATION: STATE OF INDIANA

PROJECT NO.: 033-20-0011

SHEET TITLE:

## SCHEDULES &amp; MEMBER SECTIONS

SHEET NO.: 2 / 11

DRAWN BY: A.W. DATE: 2/29/20

CHECKED BY: OAA DATE: 2/29/20

## LEGAL INFORMATION

- ANY DUPLICATION OF THIS DRAWING IN WHOLE OR PART IS STRICTLY FORBIDDEN. ANYONE DOING SO WILL BE PROSECUTED UNDER THE FULL EXTENT OF THE LAW.  
- DRAWINGS VALID UP TO DATE OF EXPIRATION.

SEAL:

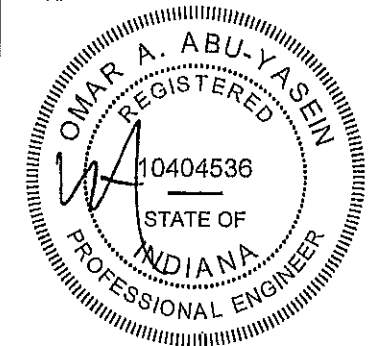

STAMP EXPIRY: 07/31/2022

DATE SIGNED: FEB 12 2020

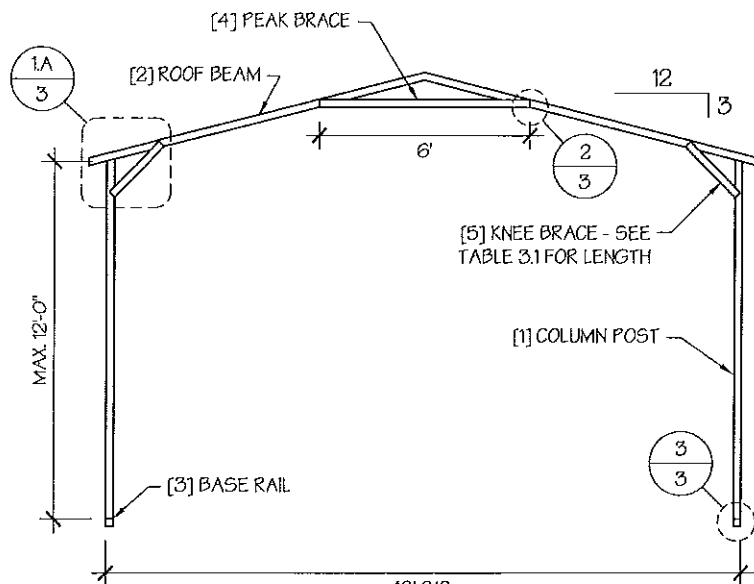

☐ TYP. A-FRAME SECTION  
SCALE: NTS

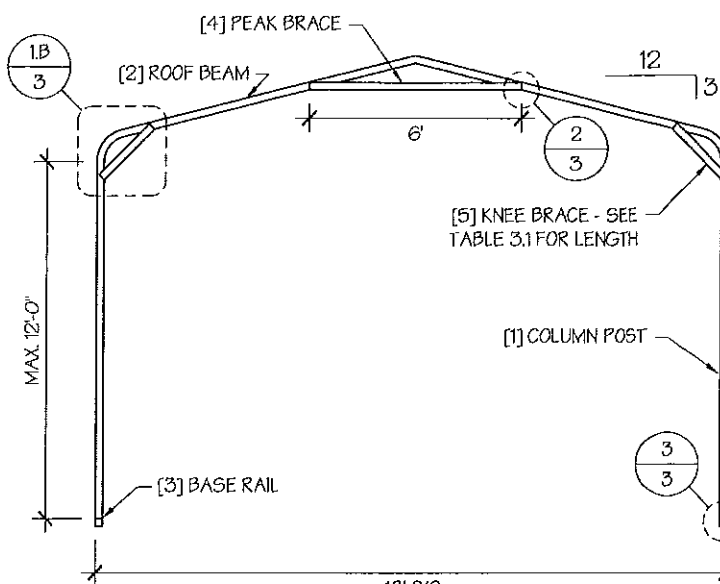

☐ TYP. REGULAR FRAME SECTION  
SCALE: NTS

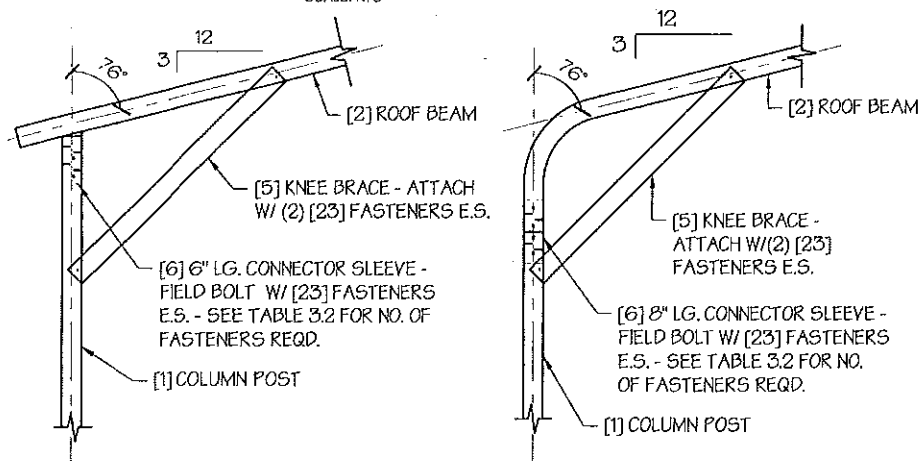

☐ A. 'A'-FRAME

**EAVE DETAIL**  
SCALE: NTS

☐ B. REGULAR FRAME

TABLE 3.1: KNEE BRACE SCHEDULE

EAVE HEIGHT	KNEE BRACE LENGTH
<input type="checkbox"/> UP TO 8'	24"
<input type="checkbox"/> 9' TO 12'	36"

TABLE 3.2 FASTENER SCHEDULE

WIND SPEED (MPH)	NO. OF FASTENERS
<input type="checkbox"/> 105 TO 125	4
<input type="checkbox"/> 130 TO 155	6
<input type="checkbox"/> 160 TO 180	8

NOTE: COLUMN POST MAY BE ADJUSTED  $\pm 1"$  FOR LEVELING.  
MANUFACTURER IS NOT RESPONSIBLE FOR LEVELING OF GROUND  
AND/OR CONCRETE SURFACE PROVIDED BY OTHERS.

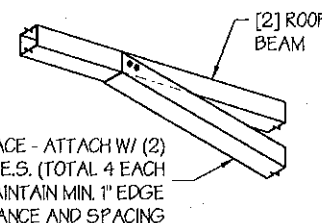

**PEAK BRACE CONNECTION DETAILS**  
SCALE: NTS

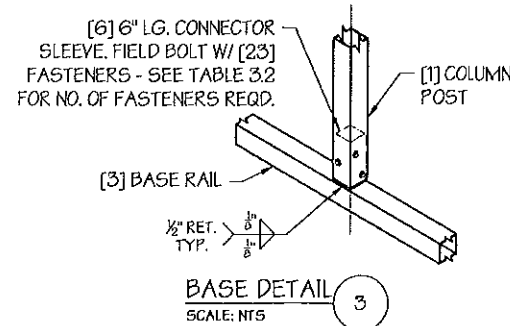

**BASE DETAIL**  
SCALE: NTS

MANUFACTURED BY:



457 N. Broadway,  
Joshua, TX 76058  
1-866-730-9865

ENGINEERED BY:



**A&A ENGINEERING**  
CIVIL - STRUCTURAL

6036 Renaissance Place, Toledo, OH 43623  
Tel. 419-292-1983 • Fax. 419-292-0955  
www.aa-engineers.com

### DRAWING INFORMATION

PROJECT: 18'-0" WIDE BUILDINGS

LOCATION: STATE OF INDIANA

PROJECT NO.: 033-20-0011

SHEET TITLE:

### FRAME SECTIONS & DETAILS

SHEET NO.: 3 / 11

DRAWN BY: A.W. DATE: 2/29/20

CHECKED BY: OAA DATE: 2/29/20

### LEGAL INFORMATION

- ANY DUPLICATION OF THIS DRAWING IN WHOLE OR PART IS STRICTLY FORBIDDEN. ANYONE DOING SO WILL BE PROSECUTED UNDER THE FULL EXTENT OF THE LAW.  
- DRAWINGS VALID UP TO DATE OF EXPIRATION.

SEAL:



STAMP EXPIRY: 07/31/2022

DATE SIGNED: FEB 12 2020



TABLE 4: FRAME SPACING CHART / SCHEDULE

GROUND SNOW / ROOF LIVE LOAD (PSF)	■ ENCLOSED BUILDINGS							■ OPEN BUILDINGS						
	WIND SPEED (MPH)							WIND SPEED (MPH)						
	□105	□115	□130	□140	□155	□165	□180	□105	□115	□130	□140	□155	□165	□180
□ 30 / 20	60	60	54/60	54	42	36	30	60	54/60	48/60	42/54	36/42	36	30
□ 40 / 27	48/60	48/60	42/60	42/54	42	36	30	48/54	48/54	42/54	42/54	36/42	36	30
□ 50 / 34	40/54	40/54	40/54	40/54	40/42	36	30	40/48	40/48	40/48	40/48	36/42	36	30
□ 60 / 41	36/42	36/42	36/42	36/42	36/42	36	30	36	36	36	36	36	36	30
□ 70 / 47	32/36	32/36	30/36	30/36	30/36	30/36	30	30	30	30	30	30	30	30
□ 80 / 54	30	30	30	30	30	30	30	24	24	24	24	24	24	24
□ 90 / 61	24	24	24	24	24	24	24	18	18	18	18	18	18	18
□ 30 / 20	60	60	54/60	54	48	42/48	42	60	54/60	48/60	42/54	36/48	36/48	36/42
□ 40 / 27	48/60	48/60	42/60	42/54	42/48	42/48	42	48/60	48/60	42/60	42/54	36/48	36/48	36/42
□ 50 / 34	40/54	40/54	40/54	40/54	40/48	40/48	40/42	40/48	40/48	40/48	40/48	36/48	36/48	36/42
□ 60 / 41	36/42	36/42	36/42	36/42	36/42	36/42	36/42	36/42	36/42	36/42	36/42	36/42	36/42	36/42
□ 70 / 47	32/36	32/36	32/36	32/36	32/36	32/36	32/36	32/36	32/36	32/36	32/36	32/36	32/36	32/36
□ 80 / 54	30	30	30	30	30	30	30	30	30	30	30	30	30	30
□ 90 / 61	24	24	24	24	24	24	24	24	24	24	24	24	24	24
□ 30 / 20	60	60	54/60	54	48	42/48	42	60	54/60	48/60	42/54	36/48	36/48	36/42
□ 40 / 27	48/60	48/60	42/60	42/54	42/48	42/48	42	48/60	48/60	42/60	42/54	36/48	36/48	36/42
□ 50 / 34	40/54	40/54	40/54	40/54	40/48	40/48	40/42	40/54	40/54	40/54	40/54	36/48	36/48	36/42
□ 60 / 41	36/42	36/42	36/42	36/42	36/42	36/42	36/42	36/42	36/42	36/42	36/42	36/42	36/42	36/42
□ 70 / 47	32/36	32/36	32/36	32/36	32/36	32/36	32/36	32/36	32/36	32/36	32/36	32/36	32/36	32/36
□ 80 / 54	30	30	30	30	30	30	30	30	30	30	30	30	30	30
□ 90 / 61	24	24	24	24	24	24	24	24	24	24	24	24	24	24

## NOTES:

1. FRAME SPACINGS ARE IN UNITS OF INCHES (IN).
2. WHERE TWO VALUES ARE SHOWN, THE HIGHER VALUE CAN ONLY BE USED FOR VERTICAL SHEATHING.
3. SNOW LOADS AND ROOF LIVE LOADS ARE IN POUNDS PER SQUARE FOOT (PSF). WIND SPEED IS 3 SEC. GUST IN MILES PER HOUR (MPH).
4. FOR VALUES THAT LIE BETWEEN TWO CELLS, THE HIGHER (MORE STRINGENT) VALUE HAS TO BE USED. INTERPOLATION BETWEEN CELLS IS NOT ALLOWED.

## ENCLOSURE CLASSIFICATION:

1. ENCLOSED BUILDING = ALL 4 WALLS FULLY ENCLOSED WITH DOORS/WINDOWS = USE ENCLOSED BUILDING SPACING CHART.
2. OPEN BUILDING = ALL 4 WALLS FULLY OPEN = USE OPEN BUILDING SPACING CHART.
3. 3FT PARTIALLY ENCLOSED = BOTH END-WALLS FULLY OPEN, WITH BOTH SIDE-WALLS ONLY 3FT ENCLOSED = USE OPEN BUILDING SPACING CHART.
4. PARTIALLY ENCLOSED = BOTH END-WALLS FULLY OPEN, WITH BOTH SIDE-WALLS ENCLOSED MORE THAN 3FT = START WITH OPEN BUILDING SPACING CHART AND THEN REDUCE SPACING BY 6".
5. 3 SIDED ENCLOSED = ALL WALLS ARE ENCLOSED EXCEPT FOR 1 END-WALL = START WITH ENCLOSED BUILDING SPACING + THE OPEN END FRAME MUST HAVE EITHER A GABLED END OR HAVE DOUBLED WELDED LEGS.
6. FOR ALL SHEATHING ENCLOSURES NOT LISTED ABOVE, REFER TO SHEET 5 FOR SPACING AND DESIGN REQUIREMENTS.

## GENERAL NOTES:

1. THE MAX. BUILDING LENGTH FOR ENCLOSED BUILDINGS IS 50'-0". THIS CAN BE INCREASED BY ADDING A DOUBLE FRAME AT THE CENTER TO BREAK THE LENGTH OF THE BUILDING.
2. BUILDINGS WITH PARTIALLY ENCLOSED END WALLS NEED TO HAVE SIDE WALL BRACING TO SUPPORT THE PARTIALLY ENCLOSED END WALL. (SEE FIGURE A ON SHEET 5).

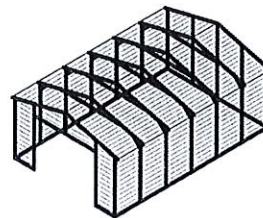
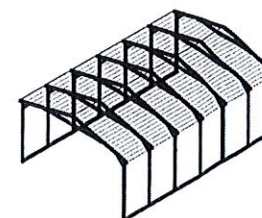
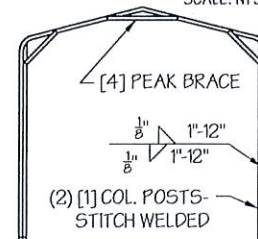
TYP. ENCLOSED BUILDING  
SCALE: NTSTYP. OPEN BUILDING  
SCALE: NTSTYP. OPEN END WALL ON 3  
SIDE ENCLOSED BUILDING  
SCALE: NTS

MANUFACTURED BY:



457 N. Broadway,  
Joshua, TX 76058  
1-866-730-9865

ENGINEERED BY:



**A&A ENGINEERING**  
CIVIL • STRUCTURAL

6036 Renaissance Place, Toledo, OH 43623  
Tel. 419-292-1983 • Fax. 419-292-0955  
www.a-a-engineers.com

## DRAWING INFORMATION

PROJECT: 18'-0" WIDE BUILDINGS

LOCATION: STATE OF INDIANA

PROJECT NO.: 033-20-0011

SHEET TITLE:

SPACING SCHEDULES  
& ENCLOSURE NOTES

SHEET NO.: 4 / 11

DRAWN BY: A.W. DATE: 7/24/20

CHECKED BY: OAA DATE: 7/24/20

## LEGAL INFORMATION

- ANY DUPLICATION OF THIS DRAWING IN WHOLE OR PART IS STRICTLY FORBIDDEN. ANYONE DOING SO WILL BE PROSECUTED UNDER THE FULL EXTENT OF THE LAW.  
- DRAWINGS VALID UP TO DATE OF EXPIRATION.

SEAL:



STAMP EXPIRY: 07/31/2022

DATE SIGNED: FEB 12 2020



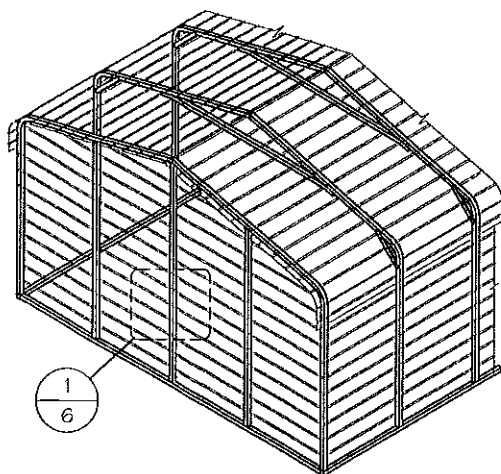

□ TYP. HORIZONTAL SHEATHING  
SCALE: NTS

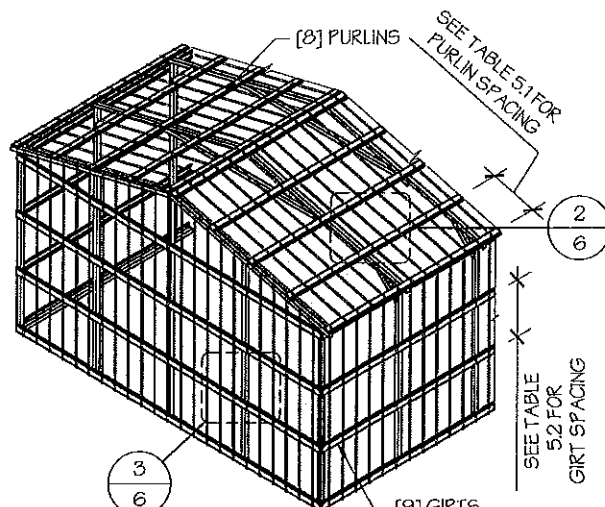

□ TYP. VERTICAL SHEATHING  
SCALE: NTS

#### GENERAL SHEATHING NOTES:

1. REGULAR STYLE BUILDINGS CAN ONLY HAVE HORIZONTAL SHEATHING ON ROOF AND WALLS.
2. A-FRAME STYLE BUILDINGS CAN HAVE ANY COMBINATION OF HORIZONTAL OR VERTICAL SHEATHING ON ROOFS AND WALLS.
3. BOTH HORIZONTAL AND VERTICALS ROOF SHEATHING CAN HAVE MAX. 6" OVERHANG.
4. USING VERTICAL SHEATHING MAY ALLOW FOR GREATER FRAME SPACING. SEE NOTE 2 UNDER TABLE 4.
5. VERTICAL SHEATHING RECOMMENDED FOR BUILDINGS 30' OR LONGER

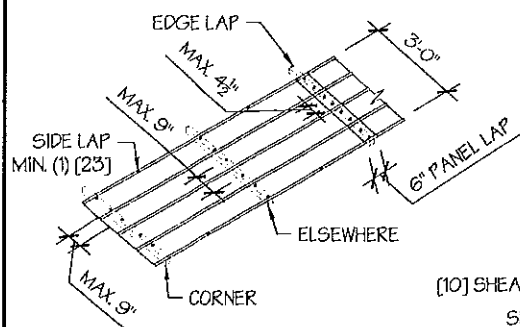

TYP. SHEATHING FASTENER SCHEDULE  
SCALE: NTS

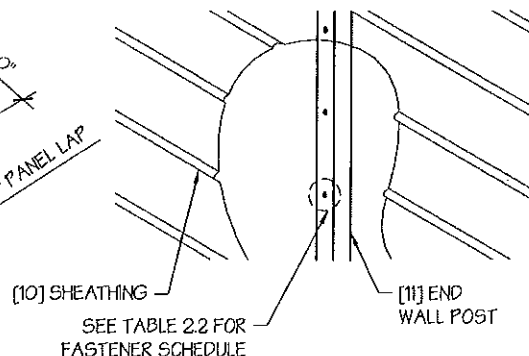

TYP. HORIZONTAL SHEATHING DETAIL  
SCALE: NTS

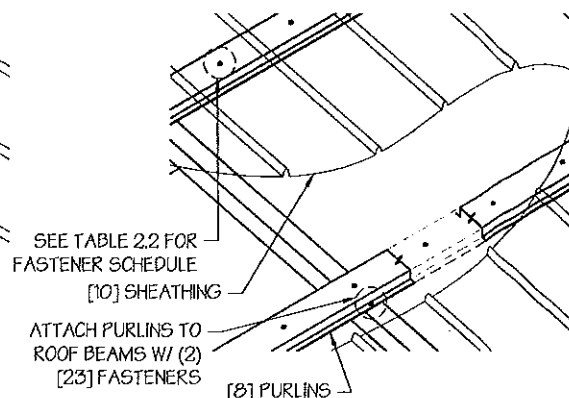

ROOF VERTICAL SHEATHING DETAIL  
SCALE: NTS

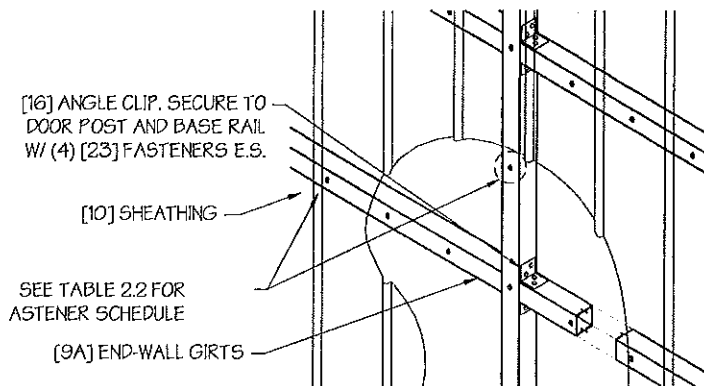

□ WALL VERTICAL SHEATHING - TUBE DETAIL  
SCALE: NTS

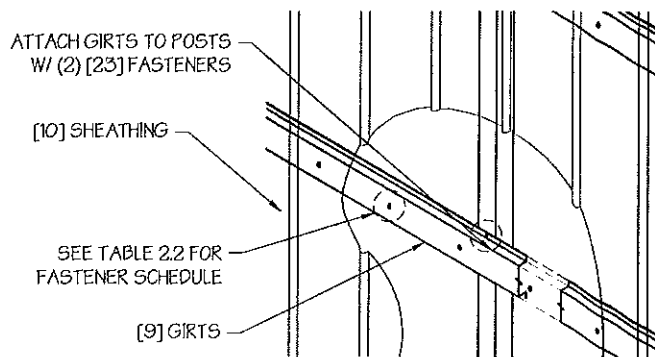

□ WALL VERTICAL SHEATHING - HAT CHANNEL DETAIL  
SCALE: NTS

MANUFACTURED BY:



457 N. Broadway,  
Joshua, TX 76058  
1-866-730-9865

ENGINEERED BY:



**A&A ENGINEERING**  
CIVIL • STRUCTURAL

6036 Renaissance Place, Toledo, OH 43623  
Tel. 419-292-1983 • Fax. 419-292-0855  
www.aa-engineers.com

#### DRAWING INFORMATION

PROJECT: 18'-0" WIDE BUILDINGS

LOCATION: STATE OF INDIANA

PROJECT NO.: 033-20-0011

SHEET TITLE:

#### SHEATHING OPTIONS & DETAILS

SHEET NO.: 6 / 11

DRAWN BY: A.W. DATE: 2/29/20

CHECKED BY: OAA DATE: 2/29/20

#### LEGAL INFORMATION

- ANY DUPLICATION OF THIS DRAWING IN WHOLE OR PART IS STRICTLY FORBIDDEN. ANYONE DOING SO WILL BE PROSECUTED UNDER THE FULL EXTENT OF THE LAW.  
- DRAWINGS VALID UP TO DATE OF EXPIRATION.

SEAL:

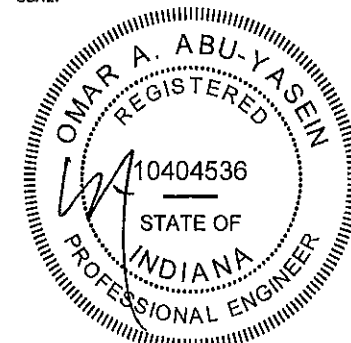

STAMP EXPIRY: 07/31/2022

DATE SIGNED: FEB 12 2020

DATE SIGNED: **FEB 12 2020**

1. DESIGNS AND DETAILS SHOWN HERE ARE APPLICABLE TO BOTH REGULAR AND A-FRAME STYLE BUILDINGS.
2. MIN. 12" CLEARANCE MUST BE MAINTAINED BETWEEN ANY TWO OPENINGS (OVERHEAD DOOR OR SERVICE DOOR) AND FROM CORNERS.
3. SERVICE DOORS AND WINDOWS CAN BE PLACED AS NEEDED.
4. DIAGONAL BRACES NEED TO BE ADDED FOR PARTIAL END WALL ENCLOSURES. SEE SHEET 9 FOR DIAGONAL BRACE CONNECTION DETAILS.

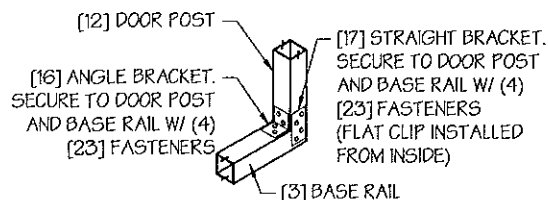

**DOOR POST BASE RAIL CONN. DETAIL**

SCALE: NTS

1

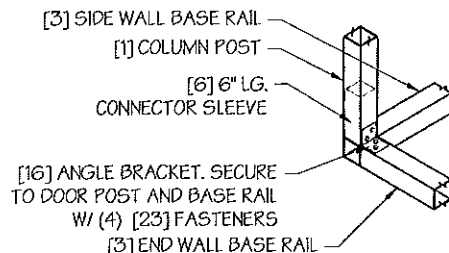

**CORNER DETAIL**

SCALE: NTS

2

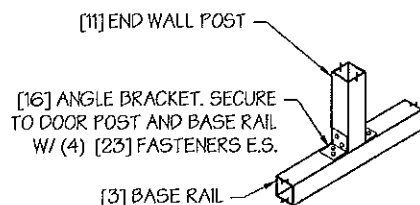

**END WALL POST - BASE RAIL CONN. DETAIL**

SCALE: NTS

3

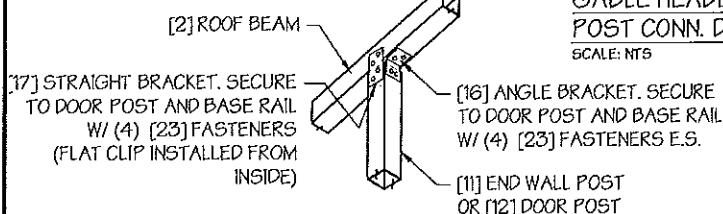

**END WALL POST - ROOF BEAM CONN. DETAIL**

SCALE: NTS

4

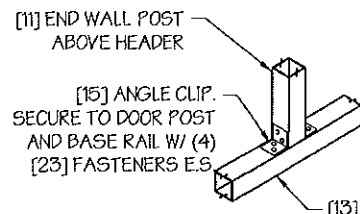

**END WALL POST ABOVE HEADER CONN. DETAIL**

SCALE: NTS

5

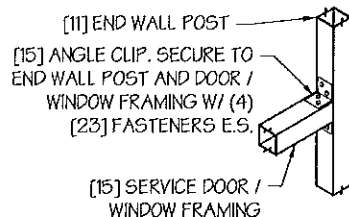

**TYP. SERVICE DOOR / WINDOW FRAMING CONN. DETAIL**

SCALE: NTS

6

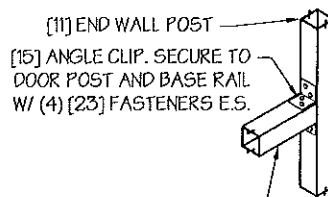

**HEADER - END WALL POST CONN. DETAIL**

SCALE: NTS

7

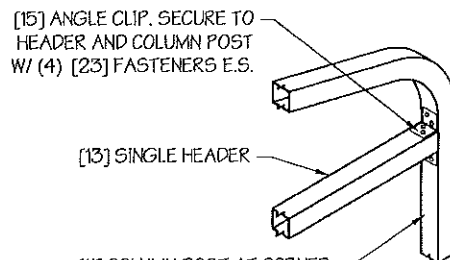

**GABLE HEADER - CORNER POST CONN. DETAIL**

SCALE: NTS

8

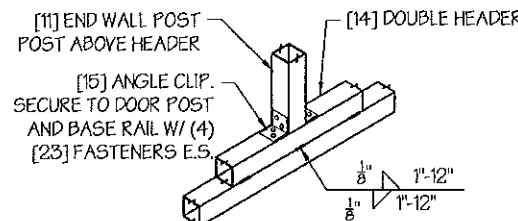

**END WALL POST ABOVE DOUBLE HEADER CONN. DETAIL**

SCALE: NTS

9

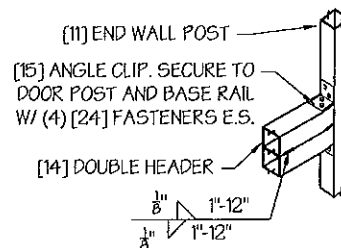

**DOUBLE HEADER - END WALL POST CONN. DETAIL**

SCALE: NTS

10

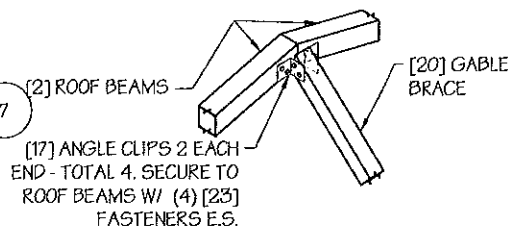

**TYP. GABLE BRACE CONN. DETAIL**

SCALE: NTS

11

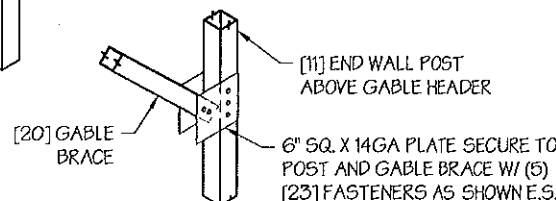

**GABLE BRACE - END WALL CONN. DETAIL**

SCALE: NTS

12

MANUFACTURED BY:



457 N. Broadway,  
Joshua, TX 76058  
1-866-730-9865

ENGINEERED BY:



**A&A ENGINEERING**  
CIVIL & STRUCTURAL

6036 Renaissance Place, Toledo, OH 43628  
Tel. 419-292-1983 • Fax. 419-292-0955  
www.a-a-engineers.com

**DRAWING INFORMATION**

PROJECT: 18'-0" WIDE BUILDINGS

LOCATION: STATE OF INDIANA

PROJECT NO.: 033-20-0011

SHEET TITLE:

**END WALL FRAMING  
DETAILS**

SHEET NO.: 8-B / 11

DRAWN BY: A.W. DATE: 2/29/20

CHECKED BY: OAA DATE: 2/29/20

**LEGAL INFORMATION**

- ANY DUPLICATION OF THIS DRAWING IN WHOLE OR PART IS STRICTLY FORBIDDEN. ANYONE DOING SO WILL BE PROSECUTED UNDER THE FULL EXTENT OF THE LAW.  
- DRAWINGS VALID UP TO DATE OF EXPIRATION.

SEAL:

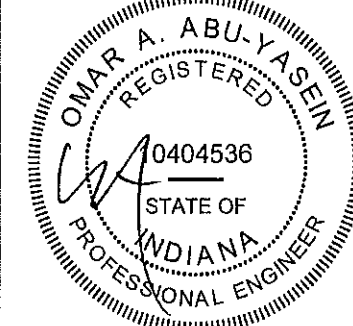

STAMP EXPIRY: 07/31/2022

DATE SIGNED: FEB 12 2020



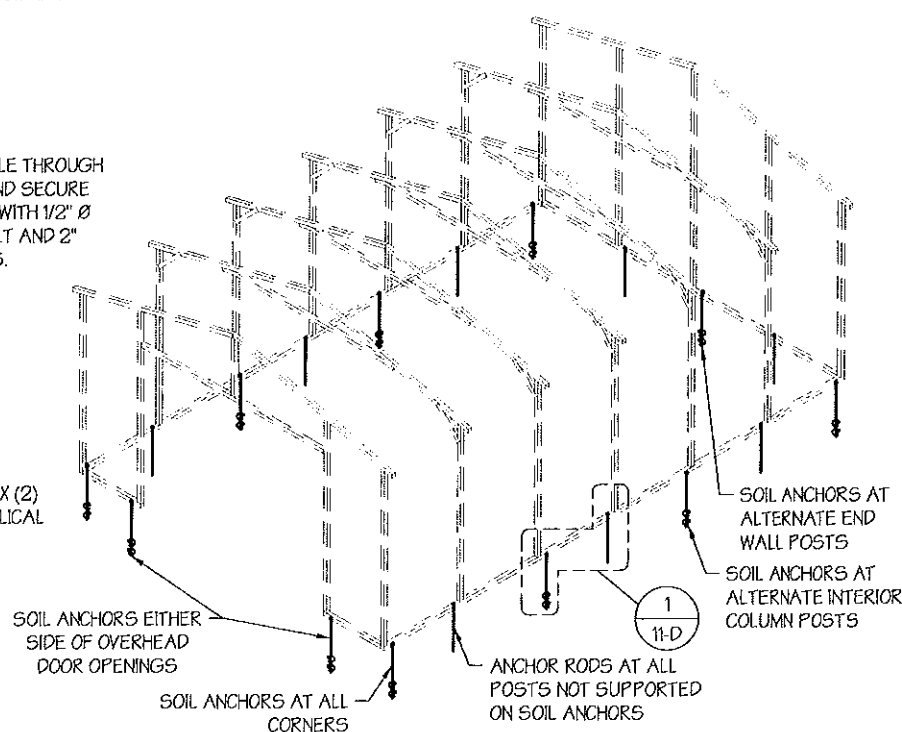
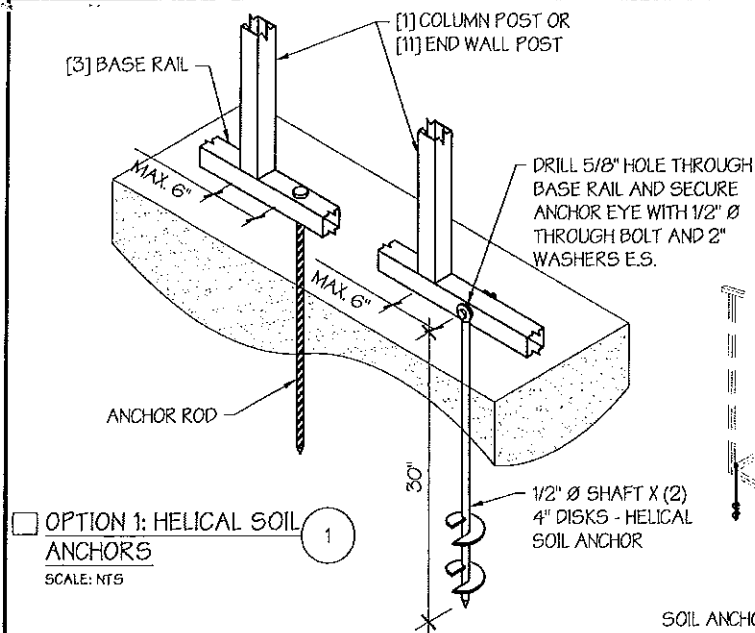

#### SOIL FOUNDATION NOTES:

- DESIGNS SHOWN ON THIS SHEET ARE FOR SOIL ANCHOR FOUNDATION.
- SOIL ANCHORS (HELICAL OR ROCK/ASPALT) SHALL BE LOCATED AT ALL 4 CORNERS, ON EACH SIDE OF OVERHEAD DOOR OPENINGS, ON POSTS WITH DIAGONAL BRACING IF REQUIRED, AND ON ALTERNATE INTERIOR COLUMN POSTS AND END WALLS POSTS.
- HELICAL ANCHORS ARE TO BE USED ONLY IF THE DRIVING TORQUE INTO THE GROUND IS 150 FT-LBS OR GREATER. MANUFACTURER IS NOT RESPONSIBLE FOR SOIL QUALITY AT SITE.
- HELICAL ANCHORS CAN ONLY BE USED FOR CLASS 2, 3 & 4 SOILS (SEE SOIL CLASSIFICATIONS THIS PAGE).
- ALL POSTS WITH NO ANCHORS ADJACENT SHALL BE ANCHORED TO THE GROUND WITH A 1/2" X 30" LG. ROD. RODS WILL HAVE A PRE-FORMED HEAD AT THE TOP AND ONE COAT OF RUST PROOF MATERIAL.
- ASSUMED SOIL BEARING CAPACITY IS TO BE A MIN. OF 1500 PSF.

#### SOIL CLASSIFICATIONS:

SOIL CLASS	DESCRIPTION
2	SANDY GRAVEL AND GRAVEL, VERY THIN DENSE AND/OR CEMENTED SANDS, COARSE GRAVEL/COBBLES, PRELOADED SILTS, CLAYS AND CORAL.
3	SAND, SILTY SAND, CLAYEY SAND, SILTY GRAVEL, MEDIUM DENSE COARSE SANDS, SANDY GRAVEL, VERY STIFF SILT AND SANDY CLAYS.
4	LOOSE TO MEDIUM DENSE SANDS, FIRM TO STIFF CLAYS AND SILTS AND ALLUVIAL FILLS.

\*FROM HUD "MODEL MANUFACTURED HOME INSTALLATION STANDARDS"

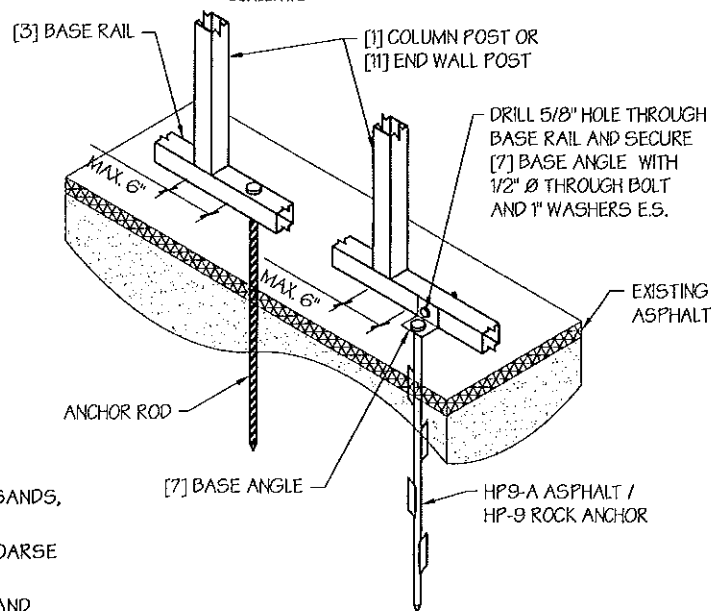

MANUFACTURED BY:



457 N. Broadway,  
Joshua, TX 76058  
1-866-730-9865

ENGINEERED BY:



**A&A ENGINEERING**  
CIVIL • STRUCTURAL  
6036 Renaissance Place, Toledo, OH 43623  
Tel. 419-292-1983 • Fax. 419-292-0955  
www.a-a-engineers.com

#### DRAWING INFORMATION

PROJECT: 18'-0" WIDE BUILDINGS

LOCATION: STATE OF INDIANA

PROJECT NO.: 033-20-0011

SHEET TITLE:

**FOUNDATION OPTION 4:  
SOIL ANCHORS**

SHEET NO.: 11-D / 11

DRAWN BY: A.W. DATE: 2/29/20

CHECKED BY: OAA DATE: 2/29/20

#### LEGAL INFORMATION

- ANY DUPLICATION OF THIS DRAWING IN WHOLE OR PART IS STRICTLY FORBIDDEN. ANYONE DOING SO WILL BE PROSECUTED UNDER THE FULL EXTENT OF THE LAW.  
- DRAWINGS VALID UP TO DATE OF EXPIRATION.

SEAL:



STAMP EXPIRY: 07/31/2022

DATE SIGNED: FEB 12 2020





my intent to build carport is  
for parking vehicle in it,

and it is going to be  
A 18x21 Regular Frame 7002  
Three sides will be covered  
and entire color of it cream  
color.

Chris Williams