

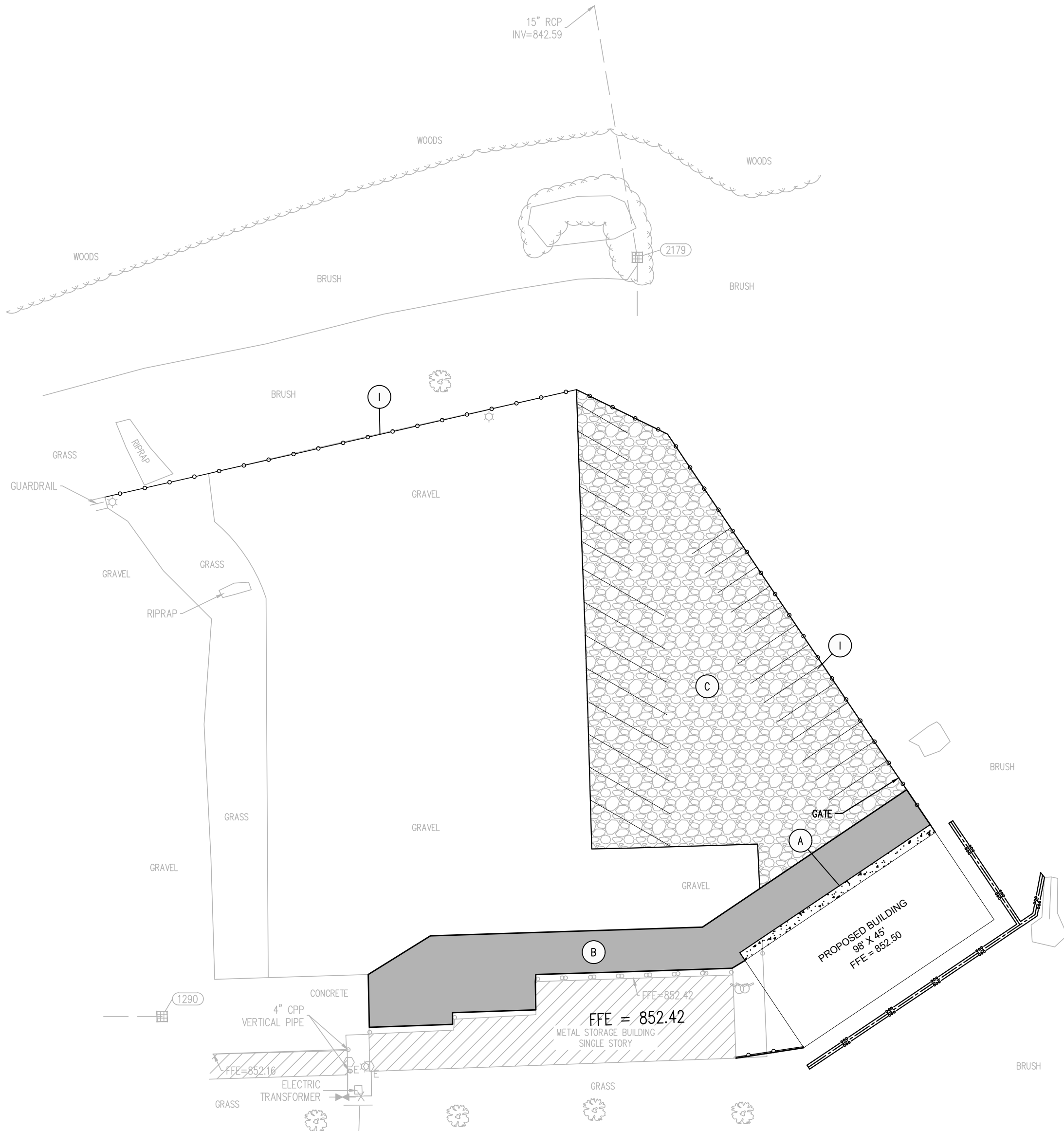

Know what's below.  
Call before you dig.

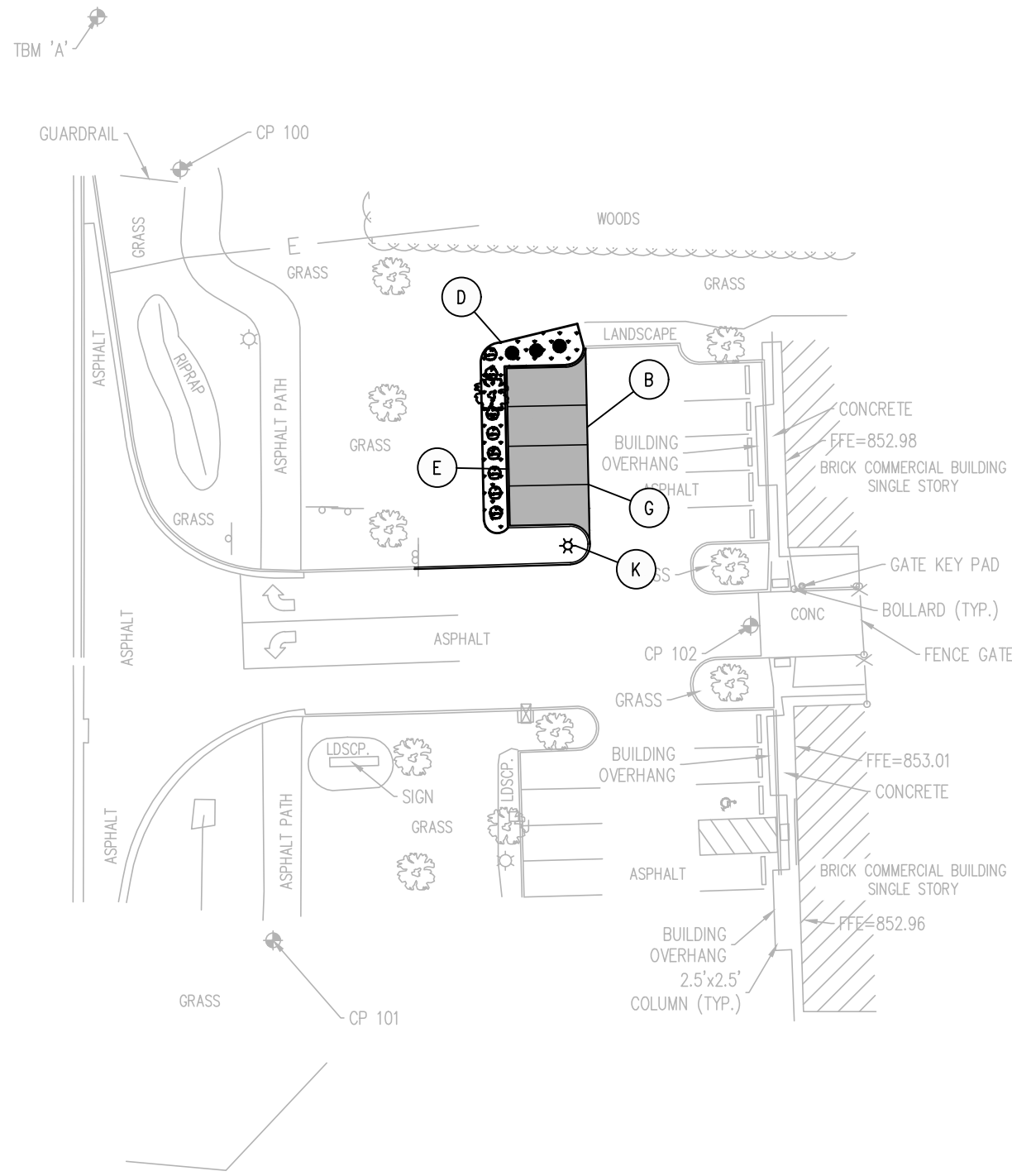
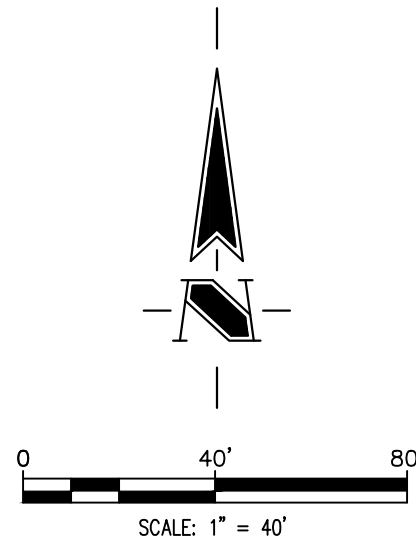

### LEGEND

- CONSTRUCTION PROJECT LIMITS
- (A) PROPOSED CONCRETE APRON
  - (B) PROPOSED STANDARD DUTY ASPHALT PAVEMENT
  - (C) PROPOSED GRAVEL PAVEMENT  
(CONTRACTOR RESPONSIBLE FOR REMOVING EXISTING LAWN/LANDSCAPE AND GRAVEL WITHIN PROJECT LIMITS. REFER TO SHEET C102 FOR GRADING.)
  - (D) PROPOSED LANDSCAPE AREA  
(REFER TO SHEET C102 FOR GRADING AND L101 FOR LANDSCAPING.)
  - (E) PROPOSED 6" CONCRETE CURB
  - (G) PROPOSED 4" WHITE PREFORMED THERMOPLASTIC PARKING MARKER, TYPICAL
  - (I) PROPOSED FENCING WITH GATE(S), BY OTHERS
  - (J) PROPOSED DRAINAGE SWALE
  - (K) RELOCATED LIGHT POLE

- SAN - EXISTING SANITARY SEWER & MANHOLE
- STM - EXISTING STORM SEWER; INLET & M.H.
- G - EXISTING GAS LINE
- WTR - EXISTING WATER LINE
- E - EXISTING UNDERGROUND ELECTRIC LINE
- UCT - EXISTING UNDERGROUND TELEPHONE LINE
- FBOP - EXISTING FIBER OPTIC LINE
- EXISTING FIRE HYDRANT
- EXISTING VALVE; GAS & WATER
- EXISTING TELEPHONE MANHOLE & PEDESTAL
- EXISTING WATER METER
- EXISTING BOLLARDS
- EXISTING AREA LIGHT
- EXISTING AREA LIGHT
- EXISTING WOOD FENCE
- EXISTING CHAIN LINK FENCE
- EXISTING SETBACK LINE
- EXISTING PROPERTY LINE
- EXISTING ADJOINING PROPERTY LINE
- EXISTING RIGHT OF WAY LINE
- EXISTING TREE LINE

### SITE AND UTILITY NOTES

- IT SHALL BE THE RESPONSIBILITY OF EACH SUBCONTRACTOR TO VERIFY ALL EXISTING UTILITIES AND CONDITIONS PERTAINING TO THEIR PHASE OF WORK. IT SHALL ALSO BE THE SUBCONTRACTOR'S RESPONSIBILITY TO CONTACT THE OWNERS OF THE VARIOUS UTILITIES FOR PROPER STAKE LOCATION OF EACH UTILITY BEFORE WORK IS STARTED. THE SUBCONTRACTOR SHALL NOTIFY IN WRITING THE OWNER AND THE ENGINEER OF ANY CHANGES, OMISSIONS, OR ERRORS FOUND ON THESE PLANS OR IN THE FIELD BEFORE WORK IS STARTED OR RESUMED.
- STANDARD SPECIFICATIONS FOR THE LOCAL GOVERNING AGENCY SHALL APPLY FOR ALL SANITARY SEWERS, STORM SEWERS, AND WATER MAINS.
- ALL PARKING STRIPES ARE TO BE 4" PAINTED (WHITE). HANDICAPPED ACCESS AISLES SHALL BE 4" PAINTED (BLUE).
- ALL DIMENSIONS ARE TO EDGE OF PAVEMENT OR FACE OF CURB, UNLESS NOTED OTHERWISE.
- THE EDGE OF EXISTING ASPHALT PAVEMENT SHALL BE PROPERLY SEALED WITH A TACK COAT MATERIAL IN ALL AREAS WHERE NEW ASPHALT PAVEMENT IS INDICATED TO JOIN EXISTING ASPHALT.
- ANY PART OF THE SANITARY OR STORM SEWER TRENCHES RUNNING UNDER OR WITHIN 5' OF PAVED AREAS TO BE BACKFILLED WITH GRANULAR MATERIAL.
- ALL WATER MAINS TO HAVE A 54" MINIMUM COVER OVER TOP OF PIPE.
- WATER SERVICE LINE TO THE BUILDING SHALL HAVE A SHUT-OFF VALVE IN AN ACCESSIBLE LOCATION OUTSIDE OF THE BUILDING.
- STERILIZATION OF WATER MAIN SHALL BE IN ACCORDANCE WITH STATE BOARD OF HEALTH REQUIREMENTS.
- EXPANSION JOINTS ARE TO BE PLACED AT ALL WALK INTERSECTIONS AND BETWEEN WALKS AND PLATFORMS. SIDEWALK SCORES ARE TO BE EQUALLY PLACED BETWEEN EXPANSION JOINTS, CONTRACTION JOINTS, AND PERPENDICULAR SIDEWALKS AT 5' INTERVALS OR LESS WITH A CONTRACTION JOINT EVERY 20' OR LESS.
- REFER TO ARCHITECTURAL PLANS FOR BUILDING DIMENSIONS.
- ALL 6" PVC SANITARY SEWER LATERALS SHALL BE INSTALLED AT A MINIMUM SLOPE OF 1.04% AND HAVE A 48" MINIMUM COVER OVER TOP OF PIPE.
- ALL LATERALS ARE REQUIRED TO HAVE TRACER WIRE INSTALLED ON THE TOP OF THE PIPE FROM THE SEWER MAIN TO THE CLEANOUT.
- CONTRACTOR TO REFER TO SITE LIGHTING PLAN FOR LOCATION OF LIGHT POLES. CONTRACTOR TO PROVIDE SUFFICIENT CONDUIT WHERE ELECTRIC LINES CROSS PAVEMENT.
- ALL UNDERGROUND UTILITY SERVICE LINES AND CONNECTIONS TO ADHERE TO THEIR RESPECTIVE COMPANY MINIMUM COVER REQUIREMENTS.

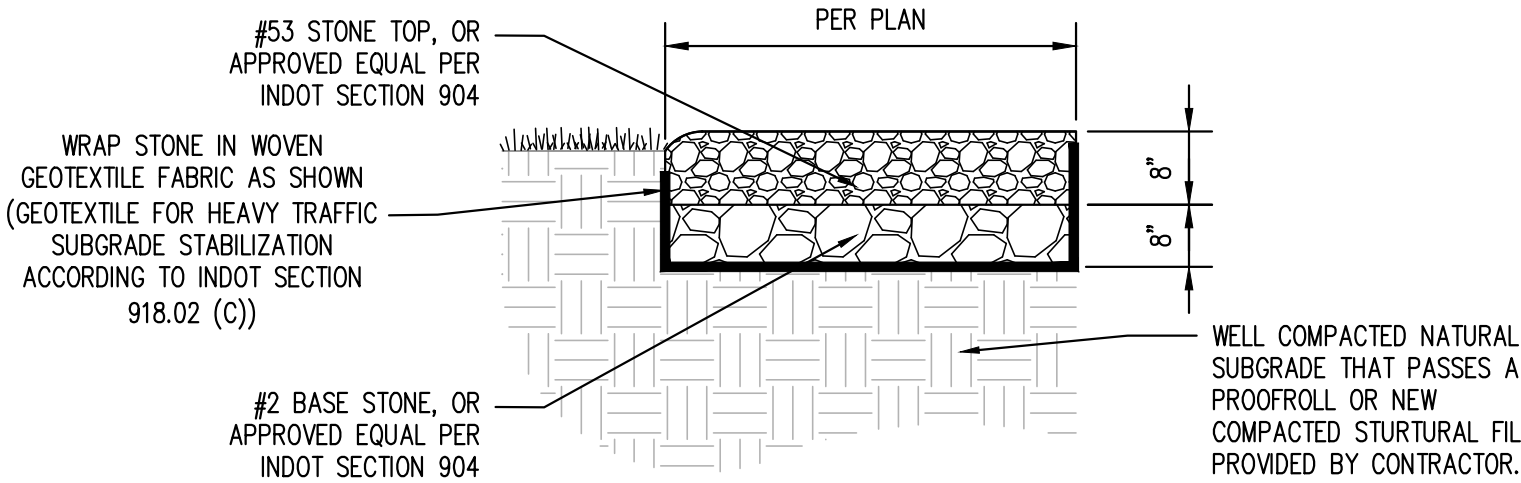
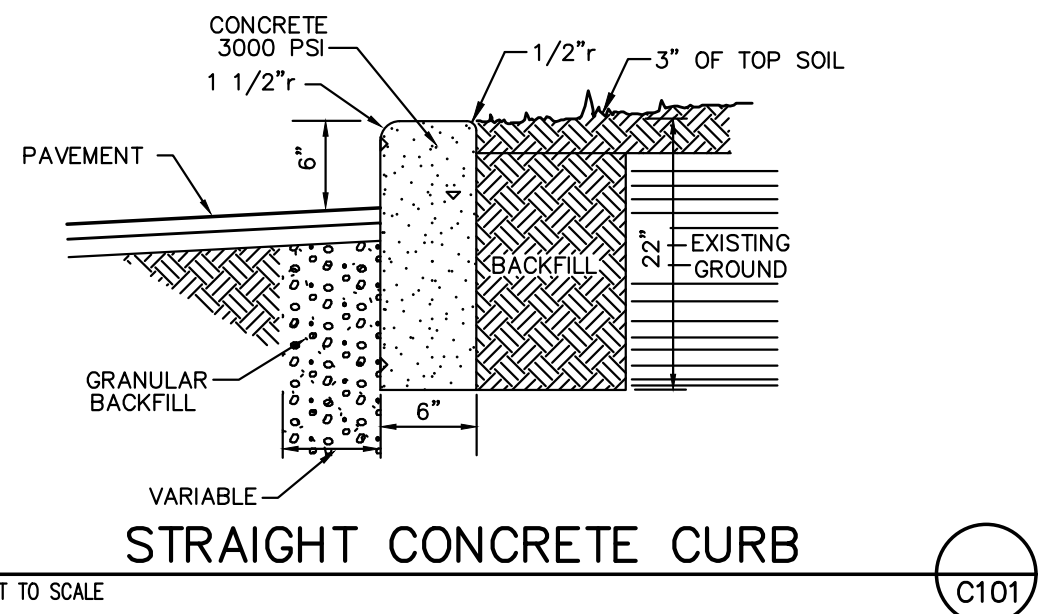

NOTES:  
1. ALL MATERIALS AND INSTALLATION PER APPLICABLE INDOT STANDARD SPECIFICATIONS, LATEST EDITION.

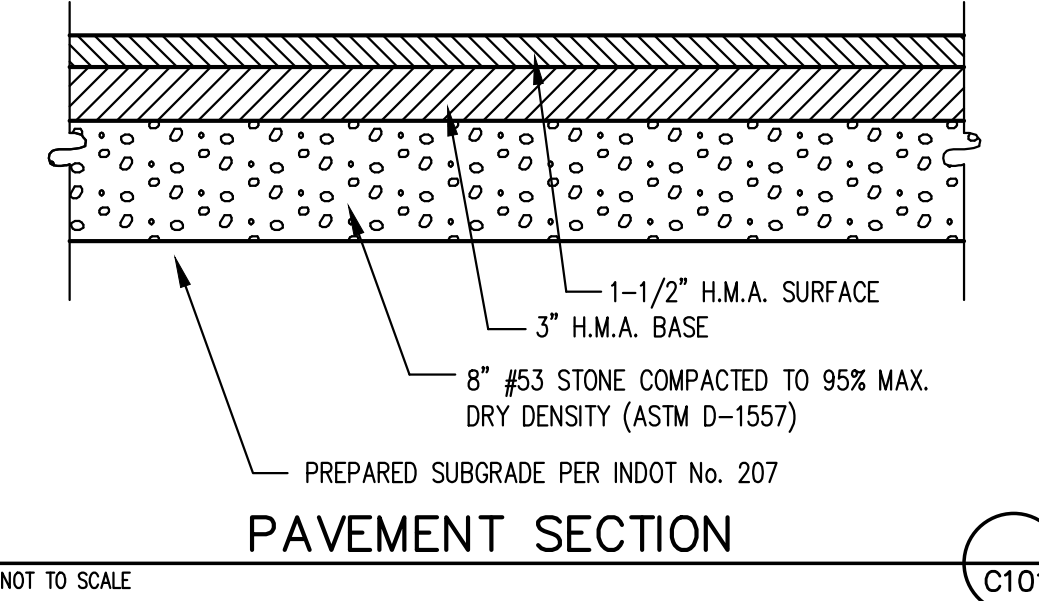

### PLANT MATERIAL SCHEDULE

Symbol	Plant Type	Size
	Shade Tree	2-1/2 Cal.
	Ornamental Tree	1-1/2 Cal.
	Evergreen Tree	5'
	Shrub	24"
	Existing Tree line	

REVISIONS:

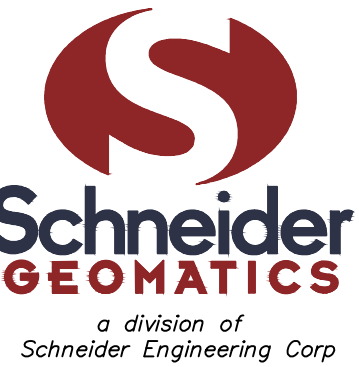
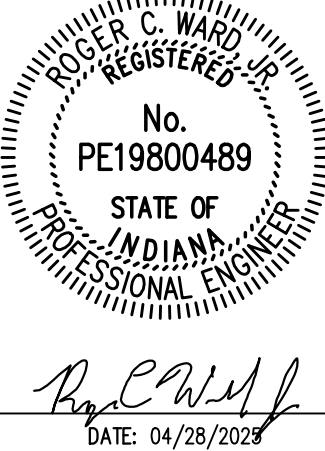

Historic Fort Harrison  
8901 Otis Avenue  
Indianapolis, IN 46216-1037  
Telephone: 317.826.7100  
www.schneidergeomatics.com

AMERISTOR MCCORDSVILLE

SITE IMPROVEMENTS

8798 North CR 800 West, McCordsville IN

ASPEN SELF STORAGE, LLC  
910 N Shadeland Ave. Suite 6 Indianapolis IN 46219

DATE: 05/01/2025	PROJECT NO.: 2520083
DRAWN BY: GRM	CHECKED BY:
SHEET TITLE:	
DRAWING FILE: T:\25K\2520083\CAD\2520083_C101.dwg	
XREF(S):	
SHEET NO.: C101	