



This European shaped pendant or wall mount luminaire consists of a driver housing and skirt with an internal light engine with a choice of two lens options.

- Choice of a flat or sag glass lens
- Stainless steel hardware
- Driver and Light engine assembly mount on a removable assembly plate and are furnished with quick-disconnect plugs for ease of installation and maintenance
- CSA listed and labeled as suitable for wet locations
- TGIC powder coat finish
- Mounts via swivel nipple to the Urban 4" or 5" diameter arms (specify PNIP3 option when ordering 5" arm); see arm specification sheets for details on mounting options.



Max EPA: 0.86 sq feet
Max Height: 19-1/2" (49.5cm)
Max Width: 17" (43.2cm)
Max Weight: 45 lbs (20.4 kg)
Listing: CSA listed for wet locations

Sample Catalog number:

EML17	ST	49LED 350MA	3K	GCF	MVOLT	R3	SF	DBL
Fixture	Base	Source & Wattage	Color Temp	Lens Option	Voltage	Distrib.	Options	Finish

Ordering Guide:

Fixture	Base	Source & Wattage	Color Temp	Lens Option	Voltage	Distribution	Options	Finish
EML17	ST RT FT	49LED 350MA 49LED 525MA 63LED 350MA 63LED 525MA	3K 4K 5K	GCF GCSG	MVOLT 120 208 240 277 347 480	R2 R3 R4 R5	SF DF SPD	DBL DDB DNA DWH CS CM ANBK ANDB ANDG ANVG

Data is considered accurate as of the revision date shown.
 Antique Street Lamps reserves the right to modify specifications without notice.

BASE

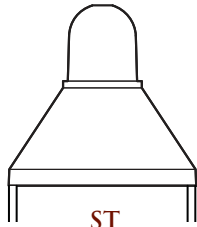

ST
Smooth

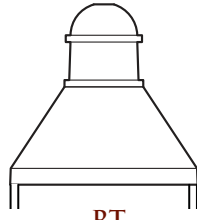

RT
Ringed

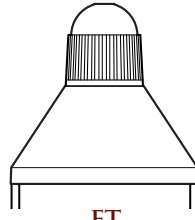

FT
Fluted

SELECT YOUR OPTIONS FROM

- ☐ **ST** Smooth Ballast Housing
- ☐ **RT** Ringed Ballast Housing
- ☐ **FT** Fluted Ballast Housing

Notes:

Must select ST, RT, or FT style; optional IDS feature can be specified in addition to any selection (ex: EHL16 GCF ST IDS)

SOURCE AND WATTAGE

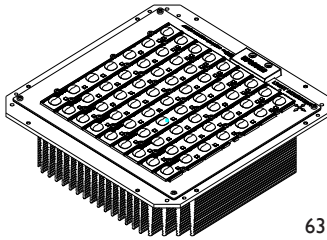

63LED light engine module

SELECT YOUR CHOICE FROM

- ☐ **49LED 350MA** 49 chips, 350 mA
- ☐ **49LED 525MA** 49 chips, 525 mA
- ☐ **63LED 350MA** 63 chips, 350 mA
- ☐ **63LED 525MA** 63 chips, 525 mA

Performance Package	Lens Type	Dist.	Input Watts	3000K CCT (opt)			4000K CCT (opt)			5000K CCT (opt)			L70 Life (hrs) @ 25°C
				Delivered Lumens	Efficacy (LPW)	CRI	Delivered Lumens	Efficacy (LPW)	CRI	Delivered Lumens	Efficacy (LPW)	CRI	
63LED 350mA	GCSG	R3	72.7	6421	88.32	66	6421	88.32	66	6421	88.32	66	70000
		R4	72.5	6272	86.51	66	6272	86.51	66	6272	86.51	66	70000
		R5	72.4	6657	91.95	66	6657	91.95	66	6657	91.95	66	70000

Data is considered accurate as of the revision date, shown in the highest operating temperature available.

Antique Street Lamps reserves the right to modify specifications without notice.

COLOR TEMP

SELECT YOUR OPTIONS FROM

- ☐ **3K** 3000K
- ☐ **4K** 4000K
- ☐ **5K** 5000K

LENS OPTION

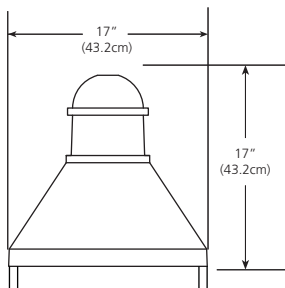

GCF
Glass, Clear Flat

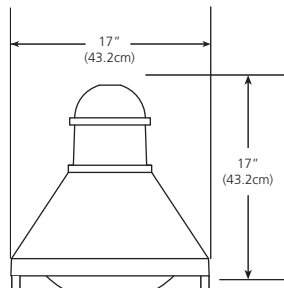

GCSG
Glass, Clear Sag

SELECT YOUR OPTIONS FROM

- ☐ **GCF** Glass, Clear Flat (Standard)
- ☐ **GCSG** Glass, Clear Sag



Consistent with LEED® goals & Green Globes™ criteria for light pollution reduction

Notes:

Nighttime Friendly™ distributions available with GCF lens only.

EML17 LED

VOLTAGE

SELECT YOUR OPTIONS FROM

- | | |
|---------------------------------------|-------|
| <input type="checkbox"/> MVOLT | MVOLT |
| <input type="checkbox"/> 120 | 120V |
| <input type="checkbox"/> 208 | 208V |
| <input type="checkbox"/> 240 | 240V |
| <input type="checkbox"/> 277 | 277V |
| <input type="checkbox"/> 347 | 347V |
| <input type="checkbox"/> 480 | 480V |

DISTRIBUTION

House Side
Street Side

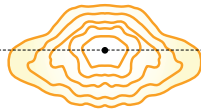

R2 Type II

Distributes light slightly ahead of luminaire location with significant lateral spread.

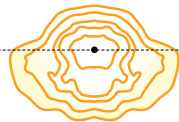

R3 Type III

Provides light farther ahead of the luminaire than a Type II pattern but maintains a significant lateral spread.



R4 Type IV

Sharp Cutoff
Distributes light almost exclusively forward with an emphasis on eliminating light trespass and spill light behind the pole.

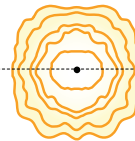

R5 Type V

Provides improved uniformity with a variance of the Type V distribution with a slightly square pattern compared to the regular Type V.

SELECT YOUR OPTIONS FROM

- | | |
|------------------------------------|----------|
| <input type="checkbox"/> R2 | Type II |
| <input type="checkbox"/> R3 | Type III |
| <input type="checkbox"/> R4 | Type IV |
| <input type="checkbox"/> R5 | Type V |

OPTIONS

SELECT YOUR OPTIONS FROM

(Fuse Not Included)

- | | |
|-------------------------------------|-------------------------|
| <input type="checkbox"/> SF | Single Fuse |
| <input type="checkbox"/> DF | Double Fuse |
| <input type="checkbox"/> SPD | Surge Protection Device |

FINISH

The luminaire has a powder coat finish utilizing a premium TGIC polyester powder. The finish is a three-stage process which consists of drying, powder application and curing. Before coating, the parts are treated with a five-stage pretreatment process, consisting of a heated alkaline cleaner, rinse, phosphate coating, rinse and sealant.

For a complete listing of colors, visit:
www.acuitybrandslighting.com/architecturalcolors

Notes:

- Consult factory for CM option.

Data is considered accurate as of the revision date shown.
Antique Street Lamps reserves the right to modify specifications without notice.

SELECT YOUR OPTIONS FROM

- | | | |
|--------------------------------------|----------------------------|--|
| <input type="checkbox"/> DBL | Black | |
| <input type="checkbox"/> DDB | Dark Bronze | |
| <input type="checkbox"/> DNA | Natural Aluminum | |
| <input type="checkbox"/> DWH | White | |
| <input type="checkbox"/> CS | Custom Select (RAL colors) | |
| <input type="checkbox"/> CM | Custom Match | |
| <input type="checkbox"/> ANBK | ASL Black | |
| <input type="checkbox"/> ANDB | ASL Dark Bronze | |
| <input type="checkbox"/> ANDG | ASL Dark Green | |
| <input type="checkbox"/> ANVG | ASL Verde Green | |

Refer to website

EML17 LED

PENDANT WALL
BRACKET SERIES

PHILADELPHIA
SERIES
CAST ALUMINUM POST

URBAN ALUMINUM
POLE SERIES

URBAN STEEL
POLE SERIES

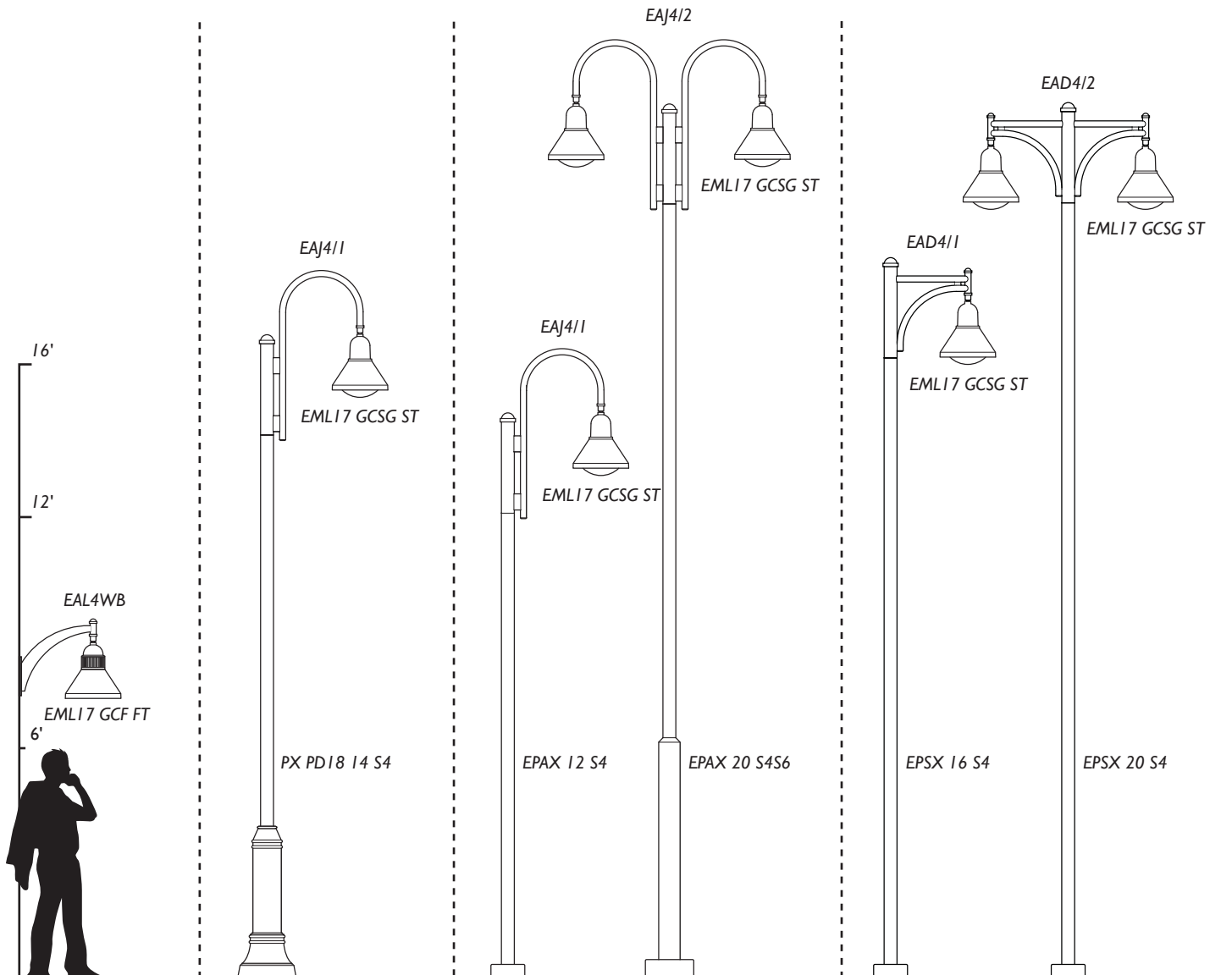

For detailed product specifications for Poles and Arm/Wall Mount see the Antique Street Lamps website.