

File Name: W:\CalAtlantic Homes\2019-263-E Lennar- McCord Pointe Sec 5\Design\CAD\19263E Cover Sheet.dwg, Layout: C1.0 Plot Date: Oct 28, 2019 Plot Time: 2:04pm By: tsmith

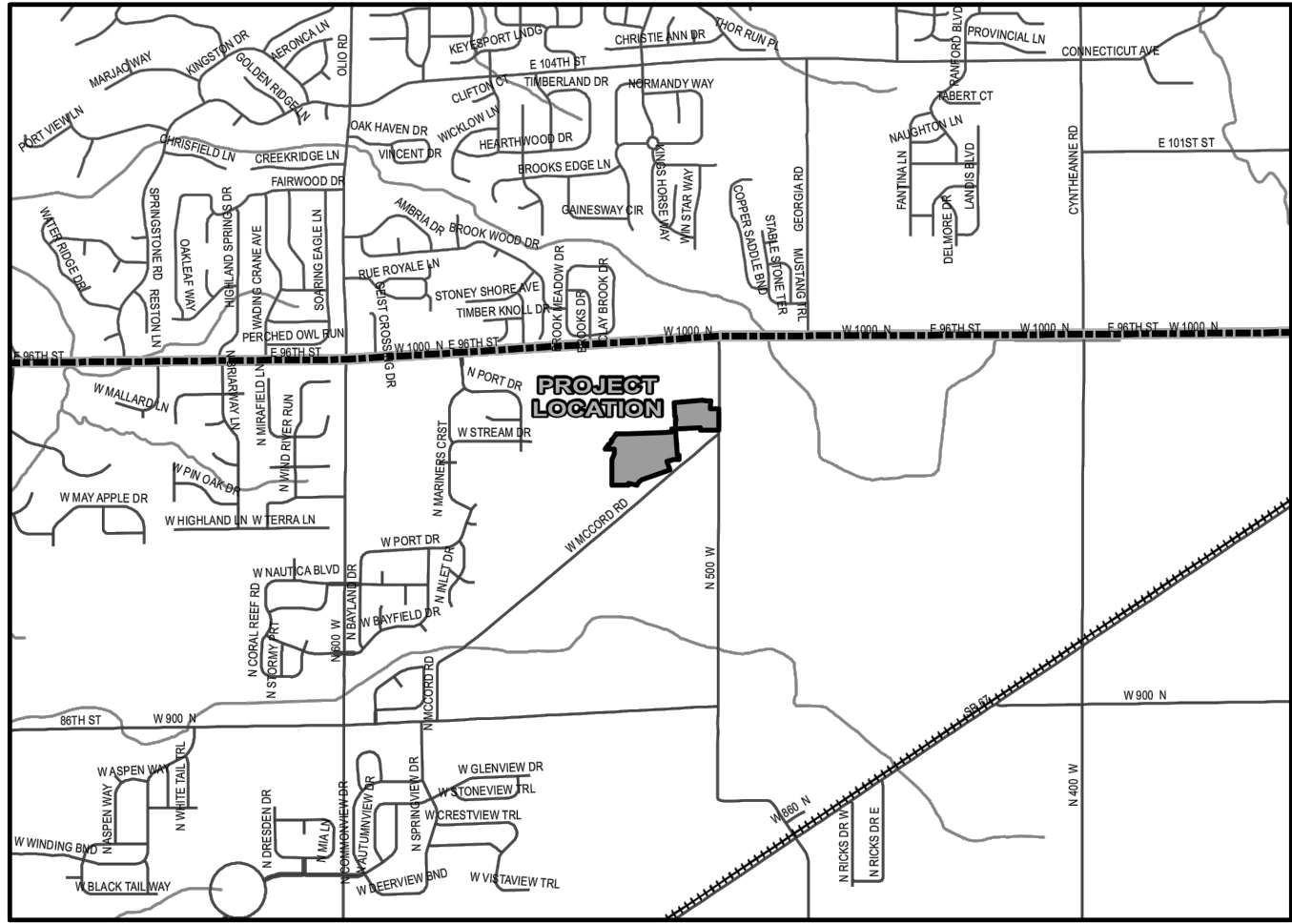

LOCATION MAP
SCALE 1" = 1 MILE

DEVELOPER:

LENNAR HOMES OF INDIANA, INC.
BILL BRYANT
9025 NORTH RIVER ROAD, SUITE 100
INDIANAPOLIS, INDIANA 46240
(317) 450-4634

CIVIL ENGINEER and SURVEYOR:

HWC ENGINEERING
135 N. PENNSYLVANIA ST., SUITE 2800
INDIANAPOLIS, IN 46204
(317) 347-3663
keichhorn@hwcengineering.com

LINEAR FOOTAGE OF STREETS	
CHAMBERS DRIVE	500 LF
GLENDON WAY	414 LF
HAUGHTON LANE	913 LF
PARKHURST CROSSING	579 LF
TOTAL	2,406 LF

DEVELOPMENT STANDARDS

	AREA "A"
MAXIMUM NUMBER OF LOTS	197
MINIMUM LOT AREA	7,500 SQ. FT
MINIMUM LOT WIDTH	
AT BUILDING LINE	60
MINIMUM FRONT YARD SETBACK	25 FEET
MINIMUM SIDE YARD SETBACK	5 FEET
MINIMUM REAR YARD SETBACK	25 FEET
MINIMUM LIVABLE FLOOR AREA	1,500 SF (SINGLE STORY) 1,800 SF (MULTI STORY)
MAXIMUM LOT COVERAGE	45%*
MAXIMUM HEIGHT - PRINCIPAL	35 FEET

*NOTE: LOTS 61,62,73-77 HAVE MAXIMUM LOT COVERAGE OF 55% PER ORDINANCE 091019 RECORDED AS INST. #201909743 IN THE OFFICE OF THE RECORDER OF HANCOCK COUNTY, INDIANA.

PLAN COMMISSION APPROVAL	_____
DRAINAGE APPROVAL	_____
ADDRESS APPROVAL	_____
EROSION CONTROL APPROVAL	_____
COUNTY ENGINEER APPROVAL	_____
COUNTY SANITARIAN APPROVAL	_____
COUNTY COMMISSIONERS APPROVAL	_____

CITY OF INDIANAPOLIS
DEPARTMENT OF BUSINESS & NEIGHBORHOOD SERVICES (Carroll Road ROW Permits)
TRAIE WHITE - Project Compliance Analyst
1200 Madison Avenue, Suite 100
Indianapolis, IN 46225
Traie.White@indy.gov

CITY OF LAWRENCE
DEPARTMENT OF PUBLIC WORKS (Carroll Road Drainage)
Renee Rafala - Senior Executive Assistant
9001 East 59th Street, Suite 205
Indianapolis, IN 46226
rrafala@cityoflawrence.org

NINESTAR CONNECT (Electric & Telecom)
ERIC MEYER (317) 323-2074
2243 East Main Street
Greenfield, Indiana 46140
EMEYER@NINESTARCONNECT.COM

COMCAST
MATT STRINGER
5330 E. 65th Street
Indianapolis, IN 46220
P: (317) 774-3384
F: (317) 219-5090
matthew_stringer@cable.comcast.com

AT&T
BRIAN WENTE
240 N Meridian Street
2nd Floor, Room 280
Indianapolis, Indiana 46220
P: (317) 252-4222
bw1917@att.com

HANCOCK COUNTY SURVEYOR
SUSAN BODKIN
Hancock County Annex
111 American Legion Place,
Suite 171
Greenfield, Indiana 46140
P: (317) 477-1150
sbodkin@hancockcoingov.org

VECTREN
SANDRA CASEY
16000 Allisonville Road
Noblesville, Indiana 46061
P: (317) 776-5532
F: (317) 776-5553
Mailing Address: P.O. Box 1700
Noblesville, Indiana 46061
sandra.casey@centerpointenergy.com

CITY OF INDIANAPOLIS
DEPARTMENT OF METROPOLITAN DEVELOPMENT (Carroll Road ROW Dedication)
Larry Calloway - Principal Planner II
200 E Washington St, Room 1842
Indianapolis, IN 46204
Larry.Calloway@indy.gov

CITIZENS ENERGY GROUP/ CWA AUTHORITY, INC. (WATER)
BRAD HOSTETLER
2150 DR. MARTIN LUTHER KING JR. STREET
INDIANAPOLIS, INDIANA 46202
P: (317) 927-4351
BHOSTETLER@CITIZENSENERGYGROUP.COM

MCCORDSVILLE FIRE DEPARTMENT
7580 N Form Street
McCordsville, Indiana 46055
P: (317) 335-9236

HANCOCK COUNTY HIGHWAY DEPT
GARY POOL
921 W. Osage Street
Greenfield, Indiana 46140
P: (317) 477-1130
gpool@hancockcoingov.org

TOWN OF MCCORDSVILLE
PLANNING AND BUILDING DEPT
RYAN CRUM
6280 W 800 N
McCordsville, Indiana 46055
P: (317) 335-3604
rcrum@mccordsville.org

TOWN OF MCCORDSVILLE
ENGINEERING DEPARTMENT
MARK WITSMAN
6280 W 800 N
McCordsville, IN 46055
P: (317) 335-3604
mwitsman@mccordsville.org

TOWN OF MCCORDSVILLE
PUBLIC WORKS
RON CRIDER
6280 W 800 N
McCordsville, IN 46055
P: (317) 335-3493
rcrider@mccordsville.org

McCORD POINTE SECTION 5

Lennar Homes of Indiana, Inc.

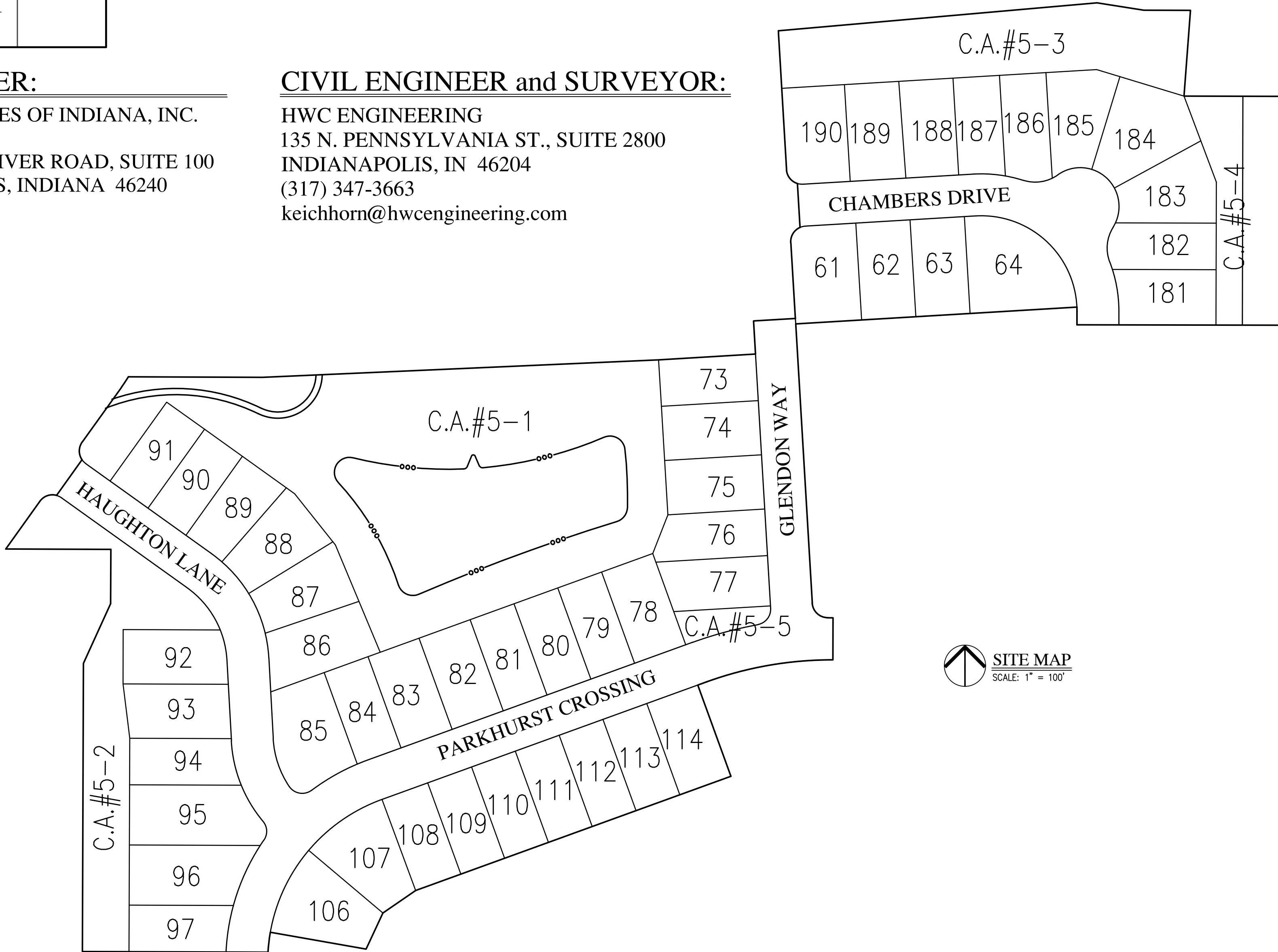

SITE MAP
SCALE: 1" = 100'



SOILS MAP
NOT TO SCALE

SOILS LEGEND

BR BROOKSTON SILTY CLAY LOAM
CRA CROSBY SILT LOAM, 0 TO 3 PERCENT SLOPES

SHEET LIST TABLE

Sheet Title	Sheet Description
C1.0	COVER
C1.1-C1.2	DEVELOPMENT PLAN
C1.3-C1.4	PRE-CONSTRUCTION STORMWATER POLLUTION PREVENTION & DEMOLITION PLAN
C1.5-C1.6	POST CONSTRUCTION STORMWATER POLLUTION PREVENTION PLAN
C1.7-C1.8	EMERGENCY FLOOD ROUTE PLAN
C1.9	MASTER UTILITY PLAN
C1.10-C1.11	SUBSURFACE DRAIN PLAN
C2.0-C2.2	STREET PLAN & PROFILE
C3.0	INTERSECTION & CUL-DE-SAC DETAILS
C3.1	TRAFFIC CONTROL AND LIGHTING PLAN
C4.0-C4.2	SANITARY SEWER PLAN & PROFILE
C6.0-C6.3	STORM SEWER PLAN & PROFILE
C7.0-C7.1	WATER DISTRIBUTION PLAN
C7.2	WATER DISTRIBUTION PLAN OAKCREST OFFSITE
C8.0	STORMWATER POLLUTION PREVENTION NOTES
C8.1-C8.3	STORMWATER POLLUTION PREVENTION DETAILS
C8.4	CONSTRUCTION DETAILS
C8.5	CITIZENS WATER DETAILS
L1.0	LANDSCAPE PLAN
L1.1	LANDSCAPE DETAILS

McCORDSVILLE TOWN STANDARDS

SHEET LIST TABLE

Sheet Title	Sheet Description
1	DIRECTIONS FOR USE & GENERAL NOTES
2	RIGHT-OF-WAY SECTIONS & PAVEMENT SPECIFICATIONS
3	RIGHT-OF-WAY DETAILS
4	UTILITY LOCATION GUIDELINES
5	DRIVE WAY & HANDICAP RAMP DETAILS
6	STORM SEWER STRUCTURE DETAILS
7	STORM SEWER BEDDING DETAILS AND GENERAL NOTES
8	SANITARY SEWER SPECIFICATIONS
9	SANITARY SEWER DETAILS
10	SANITARY SEWER LIFT STATION STANDARDS & GUIDELINES

REVISIONS		
DATE	DESCRIPTION	BY

HWC
ENGINEERING
INDIANAPOLIS - TERRE HAUTE
LAFAYETTE - MUNCIE - NEW ALBANY
www.hwcengineering.com

MCCORD POINTE SECTION 5
MCCORDSVILLE, INDIANA

COVER SHEET

PROFESSIONAL ENGINEER
No. 11400758
STATE OF INDIANA
NOTARY PUBLIC
Kathleen K. Keichhorn

DRAWN BY GM/TS	JOB NUMBER 2019-003-A
CHECKED BY KE	
DATE OCTOBER 25, 2019	
SCALE AS SHOWN	

C1.0
COVER SHEET

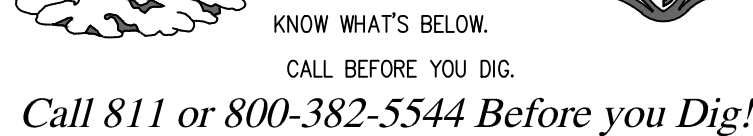

GRAPHIC SCALE

(IN FEET)

LEGEND:

EXISTING		RIGHT-OF-WAY LINE		EASEMENT LINE		PROPOSED

ABBREVIATIONS:

BC	- BACK OF CURB	TB	- TOP OF BANK GRADE
CL	- CENTERLINE	TC	- TOP OF CASTING GRADE
FG	- FINISHED GRADE	PAD	- PAD GRADE
FL	- FLOW LINE	MFPG	- MINIMUM FLOOD PROTECTION GRADE
HP	- HIGH POINT	MFFE	- MINIMUM FINISH FLOOR ELEVATION
INV	- INVERT ELEVATION	TW	- TOP OF WALL
LP	- LOW POINT	IEE	- INGRESS / EGRESS EASEMENT
ME	- MATCH EXISTING GRADE	ZS	- LOT NUMBER
NP	- NORMAL POOL (ELEVATION)	C.A.	- COMMON AREA
PC	- POINT OF CURVATURE	D.E.	- DRAINAGE EASEMENT
PRC	- POINT OF REVERSE CURVATURE	S.S.D.&U.E.	- SANITARY SEWER, DRAINAGE AND UTILITY EASEMENT
PT	- POINT OF TANGENCY	D.&U.E.	- DRAINAGE AND UTILITY EASEMENT
PVC	- POLYVINYL CHLORIDE PIPE	ESE	- EASEMENT
PVI	- POINT OF VERTICAL INTERSECTION	B.S.L.	- BUILDING SETBACK LINE
RCP	- REINFORCED CONCRETE PIPE	R/W	- RIGHT-OF-WAY

SEE SHEET C1.2 FOR OVERALL
GENERAL PROJECT NOTES.

BENCHMARK INFORMATION:

CUT SQUARE ON BACK OF CURB AT INTERSECTION OF
NORTH ANCHOR BEND AND NORTH MARINERS CREST.
SQUARE IS AT THE NORTH EAST PORTION OF INTERSECTION
3' WEST OF A FIRE HYDRANT.
ELEVATION = 847.28 (NGVD 29)

REVISIONS

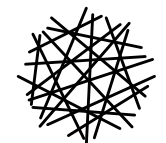

HWC
ENGINEERING

INDIANAPOLIS - TERRE HAUTE
LAFAYETTE - MUNCIE - NEW ALBANY
www.hwcengineering.com

**MCCORD POINTE SECTION 5
MCCORDSVILLE, INDIANA**

DEVELOPMENT PLAN



DRAWN BY GM/TS	JOB NUMBER 2019-003-A
CHECKED BY KE	
DATE OCTOBER 25, 2019	
SCALE AS SHOWN	
SHEET	

C1.1

DEVELOPMENT PLAN

LEGEND:

EXISTING	PROPOSED
	RIGHT-OF-WAY LINE
	EASEMENT LINE
	SETBACK LINE
	CENTERLINE
	SWALE / FLOWLINE
	SUBSURFACE DRAIN
	SANITARY SEWER
	STORM SEWER
	STORM CULVERT
	WATER MAIN
	CONTOUR, MAJOR
	CONTOUR, MINOR
	FENCE
	TREE LINE
	SANITARY MANHOLE
	STORM MANHOLE
	STORM INLET
	STORM END SECTION
	FIRE HYDRANT
	STREET LIGHT
	FLOW ARROW
	SPOT ELEVATION
	PAVEMENT ELEVATION
	A.D.A. HANDICAP RAMP
	2' ROLL CURB
	POND SIGNAGE
	4 FT CONC. APRON (SEE CONCRETE SECTION - SHEET C3.2)
	20' SAFETY RAMP @ 6:1 SLOPE (CONSTRUCTED WITH COMPACTED CLAY)
	2' ROLL CURB (REVERSE SLOPE)
	SSD CLEANOUT
	SANITARY CLEANOUT

ABBREVIATIONS:

BC	- BACK OF CURB	TB	- TOP OF BANK GRADE
CL	- CENTERLINE	TC	- TOP OF CASTING GRADE
FG	- FINISHED GRADE	PAD	- PAD GRADE
FL	- FLOW LINE	MFGP	- MINIMUM FLOOD PROTECTION GRADE
HP	- HIGH POINT	MFFE	- MINIMUM FINISH FLOOR ELEVATION
INV	- INVERT ELEVATION	TW	- TOP OF WALL
LP	- LOW POINT	IEE	- INGRESS / EGRESS EASEMENT
ME	- MATCH EXISTING GRADE	ZS	- LOT NUMBER
NP	- NORMAL POOL (ELEVATION)	C.A.	- COMMON AREA
PC	- POINT OF CURVATURE	D.E.	- DRAINAGE EASEMENT
PRC	- POINT OF REVERSE CURVATURE	S.S.D.&U.E.	- SANITARY SEWER, DRAINAGE AND UTILITY EASEMENT
PT	- POINT OF TANGENCY	D.&U.E.	- DRAINAGE AND UTILITY EASEMENT
PVC	- POLYVINYL CHLORIDE PIPE	ESMT.	- EASEMENT
PVI	- POINT OF VERTICAL INTERSECTION	B.S.L.	- BUILDING SETBACK LINE
RCP	- REINFORCED CONCRETE PIPE	R/W	- RIGHT-OF-WAY

BENCHMARK INFORMATION:

OUT SQUARE ON BACK OF CURB AT INTERSECTION OF NORTH ANCHOR BEND AND NORTH MARINERS CREST. SQUARE IS AT THE NORTH EAST PORTION OF INTERSECTION 3' WEST OF A FIRE HYDRANT.
ELEVATION = 847.28 (NGVD 29)

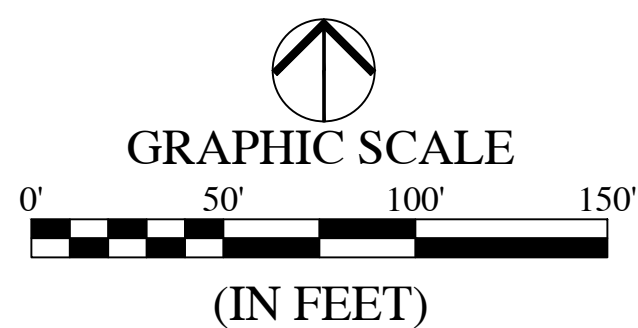

REVISIONS

NO.	DESCRIPTION	DATE



MCCORD POINTE SECTION 5 MCCORDSVILLE, INDIANA

DEVELOPMENT PLAN

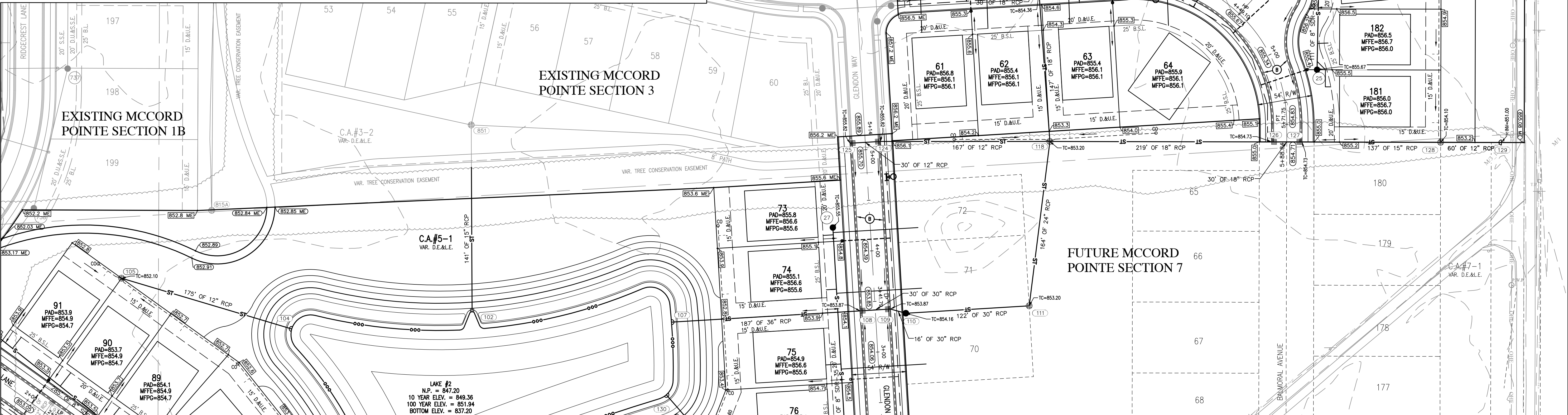

FOR CONTINUATION SEE SHEET C1.1

- #### OVERALL GENERAL PROJECT NOTES
- NOT ALL GAS, POWER, OR TELEPHONE LINES, WHETHER ABOVE OR BELOW GROUND, HAVE BEEN SHOWN ON THE DRAWINGS. ANY UNDERGROUND INFORMATION SHOWN ON THE DRAWINGS HAS BEEN DETERMINED FROM THE BEST AVAILABLE INFORMATION AND IS GIVEN FOR THE CONTRACTOR'S BENEFIT. THE CONTRACTOR SHALL ASSUME ALL RESPONSIBILITY FOR PROTECTING ALL UTILITIES IN HIS WORK AREA WHETHER SHOWN OR NOT, AND MUST REALIZE THAT THE ACTUAL LOCATION OF THE UTILITIES MAY BE DIFFERENT FROM THAT SHOWN ON THE DRAWINGS. ALL EXISTING UTILITIES ENCOUNTERED IN THE WORK, WHETHER IN PUBLIC RIGHTS OF WAY OR ON PRIVATE PROPERTY, SHALL BE THE CONTRACTOR'S RESPONSIBILITY TO MAINTAIN IN SERVICE. ANY UTILITIES WHICH CAN BE REMOVED DURING CONSTRUCTION WITHOUT UNDUE INTERRUPTION TO SERVICE MAY BE REMOVED AND REPLACED BY THE CONTRACTOR WITH THE PERMISSION OF THE UTILITY. IF MINOR CONFLICTS ARISE, THE CONTRACTOR MAY SHIFT THE PROPOSED LOCATION OF THE INSTALLATION OF THE WORK. BEFORE WORKING WITH OR AROUND UTILITIES, THE APPLICABLE UTILITY COMPANY SHALL BE NOTIFIED BY THE CONTRACTOR.
 - SAFETY PROVISIONS FOR THE WORK SHALL BE IN FULL COMPLIANCE WITH ALL APPLICABLE RULES AND REGULATIONS OF THE INDIANA OSHA AND ANY OTHER LOCAL STATE OR FEDERAL AGENCY HAVING JURISDICTION, IN ACCORDANCE WITH GENERALLY ACCEPTED CONSTRUCTION PRACTICES. THE CONTRACTOR WILL BE SOLELY AND COMPLETELY RESPONSIBLE FOR CONDITIONS OF THE JOB SITE, INCLUDING SAFETY OF ALL PERSONS AND PROPERTY DURING PERFORMANCE OF THE WORK. CONTRACTOR SHALL AT MINIMUM, PROVIDE TRAFFIC CONTROL AS REQUIRED TO SAFELY PROTECT THE GENERAL PUBLIC. THE CONTRACTOR'S WORK FORCES AND THE WORK, TRAFFIC CONTROL SHALL CONFORM TO THE REQUIREMENTS OF THE LATEST EDITION OF THE INDIANA MANUAL ON UNIFORM TRAFFIC CONTROL DEVICES FOR STREETS AND HIGHWAYS, AND THE INDIANA DEPARTMENT OF TRANSPORTATION STANDARD SPECIFICATIONS, SPECIAL PROVISIONS, STANDARD DETAILS AND GENERAL INSTRUCTIONS TO FIELD EMPLOYEES. THE REQUIREMENT WILL APPLY CONTINUOUSLY AND NOT TO BE LIMITED TO NORMAL WORKING HOURS. THE OPTION OF THE OWNER AND/OR ENGINEER TO CONDUCT CONSTRUCTION REVIEW OF THE CONTRACTOR'S PERFORMANCE IS NOT INTENDED TO INCLUDE REVIEW OF THE ADEQUACY OF THE CONTRACTOR'S SAFETY MEASURES, IN, ON OR NEAR THE CONSTRUCTION SITE. CONTRACTOR WILL BE RESPONSIBLE FOR PROVIDING AND MAINTAINING ALL BARRICADES, FENCES, WARNING SIGNS, FLASHING LIGHTS, TEMPORARY WALKWAYS, AND TRAFFIC CONTROL DURING CONSTRUCTION. CONTRACTOR TO COMPLY WITH ALL OSHA REGULATIONS, REQUIREMENTS, SAFETY MEETING REQUIREMENTS AND AGENCY REQUIREMENTS FOR TRAFFIC CONTROL AND SAFETY PRECAUTIONS, THERE WILL BE NO SEPARATE OR ADDITIONAL PAYMENT FOR THIS WORK.
 - WHERE PROPERTY MARKERS, SECTION CORNERS, SURVEY MARKS OR BENCHMARKS, SUCH AS STONES, PIPES, OR OTHER SUCH MONUMENTS ARE ENCOUNTERED AND CONFLICT WITH THE WORK, THE ENGINEER SHALL BE NOTIFIED BEFORE THEY ARE DISTURBED. THE MARKERS SHALL BE PROTECTED AFTER THE OWNER, ENGINEER, AND AUTHORIZED SURVEYOR OR AGENT HAS WITNESSED OR REFERENCED THEIR LOCATIONS.
 - ALL MATERIALS DENOTED "SALVAGED" SHALL BE STORED AND PROTECTED AT THE SITE FOR THE OWNER TO COLLECT OR FOR THE CONTRACTOR TO RE-USE AS INDICATED.
 - THERE SHALL BE NO CHANGES WITHOUT WRITTEN APPROVAL OF ENGINEER.
 - ALL GRADES AT BOUNDARY SHALL MEET EXISTING GRADES.
 - CONTRACTOR SHALL MINIMIZE DAMAGE TO EXISTING TREES.
 - REMOVE AND BACKFILL ALL AREAS WHERE ANY FIELD TILE CROSSES PROPOSED HOUSE PADS. ALL FIELD TILES INTERCEPTED TO BE PERPETUATED INTO STORM SEWER SYSTEM OR LAKE. THE SUBCONTRACTOR SHALL NOTIFY IN WRITING THE OWNER AND THE ENGINEER IN ANY CIRCUMSTANCES WHERE THIS CANNOT BE ACCOMPLISHED.
 - IT IS THE CONTRACTOR'S RESPONSIBILITY TO FIELD VERIFY ALL UTILITY LOCATIONS.
 - CONTRACTOR SHALL STAMP THE LETTER "S" IN THE CURB PERPENDICULAR TO THE LATERAL MARKER.
 - STRUCTURES RECEIVING SUB-SURFACE DRAIN (SSD) SHALL HAVE BOTH PORTS CORE DRILLED. "T" OR "Y" BLIND CONNECTIONS ARE NOT ALLOWED.
 - ALL STORM SEWER CASTINGS SHALL BE LABELED "DUMP NO WASTE--DRAINS TO WATERWAY".
 - STRUCTURAL FILL: SHALL BE COMPACTED TO AT LEAST 95% STANDARD PROCTOR MAXIMUM DRY DENSITY (ASTM D-698). SHALL BE FREE OF ORGANIC MATERIAL, DEBRIS, DELETERIOUS MATERIALS AND FROZEN SOLIDS.
 - ALL ROADS MUST BE BROUGHT BACK TO ORIGINAL OR BETTER CONDITION, INCLUDING BUT NOT LIMITED TO STRIPING, STONE SHOULDERS AND SIGNAGE. REPAIRS (I.E. STRIPING) SHALL COINCIDE WITH THE ADJOINING ROAD.
 - CLAY POND LINES ARE REQUIRED IF SIGNIFICANT SAND OR GRAVEL STRATIFICATIONS ARE ENCOUNTERED DURING EXCAVATION OF POND.
 - ALL COMMON AREA SIDEWALKS OR PATHS ARE TO BE CONSTRUCTED AS PART OF THE SITE INFRASTRUCTURE. INDIVIDUAL LOT SIDEWALKS TO BE CONSTRUCTED AT THE TIME OF HOME CONSTRUCTION.

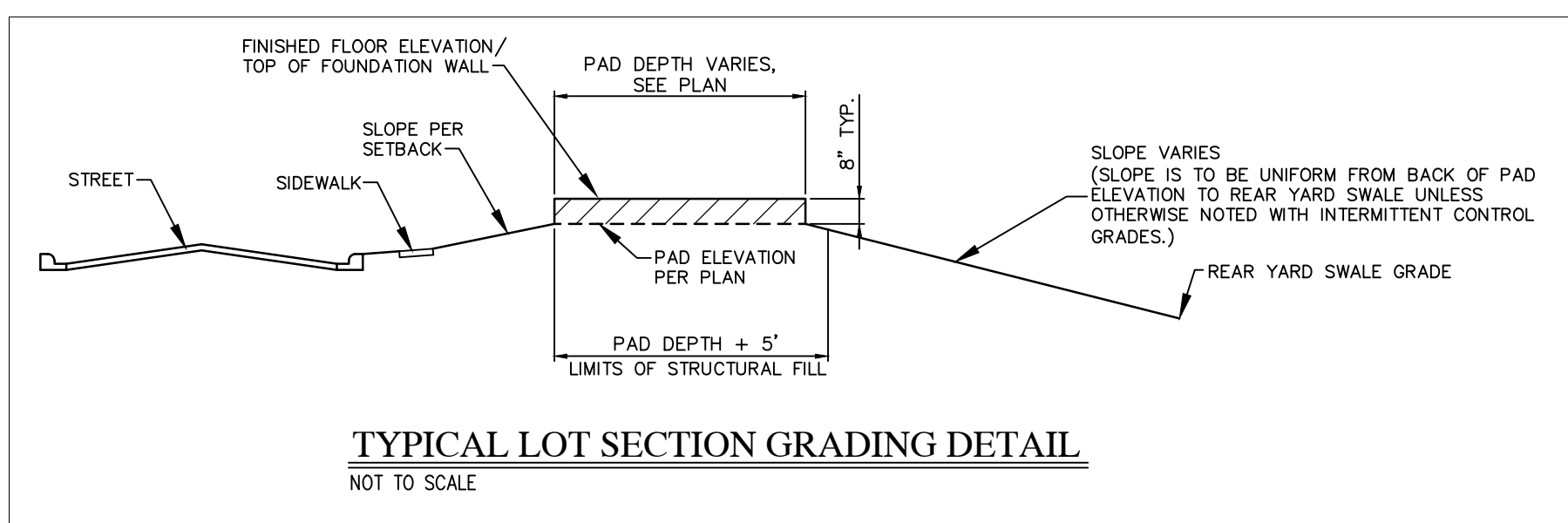

TYPICAL LOT SECTION GRADING DETAIL
NOT TO SCALE

PROFESSIONAL ENGINEER
No. 11400758
STATE OF INDIANA
NOTARY PUBLIC
Christopher K. Wickham
DRAWN BY: GM/TS
CHECKED BY: KE
DATE: OCTOBER 25, 2019
SCALE: AS SHOWN
JOB NUMBER: 2019-003-A
SHEET

C1.2

DEVELOPMENT PLAN

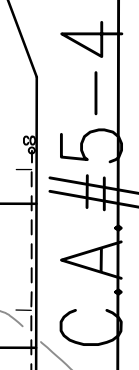

SANITARY CLEANOUT

ELEVATION = 847.28 (NGVD 29)



HWC
ENGINEERING

INDIANAPOLIS - TERRE HAUTE
LAFAYETTE - MUNCIE - NEW ALBANY

www.hwcengineering.com

MASTER UTILITY PLAN

© 2019

Plot Date: Oct 28, 2019 Plot Time: 9:59am File Name: W:\CalAtlantic Homes\2019-2020-E Lennar- McCord Pointe Sec 5\Design\CAD\19263E\Subsurface Drain Plan.dwg, Layout: C1.10 By: tsmith

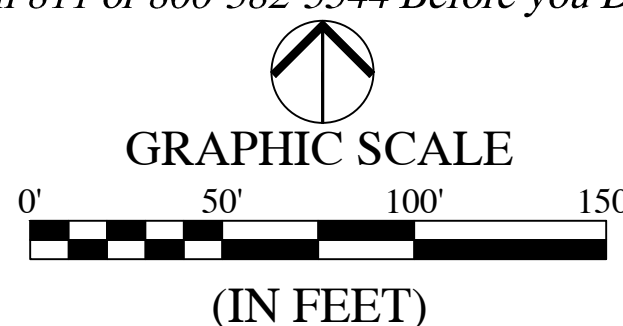
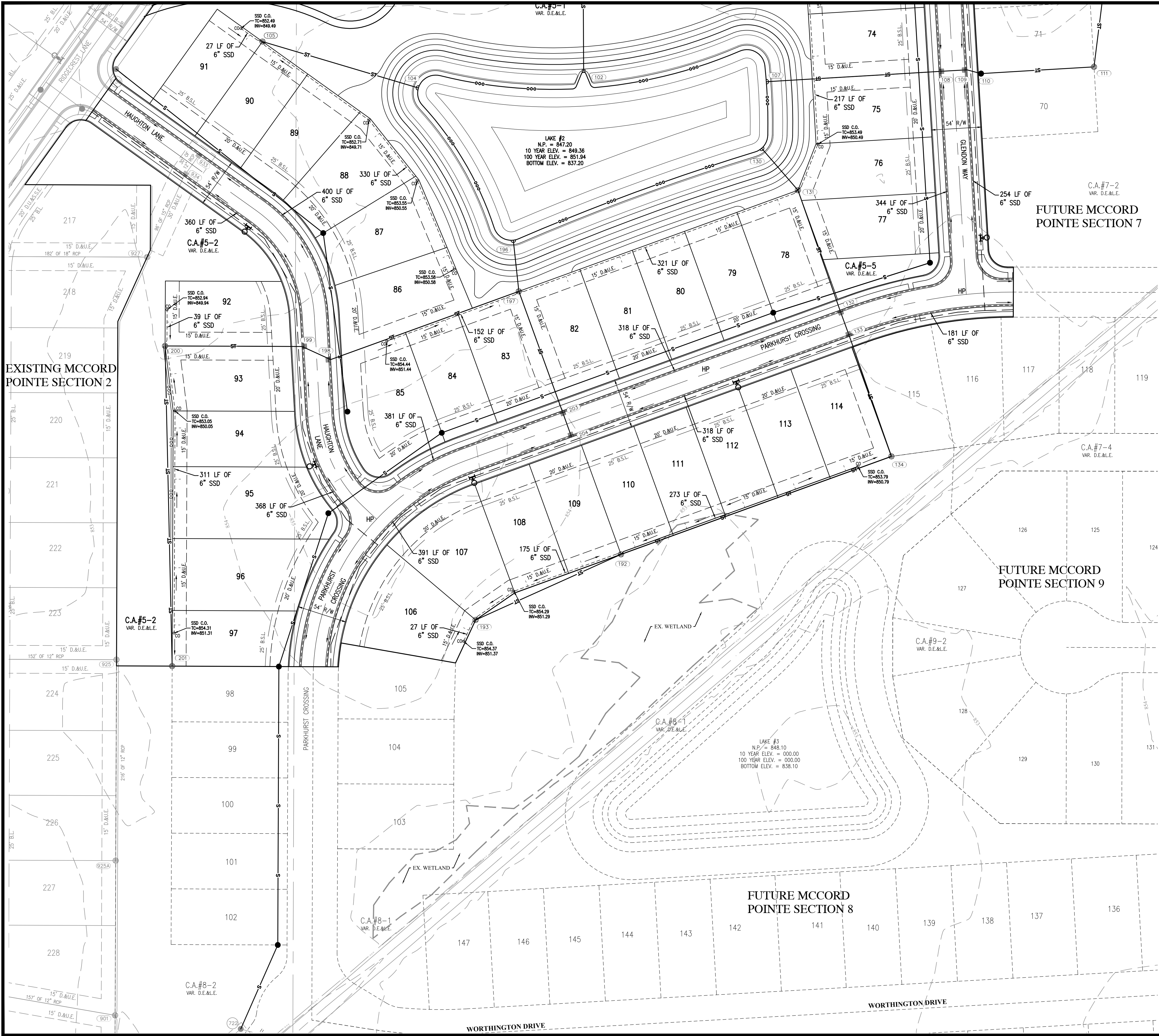

LEGEND:

EXISTING	PROPOSED
---	RIGHT-OF-WAY LINE
---	EASEMENT LINE
---	SETBACK LINE
---	CENTERLINE
S	SANITARY SEWER
ST	STORM SEWER
ST	STORM CULVERT
W	WATER MAIN
---	FENCE
---	TREE LINE
SM	SANITARY MANHOLE
SM	STORM MANHOLE
SI	STORM INLET
SE	STORM END SECTION
FD	FIRE HYDRANT
CO	CLEAN OUT
---	CURB SUBSURFACE DRAIN
---	REAR YARD SUBSURFACE DRAIN FOR HOUSE SUMP PUMP
---	SUBSURFACE DRAIN LATERAL

BENCHMARK INFORMATION:
OUT SQUARE ON BACK OF CURB AT INTERSECTION OF NORTH ANCHOR BEND AND NORTH MARINERS CREST. SQUARE IS AT THE NORTH EAST PORTION OF INTERSECTION 3' WEST OF A FIRE HYDRANT. ELEVATION = 847.28 (NGVD 29).

REVISIONS

NO.	DESCRIPTION	DATE

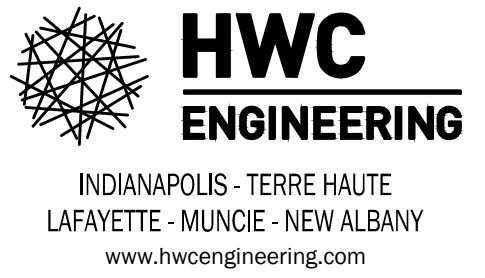

MCCORD POINTE SECTION 5
MCCORDSVILLE, INDIANA
SUBSURFACE DRAIN PLAN

PROFESSIONAL ENGINEER
No. 11400758
STATE OF INDIANA
NOTARIAL SEAL

Kristopher K. Riehlman

DRAWN BY	GM/TS
CHECKED BY	KE
DATE	OCTOBER 25, 2019
SCALE	AS SHOWN
SHEET	

C1.10
SUBSURFACE DRAIN PLAN

JOB NUMBER 2019-003-A

BENCHMARK INFORMATION:

CUT SQUARE ON BACK OF CURB AT INTERSECTION OF NORTH ANCHOR BEND AND NORTH MARINERS CREST. SQUARE IS AT THE NORTH EAST PORTION OF INTERSECTION 3' WEST OF A FIRE HYDRANT. ELEVATION = 847.28 (NGVD 29).

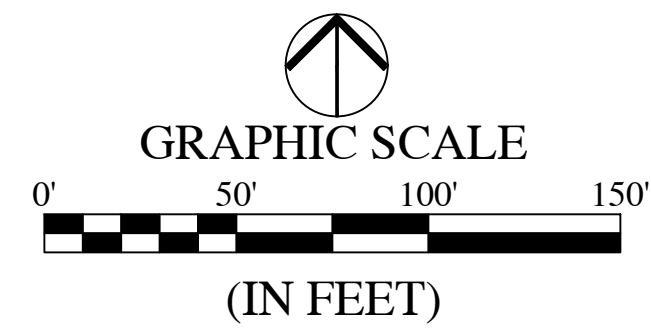

LEGEND:

EXISTING		PROPOSED
---	RIGHT-OF-WAY LINE	---
---	EASEMENT LINE	---
---	SETBACK LINE	---
---	CENTERLINE	---
S	SANITARY SEWER	S
ST	STORM SEWER	ST
ST	STORM CULVERT	ST
W	WATER MAIN	W
---	FENCE	---
---	TREE LINE	---
○	SANITARY MANHOLE	●
○	STORM MANHOLE	●
○	STORM INLET	○
○	STORM END SECTION	○
○	FIRE HYDRANT	○
○	CLEAN OUT	○
---	CURB SUBSURFACE DRAIN	---
---	REAR YARD SUBSURFACE DRAIN FOR HOUSE SUMP PUMP	---
---	SUBSURFACE DRAIN LATERAL	---

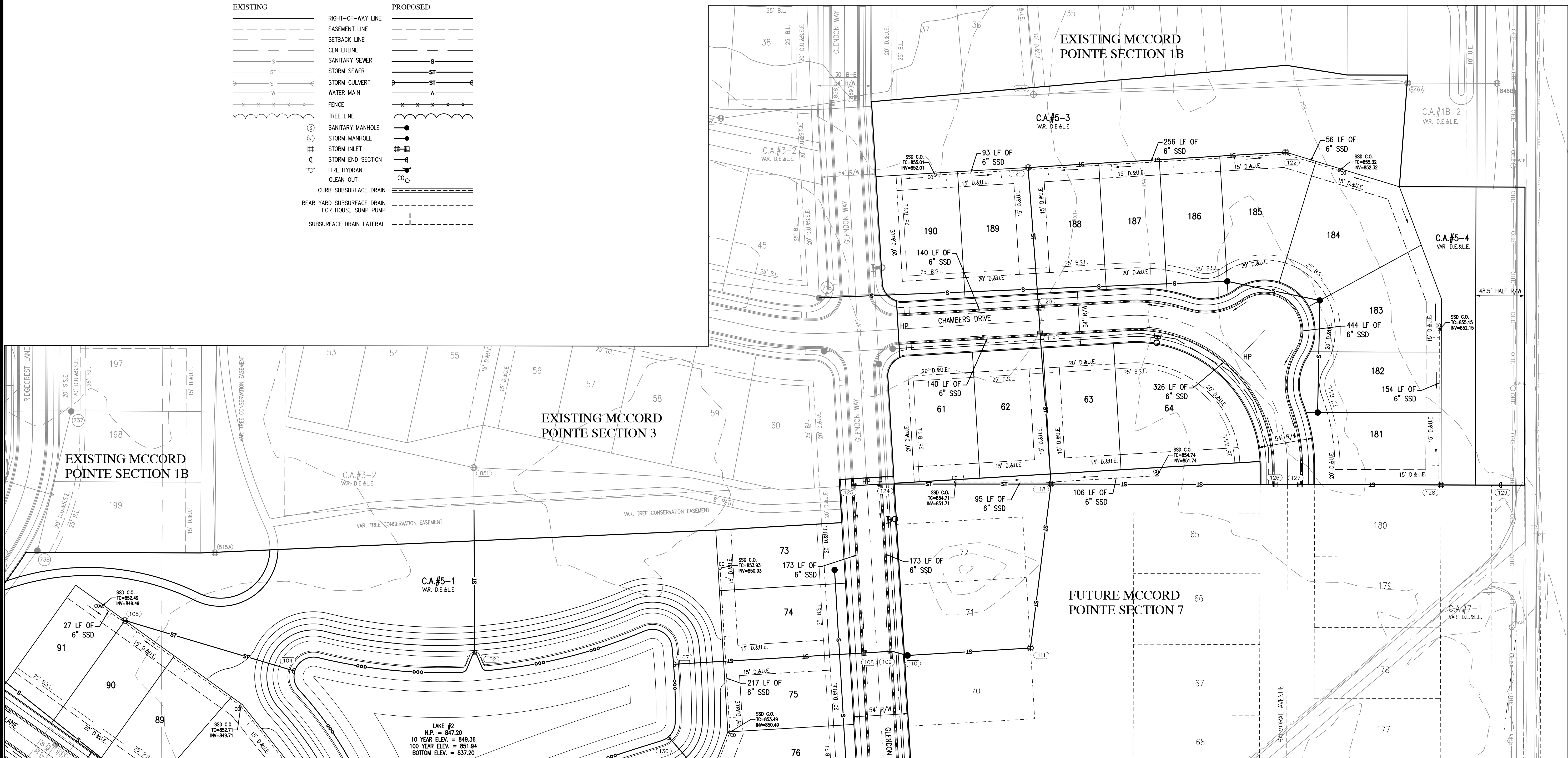

FOR CONTINUATION SEE SHEET C1.1

REVISIONS

NO.	DESCRIPTION	DATE

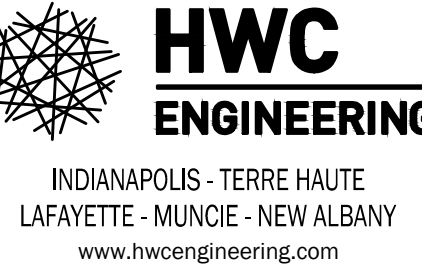

**MCCORD POINTE SECTION 5
MCCORDSVILLE, INDIANA
SUBSURFACE DRAIN PLAN**



DRAWN BY GM/TS	JOB NUMBER 2019-003-A
CHECKED BY KE	
DATE OCTOBER 25, 2019	
SCALE AS SHOWN	
SHEET	

C1.11

SUBSURFACE DRAIN PLAN





HWC
ENGINEERING

INDIANAPOLIS - TERRE HAUTE
LAFAYETTE - MUNCIE - NEW ALBANY

www.hwcengineering.com

**MCCORD POINTE SECTION 5
MCCORDSVILLE, INDIANA
INTERSECTION DETAILS**



DRAWN BY GM/TS	JOB NUMBER 2019-003--A
CHECKED BY KE	
DATE OCTOBER 25, 2019	
SCALE AS SHOWN	
SHEET	

C3.0

INTERSECTION DETAILS

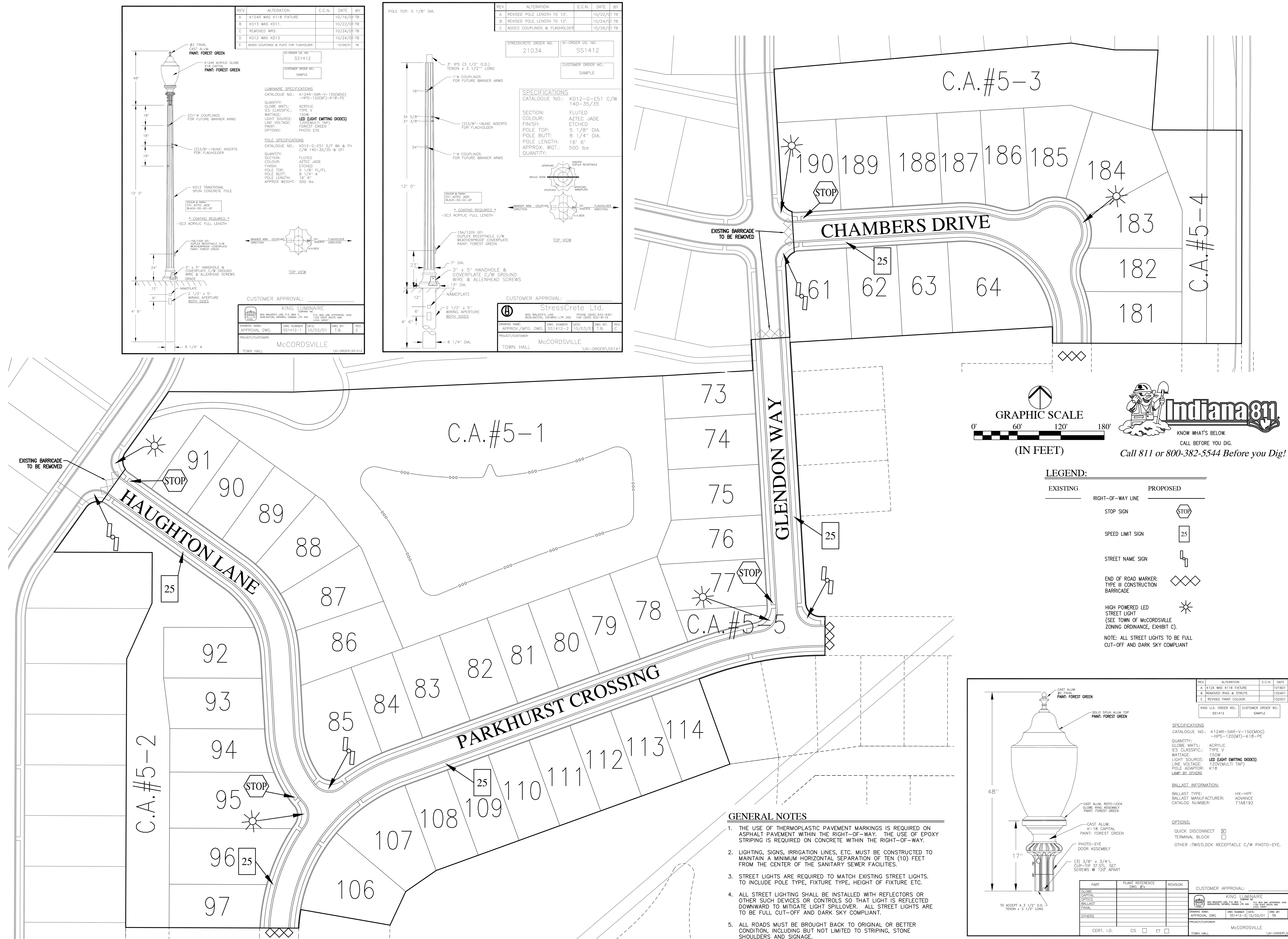
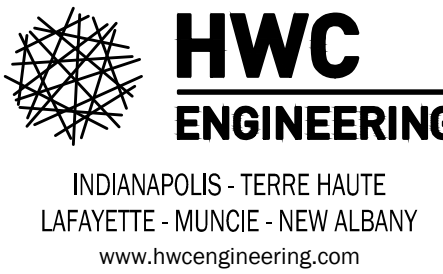
[illegible]

**MCCORD POINTE SECTION 5
MCCORDSVILLE, INDIANA**

**TRAFFIC CONTROL AND LIGHTING
PLAN**



Christopher F. Eichhorn

DRAWN BY
TD/GM

CHECKED BY
KE

DATE
OCTOBER 25, 2019

SCALE
AS SHOWN

SHEET

JOB NUMBER
2019-003-A

C3.1

TRAFFIC CONTROL AND LIGHTING PLAN

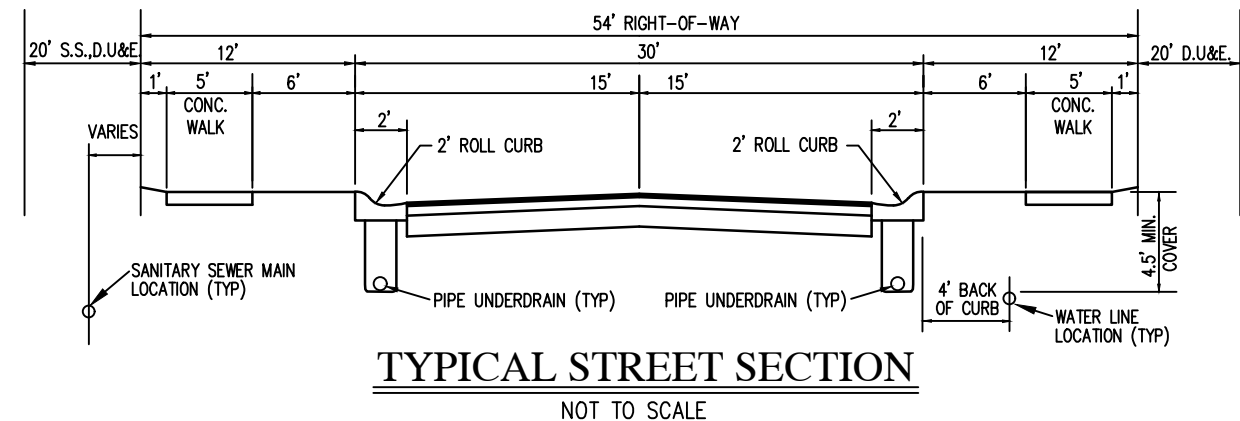
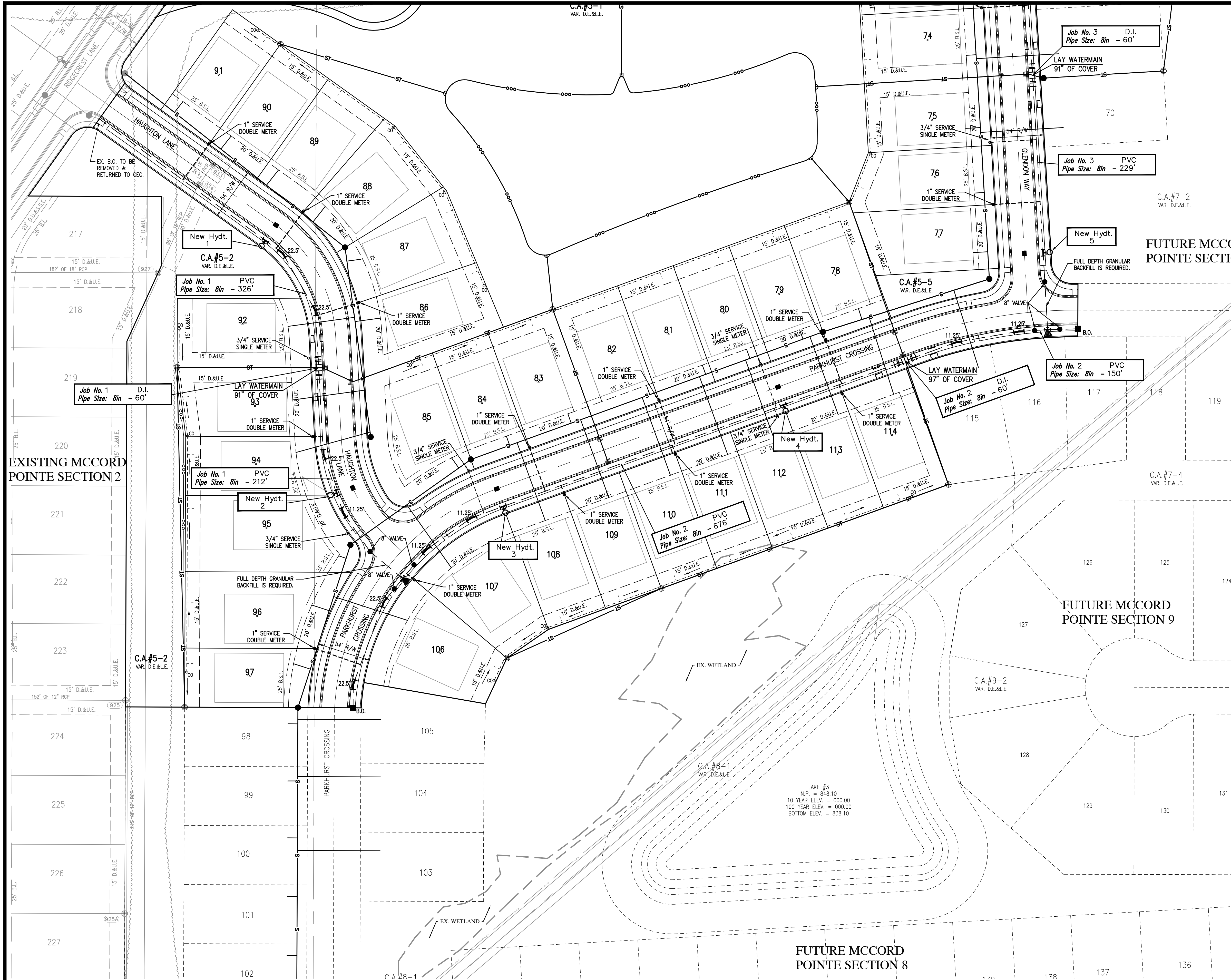

DEVELOPER:
LENNAR HOMES OF INDIANA, INC.
9025 NORTH RIVER ROAD, SUITE 100
INDIANAPOLIS, INDIANA 46240
(317) 846-3148

CONTRACTOR TO MARK ALL BELOW GRADE FITTINGS AND PIPE MATERIAL CHANGES WITH LATHE FOR SURVEY VERIFICATION AT TIME OF BACKFILL.

PROJECT NAME: MCCORD POINTE, SECTION 5
PROJECT NUMBER: J-19-XXX
DIST. MAP NO. XXX
METER MAP NO. XXXX
LOTS 48
TAX CODE XXXXX
PRESSURE DIST. -
DRAFTER HWCENG/TD
DATE -/-/19
REVISED

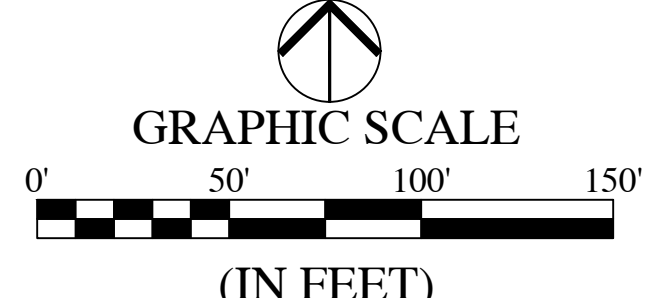

LEGEND:

- Existing Water Main
- Proposed Water Main
- Directional Bore
- Inlet
- Hydrant
- Hydrant with Hydrant Valve
- Butterfly Valve
- Valve
- Adapter
- Blowoff Assembly
- Bend
- Kicker Block
- Vertical Bend
- Casing Pipe
- Gas Lines
- Telephone Lines
- Electric Lines

STANDARD PRACTICE DRAWING "O" INSTALLATION OF RESTRAINTS MUST BE FOLLOWED, INCLUDING LOWERING OF WATER DURING CROSSINGS.
INDOT APPROVED SNOWBLOWABLE RAISED PAVEMENT MARKERS (W/BUE REFLECTOR LENS). THE INSTALLATION OF THE PAVEMENT MARKERS SHALL COMPLY W/SEC. 800 & 900 OF THE INDOT SPECIFICATIONS AND STANDARDS DRAWING.

GENERAL NOTES

- SEE CITIZENS ENERGY GROUP WATER STANDARD MANUAL LATEST VERSION
- MINIMUM COVER OVER TOP OF ALL WATER MAINS TO BE 54" FROM FINISH GRADE.
- FIRE HYDRANTS SHALL HAVE A 5-INCH STORZ'S CONNECTION INSTALLED.
- VALVES TO BE PLACED IN GRASS AREAS.
- ALL WATER LINES THAT CROSS EITHER SANITARY OR STORM SEWERS MUST BE SEPARATED WITH 18" OF VERTICAL CLEARANCE.
- STANDARD PRACTICE O INSTALLATION OF RESTRAINTS MUST BE FOLLOWED DURING CONSTRUCTION OF WATER MAIN

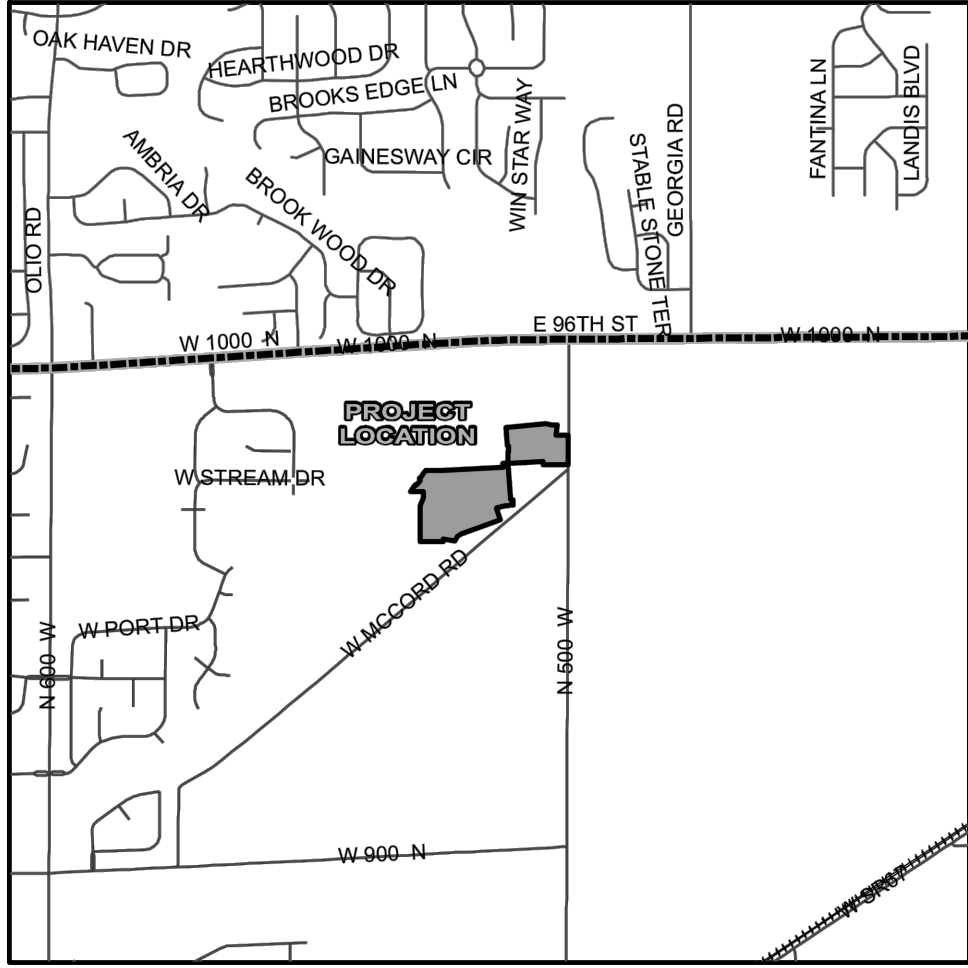

VICINITY MAP
SCALE: 1" = 2000'

REVISIONS	



MCCORD POINTE SECTION 5
MCCORDSVILLE, INDIANA
WATER DISTRIBUTION PLAN

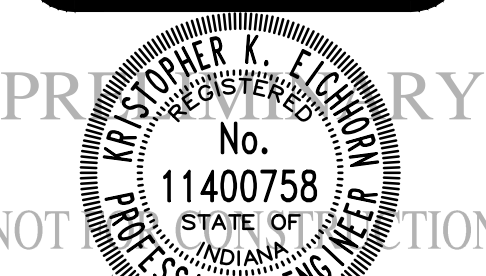

DRAWN BY TD/GM	JOB NUMBER 2019-003-A
CHECKED BY KE	
DATE OCTOBER 25, 2019	
SCALE AS SHOWN	
SHEET	

C7.0
WATER DISTRIBUTION
PLAN

CITIZENS WATER PROJECT LEGEND				
Project Name: McCORD POINTE, SECTION 5				
Project Number: J-19-XXX				
Job #	Street Name	Pipe Size	Pipe Type	Total Pipe
1	HAUGHTON LANE	8"	PVC	538'
1	HAUGHTON LANE	8"	D.I.	60'
2	PARKHURST CROSSING	8"	PVC	826'
2	PARKHURST CROSSING	8"	D.I.	60'
3	GLENDON WAY	8"	PVC	373'
3	GLENDON WAY	8"	D.I.	60'
4	CHAMBERS DRIVE	8"	PVC	459'
# OF SERVICE LINES				TOTAL
6	SINGLE SERVICE LINE	3/4"	PE	169'
21	DOUBLE SERVICE LINE	1"	PE	808'
27 SERVICE LINES FOR 48 LOTS				TOTAL 977'

LEGEND:

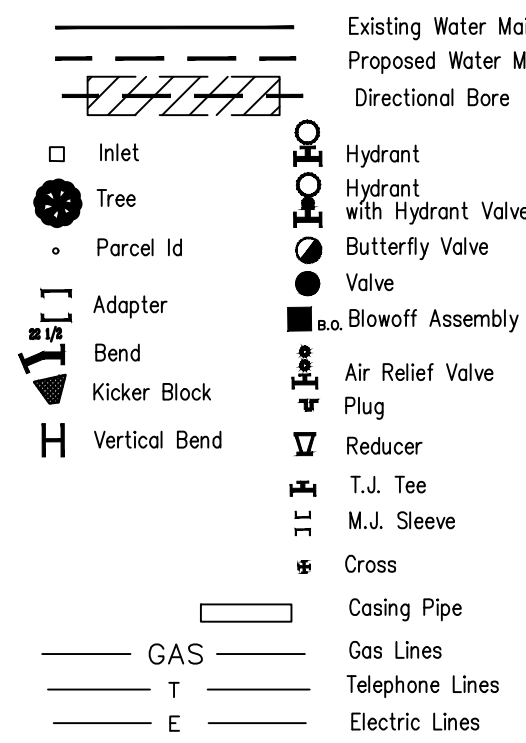

STANDARD PRACTICE DRAWING "O" INSTALLATION OF RESTRAINTS MUST BE FOLLOWED, INCLUDING LOWERING OF WATER DURING CROSSINGS

INDOT APPROVED SNOWPLOWABLE RAISED PAVEMENT MARKERS (W/BUE REFLECTOR LENS). THE INSTALLATION OF THE PAVEMENT MARKERS SHALL COMPLY W/SEC. 800 & 900 OF THE INDOT SPECIFICATIONS AND STANDARDS DRAWING.

GENERAL NOTES

- SEE CITIZENS ENERGY GROUP WATER STANDARD MANUAL LATEST VERSION
- MINIMUM COVER OVER TOP OF ALL WATER MAINS TO BE 54" FROM FINISH GRADE.
- FIRE HYDRANTS SHALL HAVE A 5-INCH STORZ'S CONNECTION INSTALLED.
- VALVES TO BE PLACED IN GRASS AREAS.
- ALL WATER LINES THAT CROSS EITHER SANITARY OR STORM SEWERS MUST BE SEPARATED WITH 18" OF VERTICAL CLEARANCE.
- STANDARD PRACTICE O INSTALLATION OF RESTRAINTS MUST BE FOLLOWED DURING CONSTRUCTION OF WATER MAIN



FOR CONTINUATION SEE SHEET C7.0

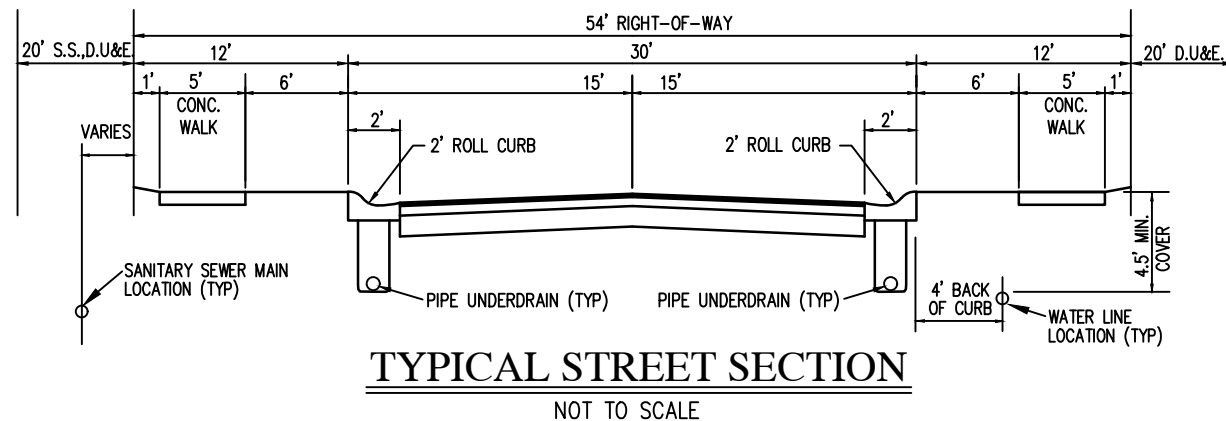

DEVELOPER:
LENNAR HOMES OF INDIANA, INC.
9025 NORTH RIVER ROAD, SUITE 100
INDIANAPOLIS, INDIANA 46240
(317) 846-3148

CONTRACTOR TO MARK ALL BELOW GRADE FITTINGS AND PIPE MATERIAL CHANGES WITH LATHE FOR SURVEY VERIFICATION AT TIME OF BACKFILL.

PROJECT NAME: McCORD POINTE, SECTION 5
PROJECT NUMBER: J-19-XXX
DIST. MAP NO. XXX
METER MAP NO. XXXX
LOTS 48
TAX CODE XXXXX
PRESSURE DIST. HWCENG/TD
DRAFTER -
DATE -/-/19
REVISED

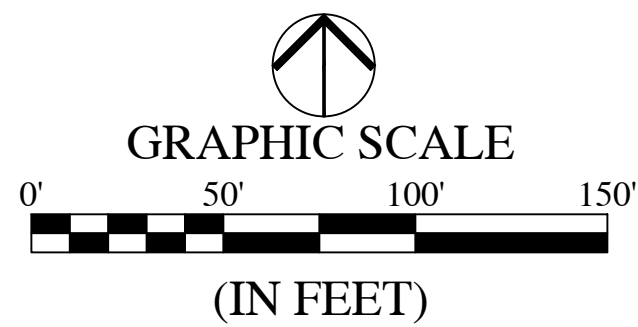

REVISIONS		

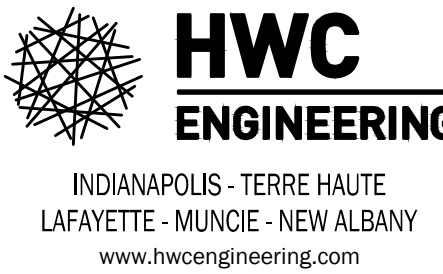

MCCORD POINTE SECTION 5
MCCORDSVILLE, INDIANA
WATER DISTRIBUTION PLAN



DRAWN BY TD/GM	JOB NUMBER 2019-003--A
CHECKED BY KE	
DATE OCTOBER 25, 2019	
SCALE AS SHOWN	
SHEET	

C7.1
WATER DISTRIBUTION PLAN



LEGEND:

LANDSCAPE LEGEND:

**MCCORD POINTE SECTION 5
MCCORDSVILLE, INDIANA
LANDSCAPE PLAN**

LANDSCAPE PLAN

© 2019

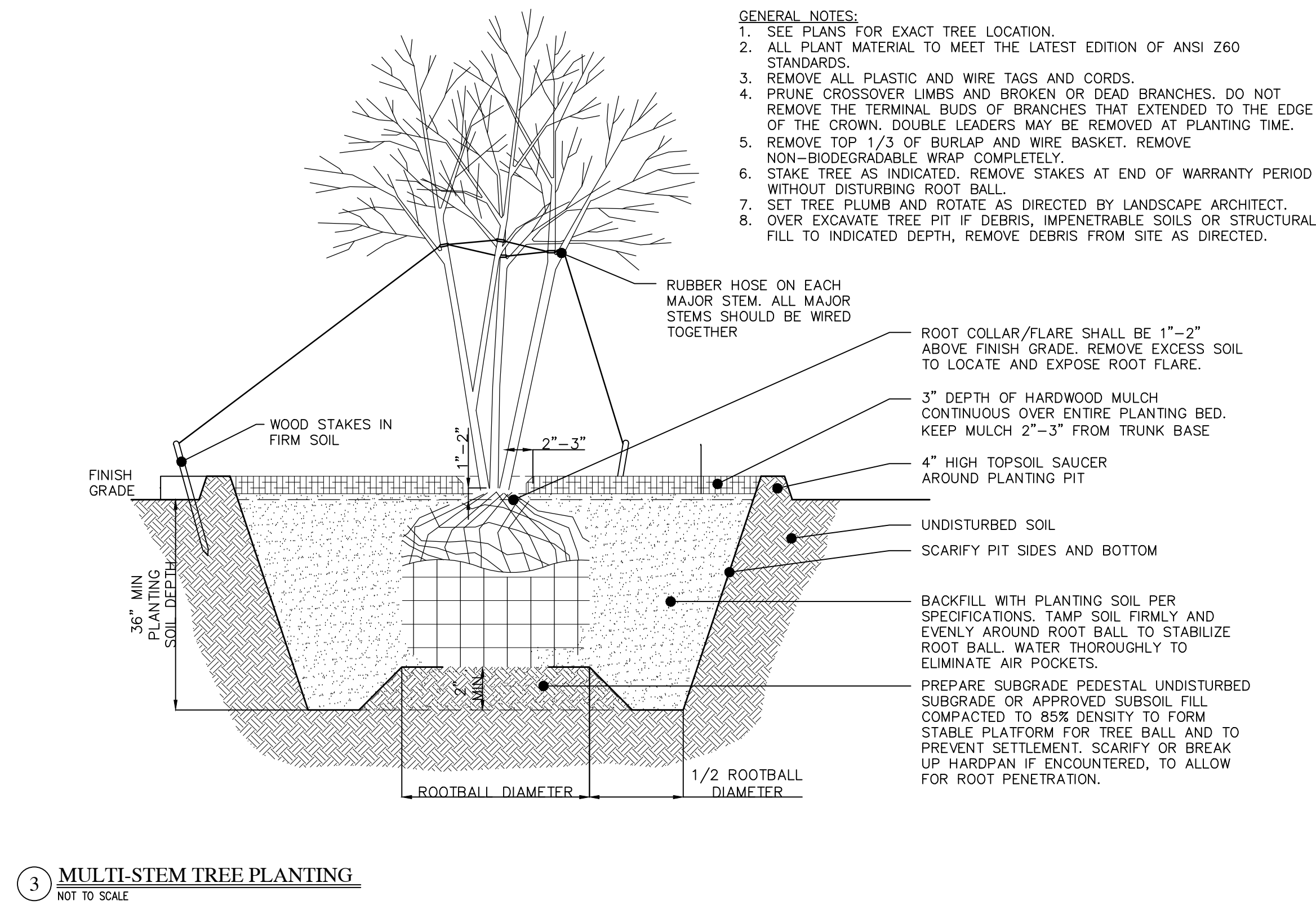
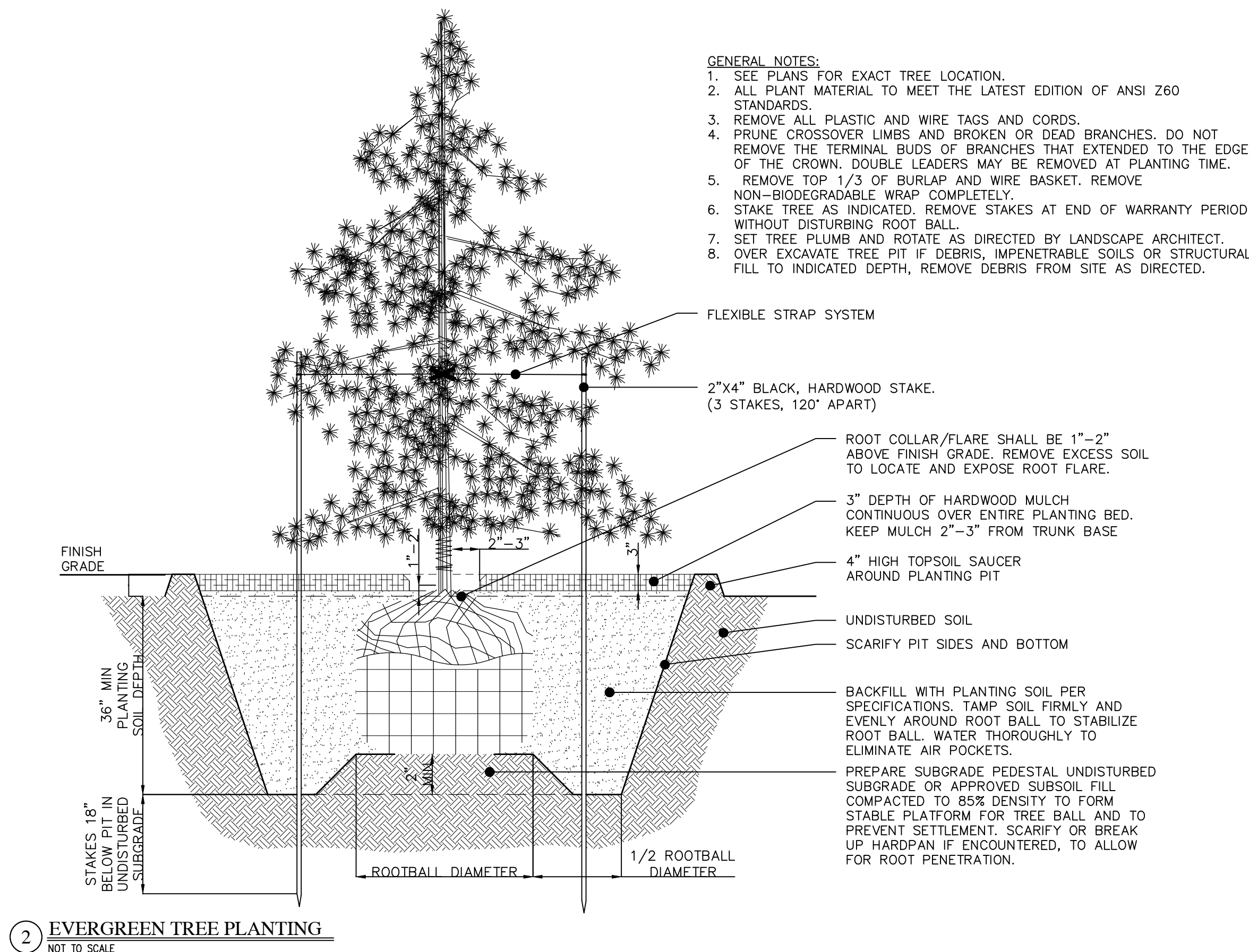
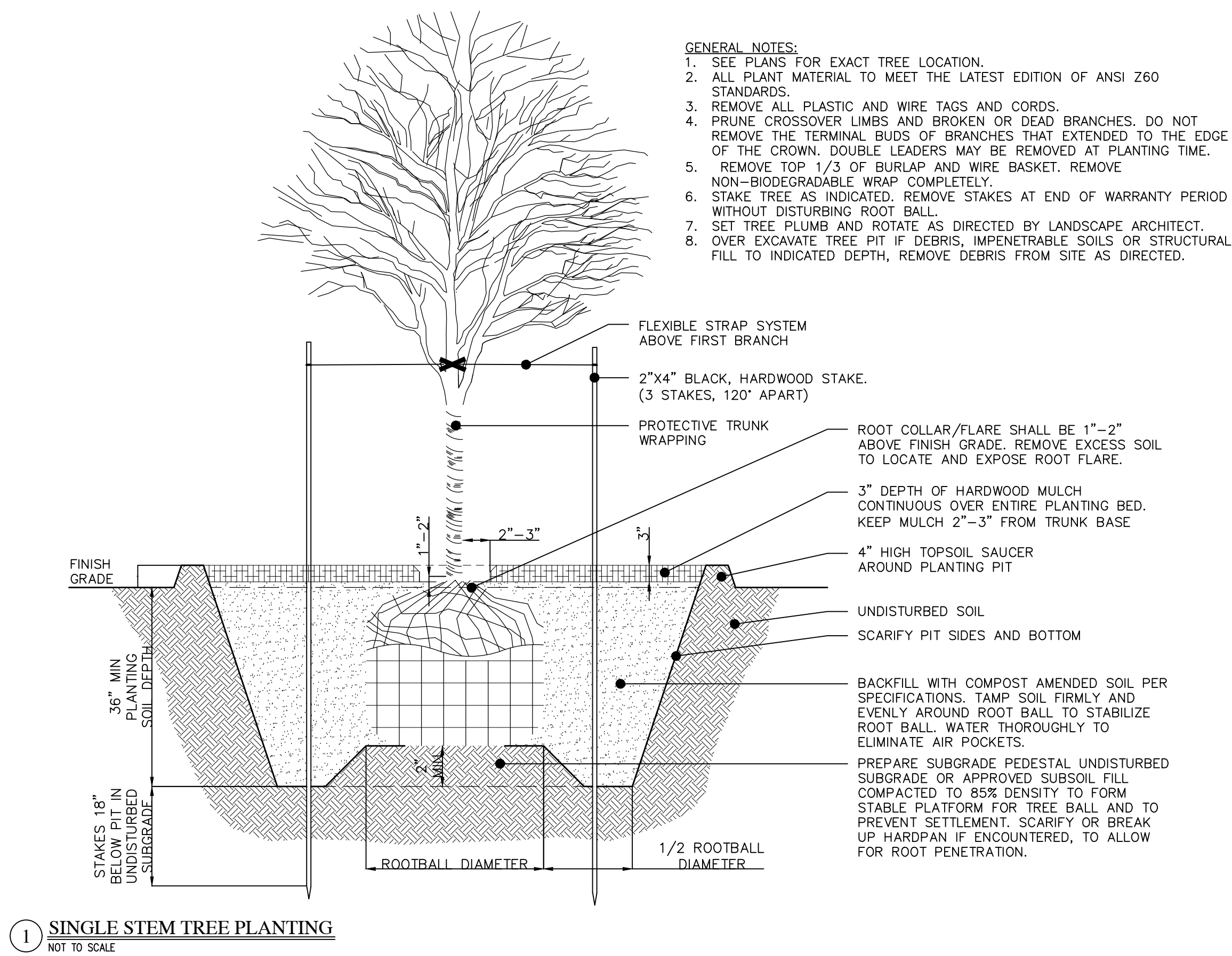

REVISIONS		

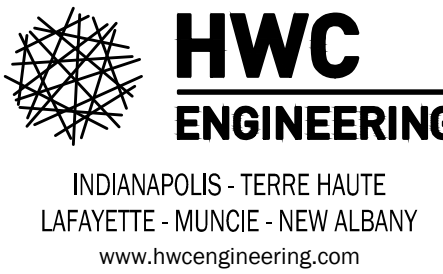

MCCORD POINTE SECTION 5
MCCORDSVILLE, INDIANA
LANDSCAPE DETAILS

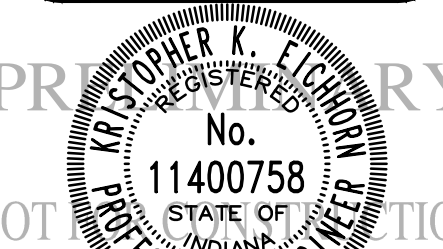

Christopher K. Eickhorn
No. 11400758
STATE OF INDIANA
PROFESSIONAL ENGINEER

DRAWN BY
GM/TS
CHECKED BY
KE
DATE
OCTOBER 25, 2019
SCALE
AS SHOWN
SHEET

JOB NUMBER
2019-003-A

L1.1
LANDSCAPE DETAILS