

- NOTES:
- Refer to tree protection specifications.
 - Contractor may submit alternate methods of tree protection to Landscape Architect for consideration.

TRENCHING/EXCAVATION

- ZONE A (CRITICAL ROOT ZONE)**
- NO DISTURBANCE ALLOWED without site-specific inspection and approval of methods to minimize root damage.
 - Severance of roots larger than 2" diameter requires Landscape Architect's approval.
 - Tunneling or boring required to install utilities 3'-0" below grade or deeper.
- ZONE B (DRIPLINE)**
- Operation of heavy equipment and/or stockpiling of materials subject to Landscape Architect's approval. Surface Protection* measures required.
 - Trenching allowed as follows:
 - Excavation by hand or with hand-driver trencher may be required.
 - Limit trench width. Do not disturb Zone A, maintain 2/3 or more of Zone B in undisturbed condition.
 - Tunneling or boring may be required for trenches deeper than 3'-0".

ZONE C (FEEDER ROOT ZONE)

- Operation of heavy equipment and/or stockpiling of materials subject to Landscape Architect's approval. Surface Protection* measures required.
- Trenching with heavy equipment allowed as follows:
 - Minimize trench width.
 - Maintain 2/3 or more of Zone C in undisturbed condition.

FENCING/ROOT PROTECTION

4' high vinyl protection fence at the greater of Zone B (Dripline) or to a radius (in feet) of 1.5x the caliper (in inches) of the tree, minimum, and at Zone C (Feeder Root Zone) if possible. Refer to Detail this Sheet.

Upon Landscape Architect's approval, a plywood box (8' minimum height) may be used where fencing cannot be achieved.

Landscape Architect's approval required for use/access within Zone B. Permission for use/access requires Surface Protection Measures for all unfenced, unpaved surfaces within Zone B.

*SURFACE PROTECTION MEASURES

- Mulch Layer, 6"-8" Depth
- ¾" Plywood
- Steel Plates

TREE PROTECTION GENERAL NOTES

- Underground utilities, if shown, are based on above ground indications and construction drawings. There is no guarantee that all underground utilities in service or abandoned are shown. Underground utilities are shown as accurately as possible but still may not be exact. No physical underground utility locations were made.
- Contractor to review all trees to be removed on site with Landscape Architect or Owner's Representative prior to demolition.
- Tree Protection Fencing locations are fixed. Install exactly where shown on these plans. Any adjustments to fencing locations must be approved by the Owner. Damages will be assessed if tree protection fence location is adjusted without Owner approval. Fence deviation from this plan or approved change will be corrected by the General Contractor prior to the start of construction.
- All tree pruning and limb restraint will be performed under the direct supervision of a Certified Arborist. Contractor shall not prune trees or restrain limbs.
- No staging, equipment, material storage, or vehicles are allowed on non-paved areas unless indicated otherwise on plan.
- Abandon all utilities to be removed when located within a Protected Root Zone.
- Backfill all depressed and void areas with top soil following removal of vegetation. Soil shall be free of debris. Compact soils to ensure settling and sedimentation do not occur.
- Owner is responsible for transplanting identified trees, as noted. Coordinate with Owner if trees to be transplanted remain on site when mobilization begins.
- Cleanly cut all roots encountered during construction. Contractor to Air-knife all roots around trees around all indicated as being essential to the campus landscape vocabulary and any tree over 18" in diameter.
- Coordinate locations of Tree Protection Fencing and Construction Fencing prior to the start of construction activities. In areas where Tree Protection and Construction Fences overlap, the Contractor may elect to install the more restrictive fence type of the two provided that the single fence accommodates the requirements of both fences.

TREE PRESERVATION LEGEND

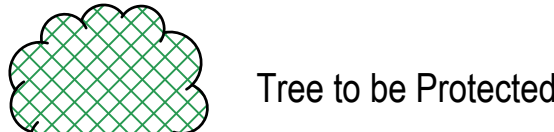

Tree to be Protected

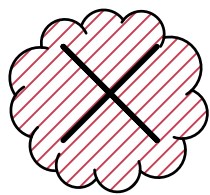

Tree to be Removed

TP TP Tree Protection Fence Locations -
To be installed PRIOR TO DEMOLITION.
Refer to Detail this sheet.
Protected Root Zone

Note: Coordinate tree protection within site with any utility work in the area. Provide temporary tree protection fencing along all trees for a min. of 50' from the edge of construction activities.

TREE PROTECTION
Not To Scale

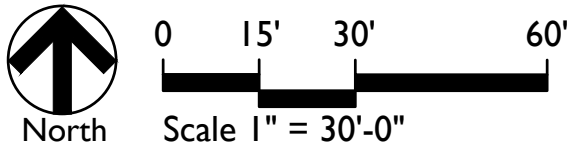

Revision	Date	Description

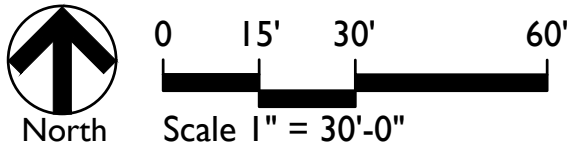
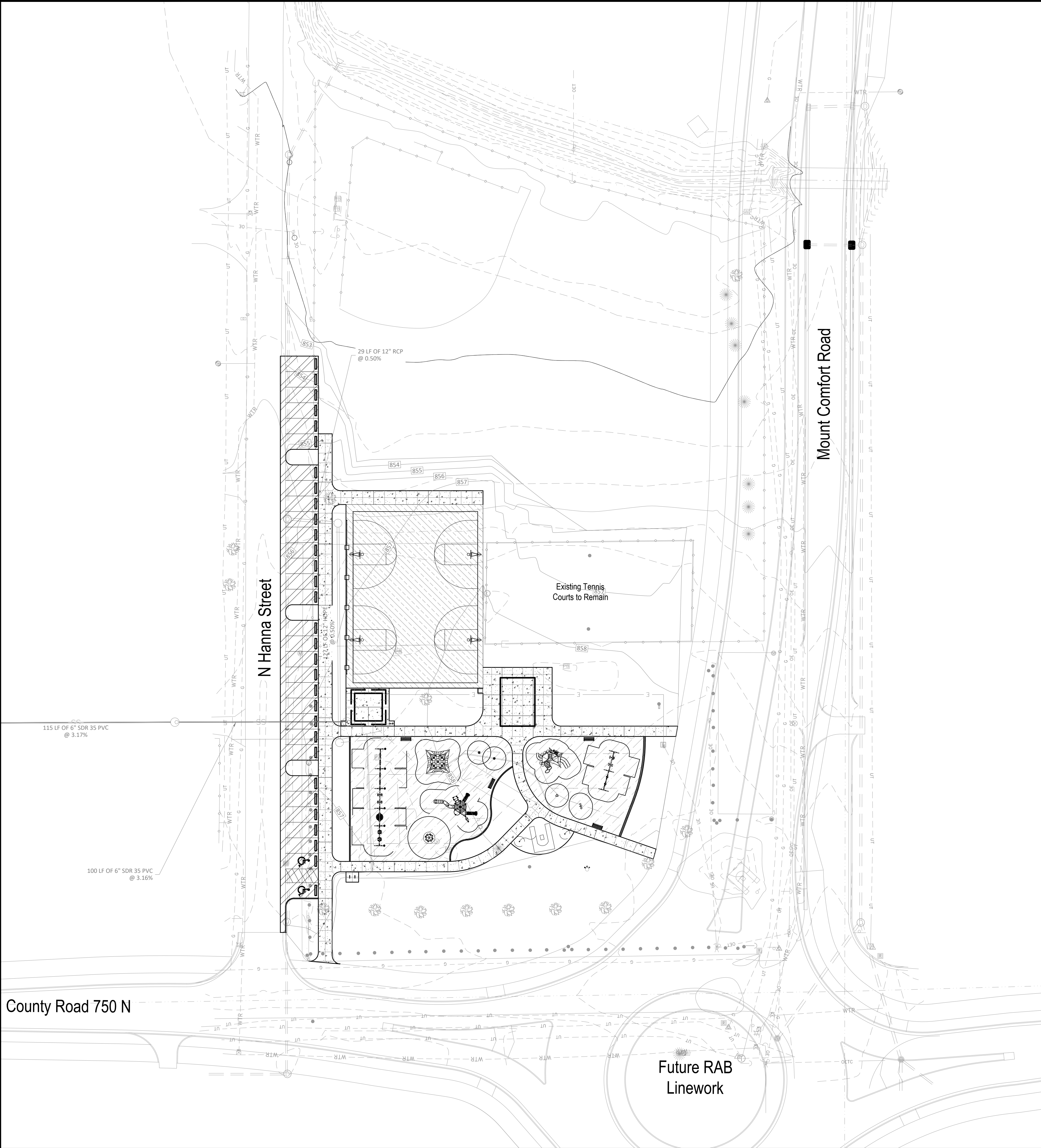

Revision	Date	Description

Date:	2024-03-08
Project No:	24-1727
Drawn by:	DC
Checked by:	LM

These Drawings and Specifications, and all copies thereof are and shall remain the property and copyright of the Landscape Architect. They shall be used only with respect to this Project and are not to be used on any other Project or Work without prior written permission from the Landscape Architect.

Sheet No:
L100

TAC SUBMITTAL
OLD SCHOOL PARK - PHASE I
McCordsville, Indiana
Overall Plan



Certified by:

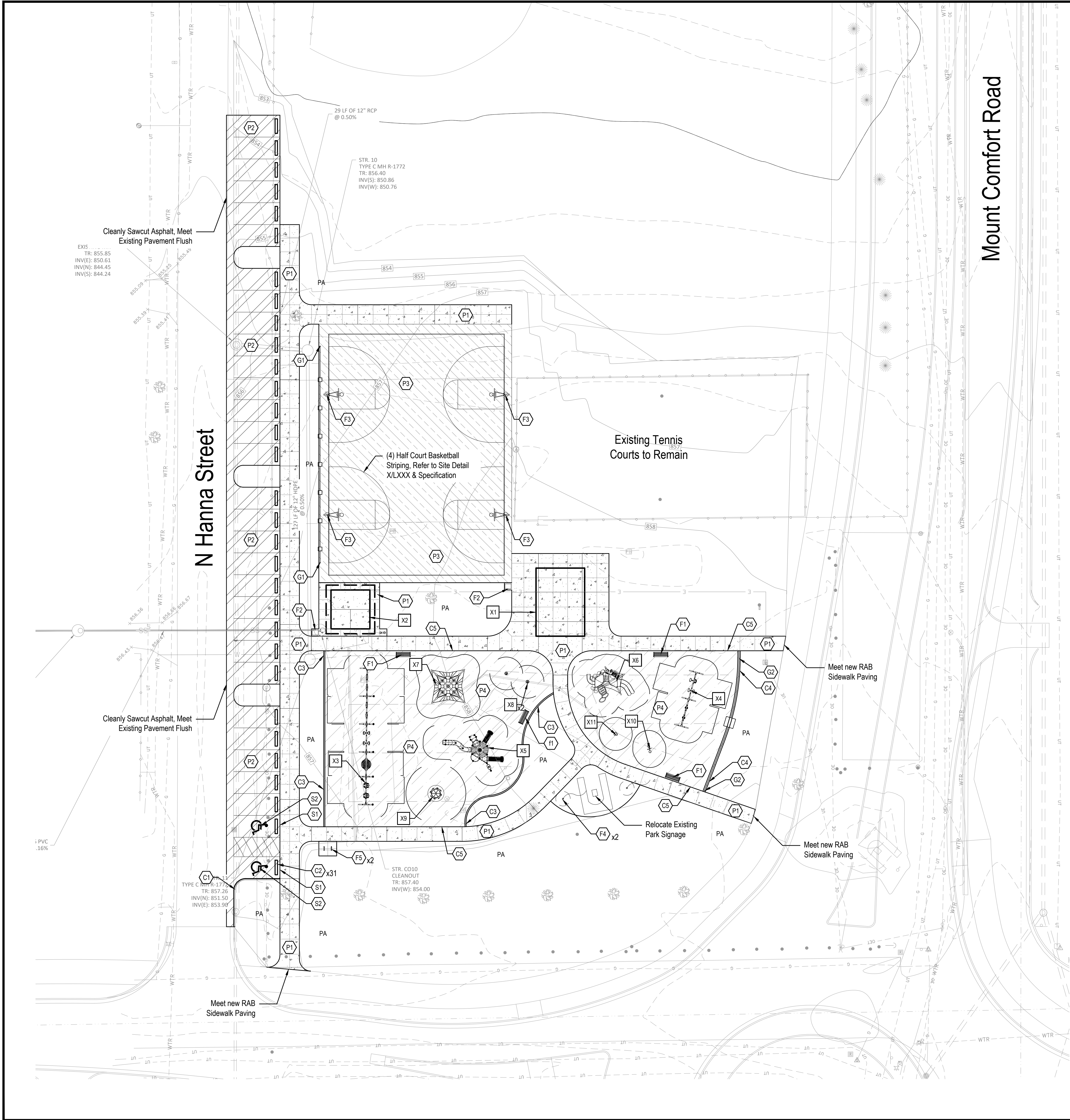

PLAYGROUND FEATURES - Specification 11 68 11	
KEY	DESCRIPTION / REFERENCE
X1	SHELTER
X2	RESTROOM BUILDING
X3	SWING A
X4	SWING B
X5	COMPOSITE A
X6	COMPOSITE B
X7	ECLIPSE CLIMBER
X8	SPINNER BOWL
X9	WHIRLYQ SPINNER
X10	DOUBLE BOBBLE
X11	SPINNER PLATE

PLANTING	
KEY	DESCRIPTION / REFERENCE
PA	PLANTED AREA

CURBS - Specification 03 30 01	
KEY	DESCRIPTION / REFERENCE
C1	CONCRETE POST CURB REFER TO DETAIL 4/L600 &
C2	WHEEL STOP REFER TO DETAIL 5/L600 &
C3	CURB, 6" PLAYGROUND REFER TO DETAIL 4/L602 &
C4	PLAYGROUND PERIMETER NAILER CURB WITH EMBEDDED FENCE
C5	INTEGRAL CONCRETE CURB AND WALK TURN DOWN PLAYGROUND EDGE REFER TO DETAIL 3/L602

PAVEMENT	
KEY	DESCRIPTION / REFERENCE
P1	STANDARD CONCRETE PAVEMENT REFER TO SITE DETAIL 1.2/L600 & SPECIFICATION 32 13 16
P2	HEAVY DUTY ASPHALT PAVEMENT REFER TO SITE DETAIL 3/L600 & SPECIFICATION 32 12 16
P3	ASPHALT PAVEMENT REFER TO SITE DETAIL 7/L600 & SPECIFICATION 32 12 16
P4	PLAYSURFACE, POURED IN PLACE REFER TO SITE DETAIL 1.2/L602 & SPECIFICATION XX

SIGNAGE	
KEY	DESCRIPTION / REFERENCE
S1	ADA ACCESSIBLE PARKING SIGN REFER TO SITE DETAIL 2/L600
S2	ACCESSIBLE PARKING STRIPING & SYMBOL REFER TO SITE DETAIL 1/L600

SITE FURNISHINGS - Specification 32 33 00	
KEY	DESCRIPTION / REFERENCE
F1	BENCH, KOMPA SPECIFICATION 32 33 00
F2	TRASH RECEPTACLE SPECIFICATION 32 33 00
F3	BASKETBALL GOAL, ADJUSTABLE HEIGHT REFER TO SPECIFICATION 32 33 00
F4	FLAG POLE REFER TO SITE DETAIL 6/L600 & SPECIFICATION 32 33 00
F5	BIKE RACK REFER TO SITE DETAIL 4/L601 & SPECIFICATION 32 33 00

GATES & FENCING - Specification 32 31 13	
KEY	DESCRIPTION / REFERENCE
G1	12' HT. CHAIN LINK FENCE, BLACK VINYL COATED
G2	4' ORNAMENTAL FENCE REFER TO SITE DETAIL 5/L601



5825 Lawton Loop E. Dr. | Indianapolis, IN 46216
317-485-6900 | www.context-design.com

Certified by:



TAC SUBMITTAL
OLD SCHOOL PARK - PHASE I
McCordsville, Indiana
Materials Plan

Revision	Date	Description

Date: 2024-03-08
Project No: 24-1727
Drawn by: DC
Checked by: LM

These Drawings and Specifications, and all copies thereof are and shall remain the property and copyright of the Landscape Architect. They shall be used only with respect to this Project and are not to be used on any other Project or Work without prior written permission from the Landscape Architect.

Sheet No:
L101

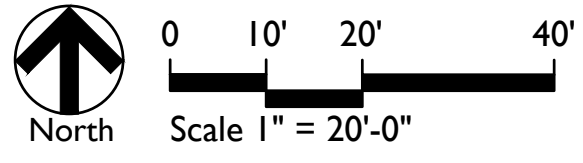

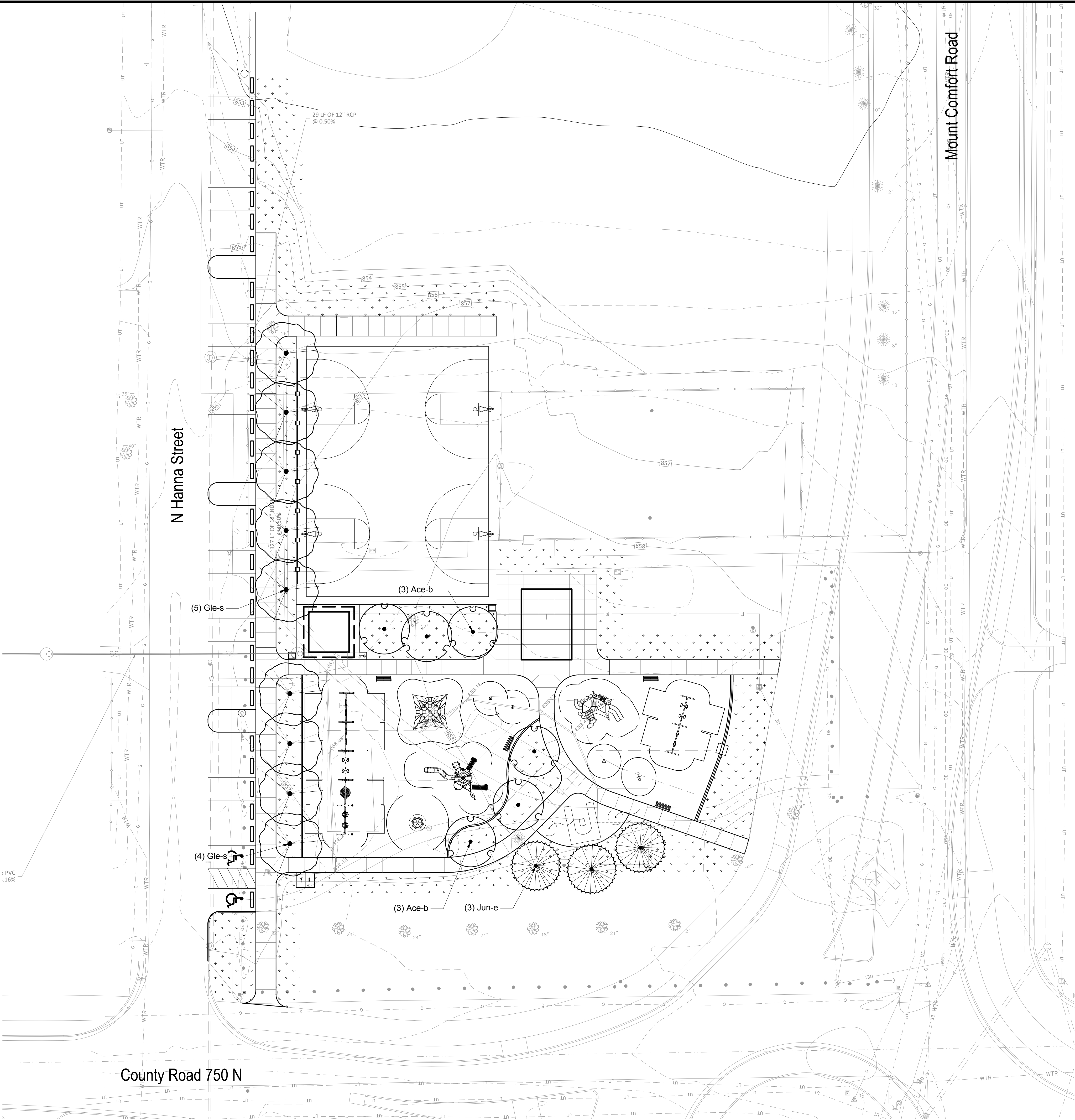

GENERAL LANDSCAPE AND PLANTING NOTES

- Refer to Project Manual for Planting Specifications and Topsoil requirements. Refer to Plant Schedule and Planting Details for additional information.
- All materials are subject to the approval of the Landscape Architect and Owner at any time. Landscape Architect to inspect all plant locations and plant bed conditions prior to installation. On-site adjustments may be required.
- Rootballs shall meet or exceed size standards as set forth in 'American Standards for Nursery Stock'. MAIN LEADERS OF ALL TREES SHALL REMAIN INTACT.
- Remove from the site any plant material that turns brown or defoliates within five (5) days after planting. Replace immediately with approved, specified material.
- Plant counts indicated on drawings are for Landscape Architect's use only. Contractor shall make own plant quantity takeoffs using drawings, specifications, and plant schedule requirements (i.e., spacing), unless otherwise directed by Landscape Architect. Contractor to verify bed measurements and install appropriate quantities as governed by plant spacing per schedule. Plant material quantities shown on plan are minimum quantities. Additional material may be needed to meet spacing requirements and field conditions.
- Seed all areas disturbed by construction activities that are not otherwise noted to receive pavement, planting bed, or sod treatment.
- The Contractor shall install and/or amend topsoil in all proposed bed areas to meet Specifications. Contractor shall coordinate quantity and placement of topsoil. Landscaper shall verify depth of topsoil prior to plant installation. (Refer to specifications for topsoil source and placement requirements)
- All tree locations shall be marked with 2x2" stakes prior to planting for review and approval by the Landscape Architect. Any plant material installed in an incorrect location, by the judgment of the Landscape Architect, shall be reinstalled at the Contractor's expense.
- All plant beds shall receive 3" minimum of shredded hardwood bark mulch (unless otherwise noted).
- Verify all utility locations in the field prior to beginning work. Repair all damaged utilities to Owner's satisfaction at no additional cost.
- The Contractor shall maintain all plant material and lawns until the project is fully accepted by the Landscape Architect, unless otherwise noted.
- All workmanship and materials shall be guaranteed by the Contractor for a period of one calendar year after Final Acceptance.
- Install all plant material in accordance with all local codes and ordinances. Coordinate with the Owner to obtain any required permits necessary to complete work.
- Contractor shall test all tree pits for drainage. Any tree pit that holds water for more than 24 hours shall be installed using tree pit drainage.
- Tree Protection Fencing is the responsibility of the Contractor. Minimum protected area shall include the full drip line of the canopy. NO construction activities, material storage, etc. may occur within that area. The Contractor shall ensure that no soil compaction or tree damage occurs in any Protected areas, at any time during the construction process.
- Trees shall be matched in groups unless otherwise noted.



TAC SUBMITTAL
OLD SCHOOL PARK - PHASE I
McCordsville, Indiana
Planting Plan

Revision	Date	Description

Date: 2024-03-08
Project No: 24-1727
Drawn by: DC
Checked by: LM

These Drawings and Specifications, and all copies thereof are and shall remain the property and copyright of the Landscape Architect. They shall be used only with respect to this Project and are not to be used on any other Project or Work without prior written permission from the Landscape Architect.

Sheet No:
L401

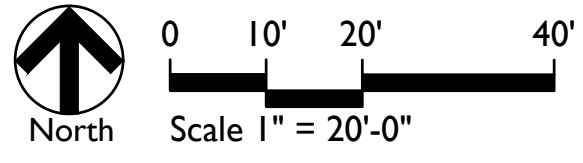

PLANT SCHEDULE

CODE	QTY	BOTANICAL NAME	COMMON NAME	CONT	CAL	REMARKS
EVERGREEN TREES						
Jun-e	3	Juniperus virginiana	Eastern Red Cedar	B & B	min. 6` ht.	full, strong central leader, matched, symmetrical
DECIDUOUS TREES						
Ace-b	6	Acer x freemanii `Autumn Blaze`	Autumn Blaze Maple	B & B	2"Cal	full, strong central leader, matched
Gle-s	9	Gleditsia triacanthos inermis `Shademaster`	Shademaster Thornless Honeylocust	B & B	2"Cal	full, strong central leader, matched

5 GROUND COVER

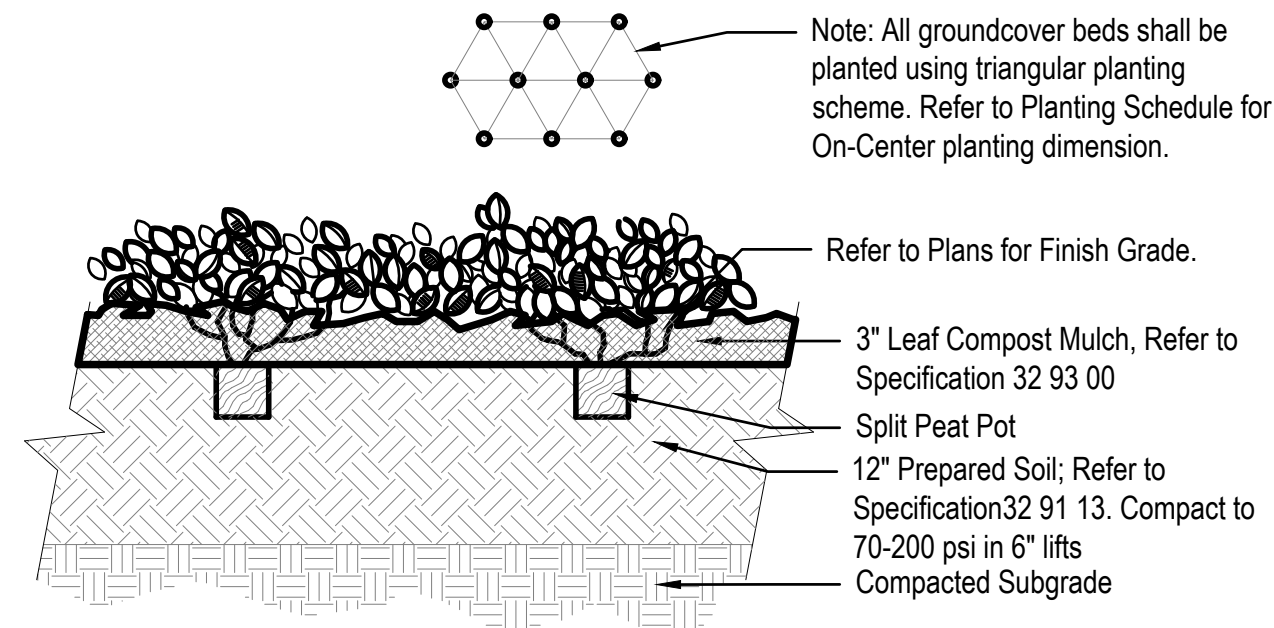

3 SHRUB

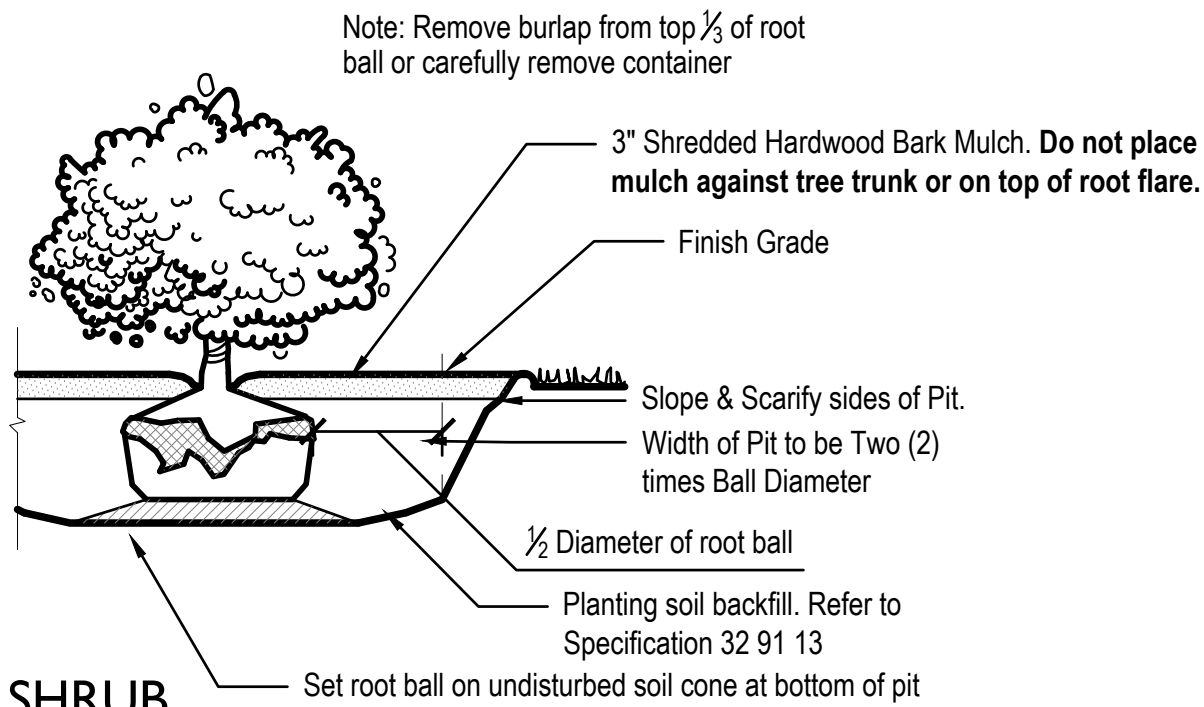

4 MULTI-STEM TREE

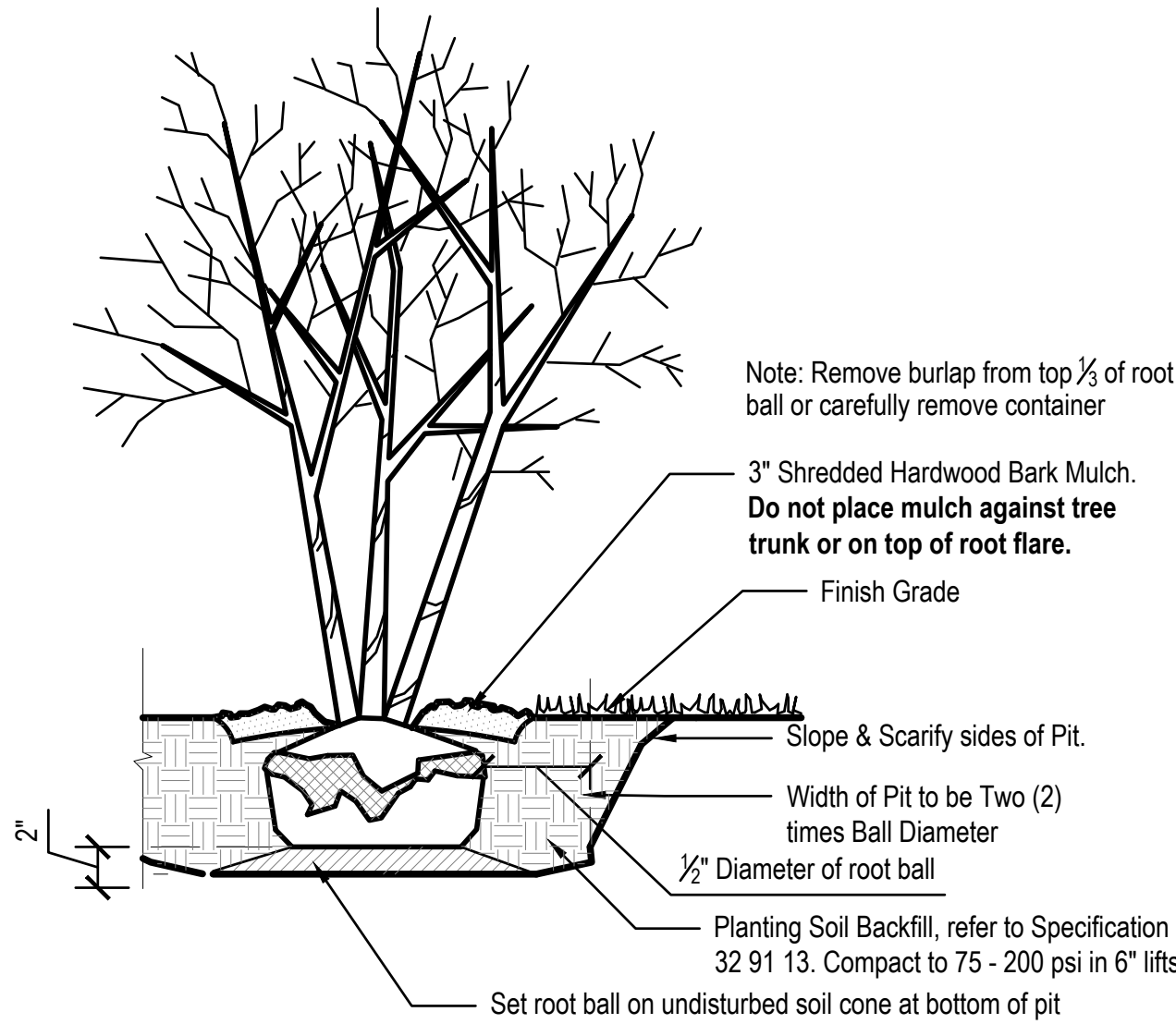

1 DECIDUOUS TREE

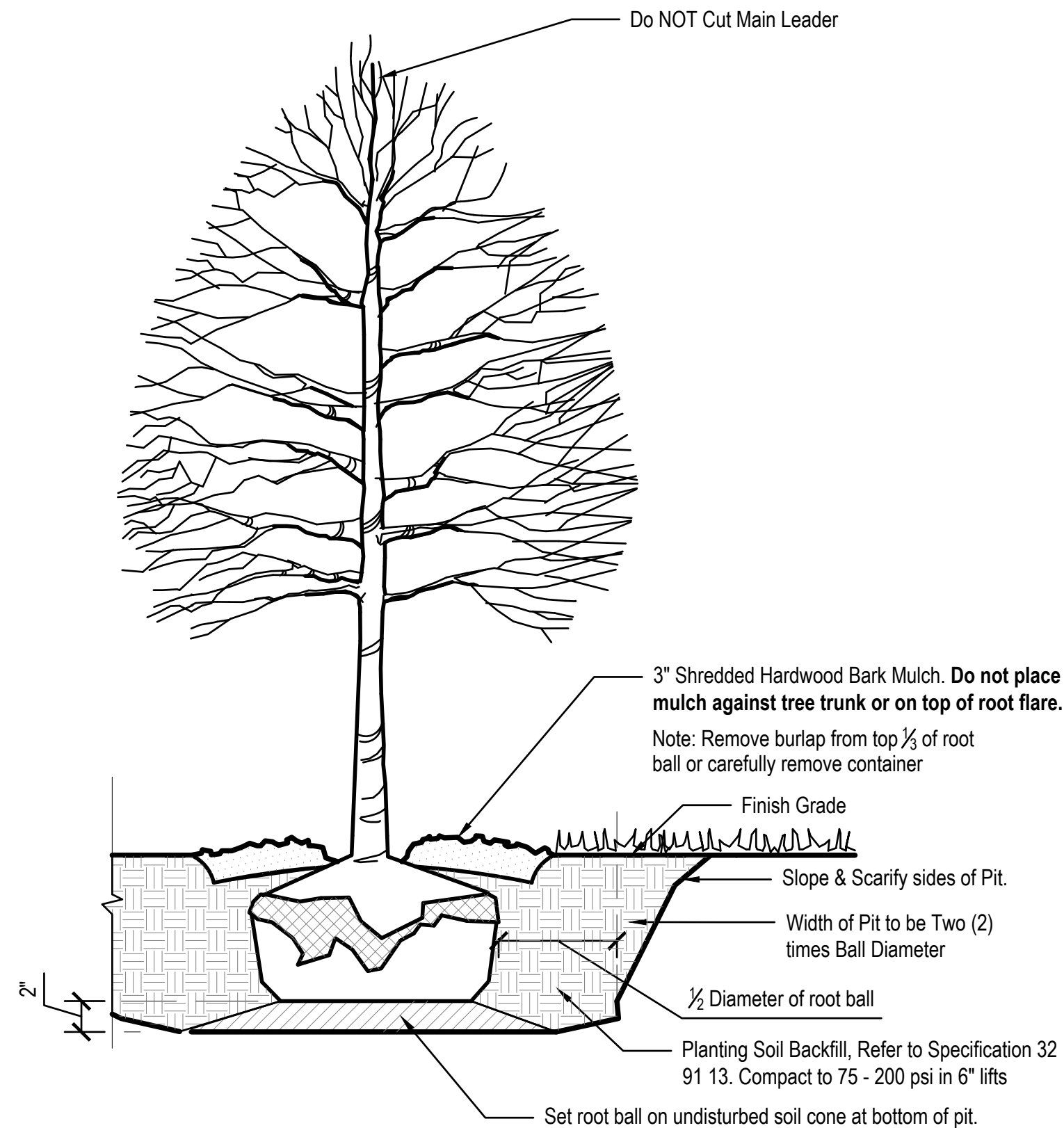

2 EVERGREEN TREE

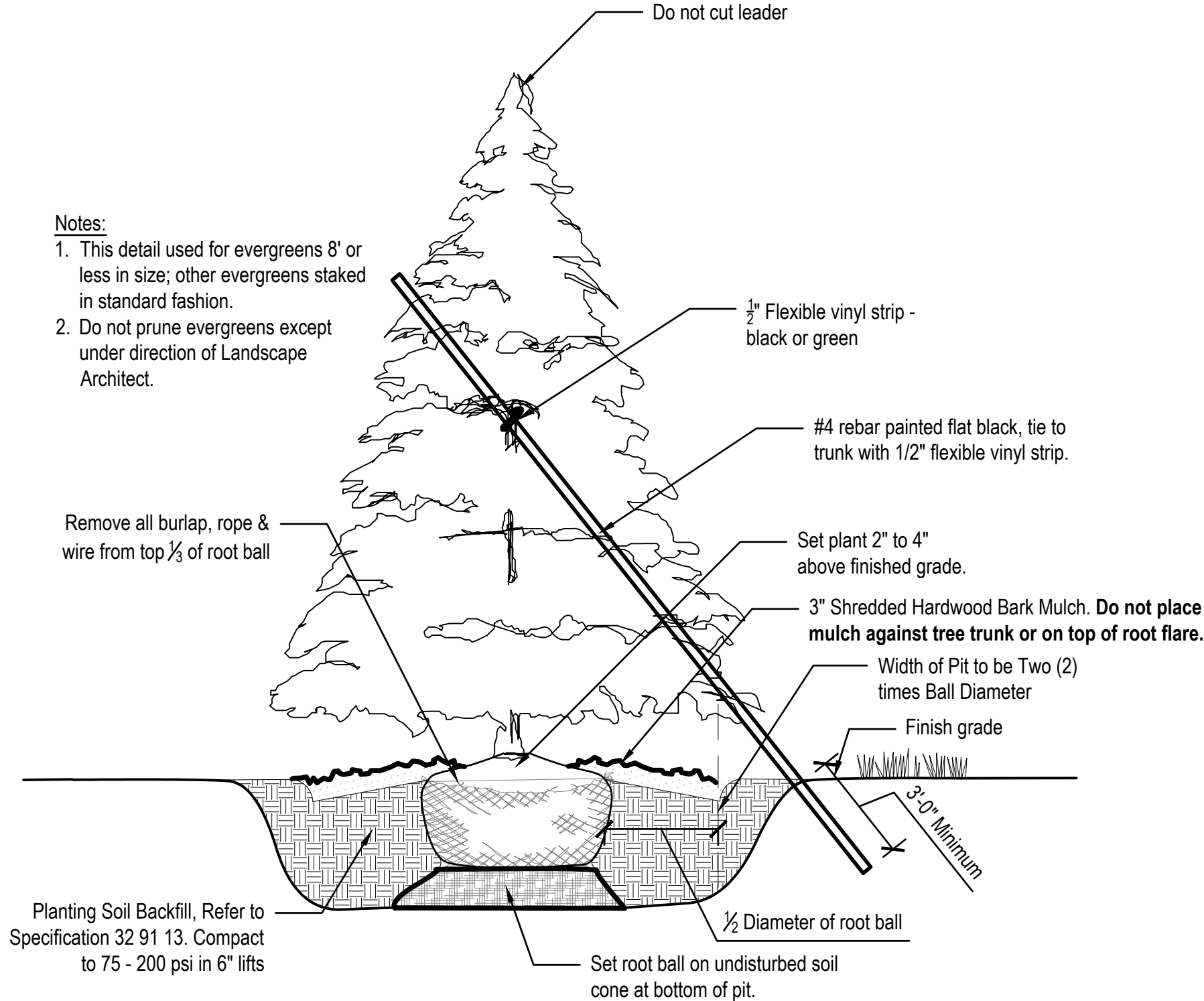

Certified by:



TAC SUBMITTAL

OLD SCHOOL PARK - PHASE I

McCordsville, Indiana

Site Details

Revision	Date	Description

Date: 2024-03-08
Project No: 24-1727
Drawn by: DC
Checked by: LM

These Drawings and Specifications, and all copies thereof are and shall remain the property and copyright of the Landscape Architect. They shall be used only with respect to this Project and are not to be used on any other Project or Work without prior written permission from the Landscape Architect.

Sheet No:

L600

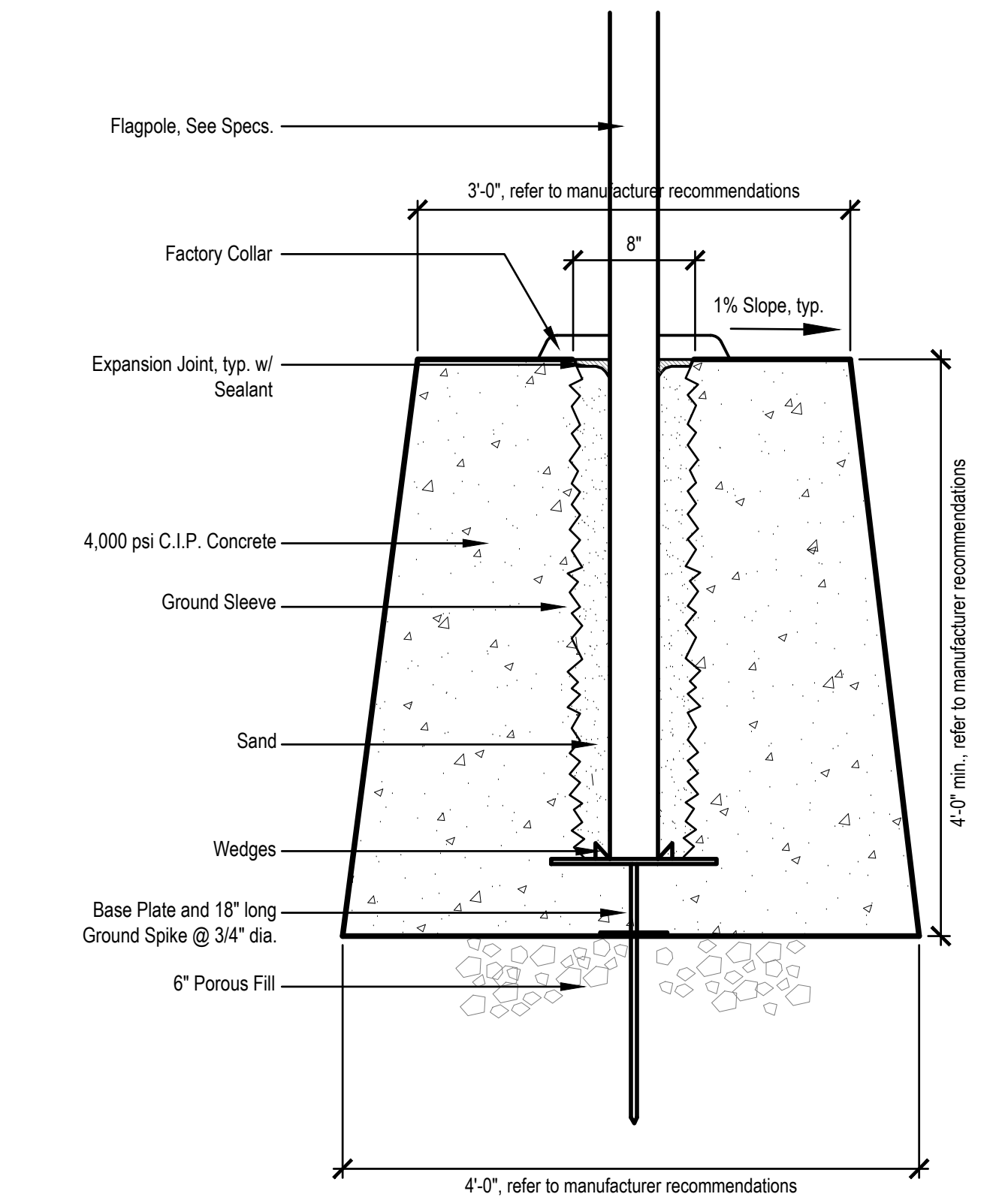

6 **PROTOTYPICAL FLAGPOLE FOOTING**
Scale: 1" = 1'-0"

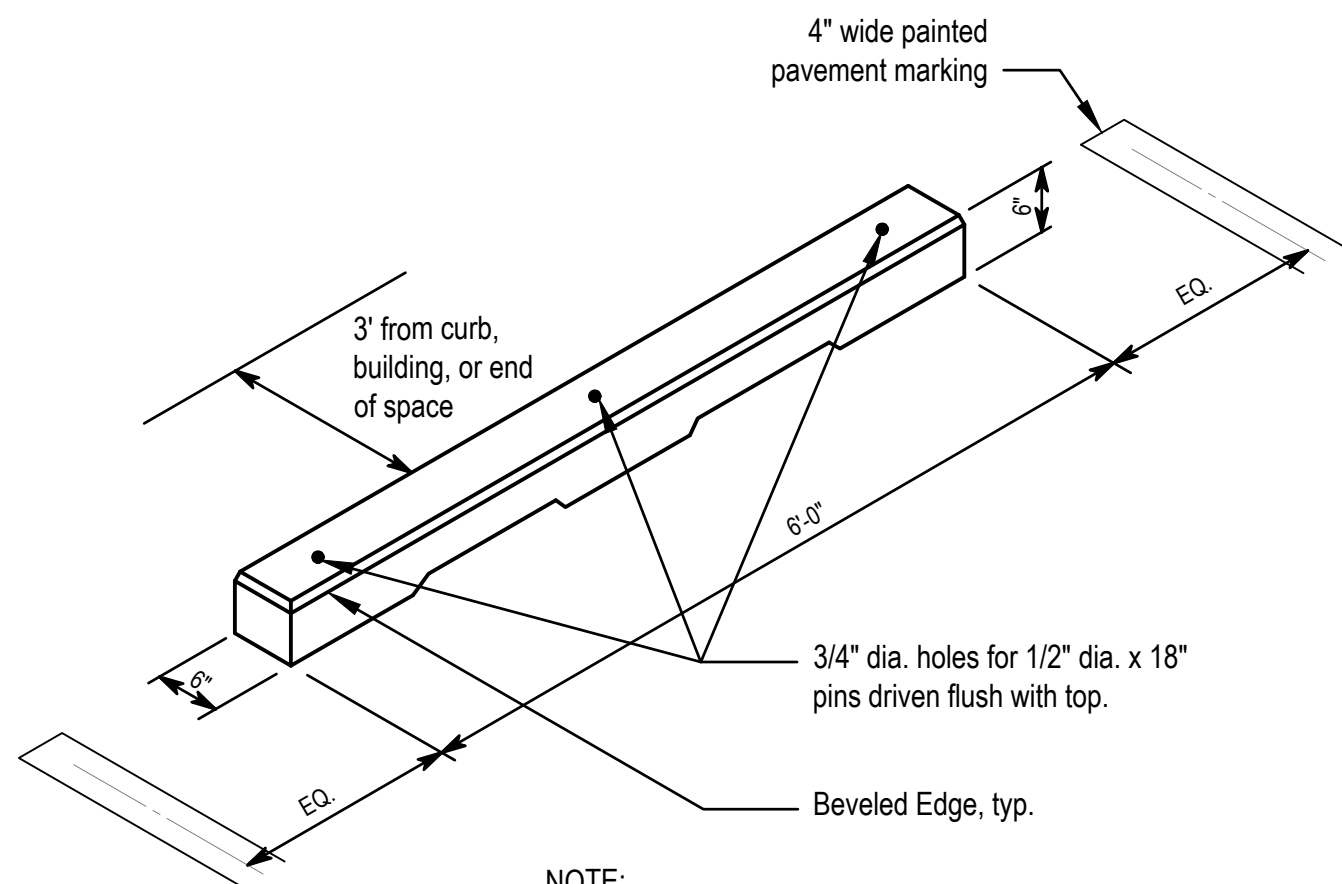

NOTE:
Dimensions indicated are minimums.
Manufacturer's standards in excess are acceptable.
Precast concrete OR recycled HDPE may be provided at Contractor's option.

5 **WHEEL STOP**
Not to Scale

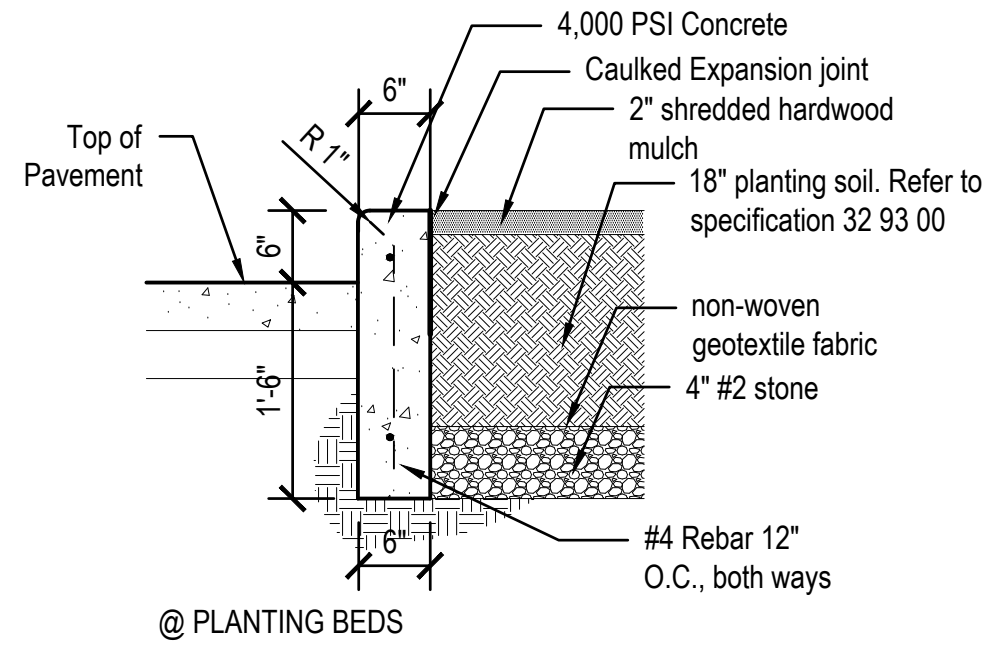

@ PLANTING BEDS

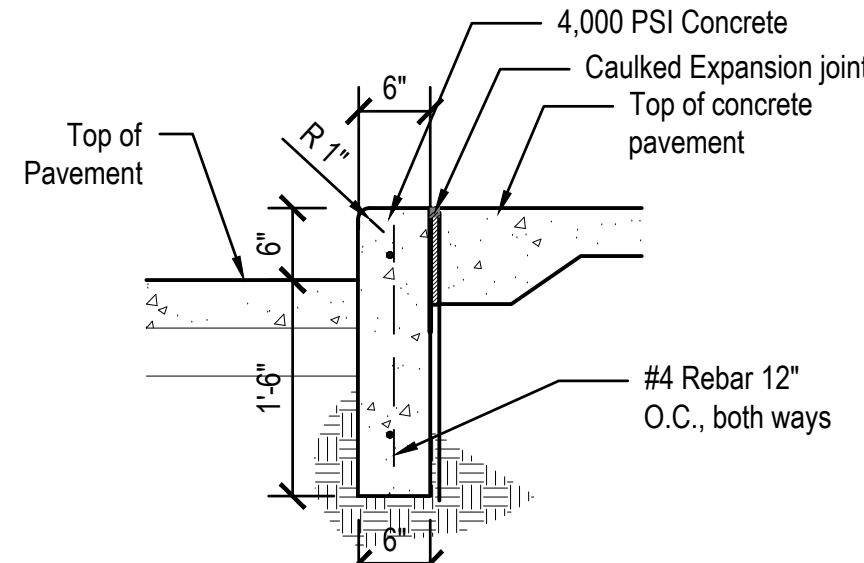

@ PARKING LOT EDGE

NOTES:
1. Curb shall have 1/2" expansion joints at 40'-0" max, control joints at 8'-0" max. unless otherwise noted. See Plans for jointing layout.
2. Control joints shall be cut 1/4 depth of total thickness of slab.

4 **CURB, POST**
Scale: 3/4" = 1'-0"

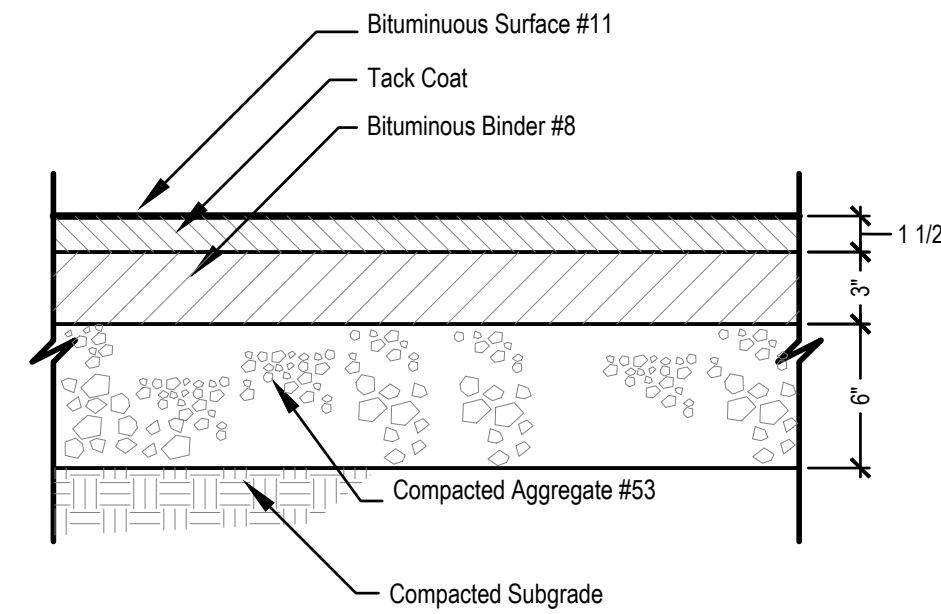

3 **STANDARD ASPHALT PAVEMENT (Parking)**
Not to Scale

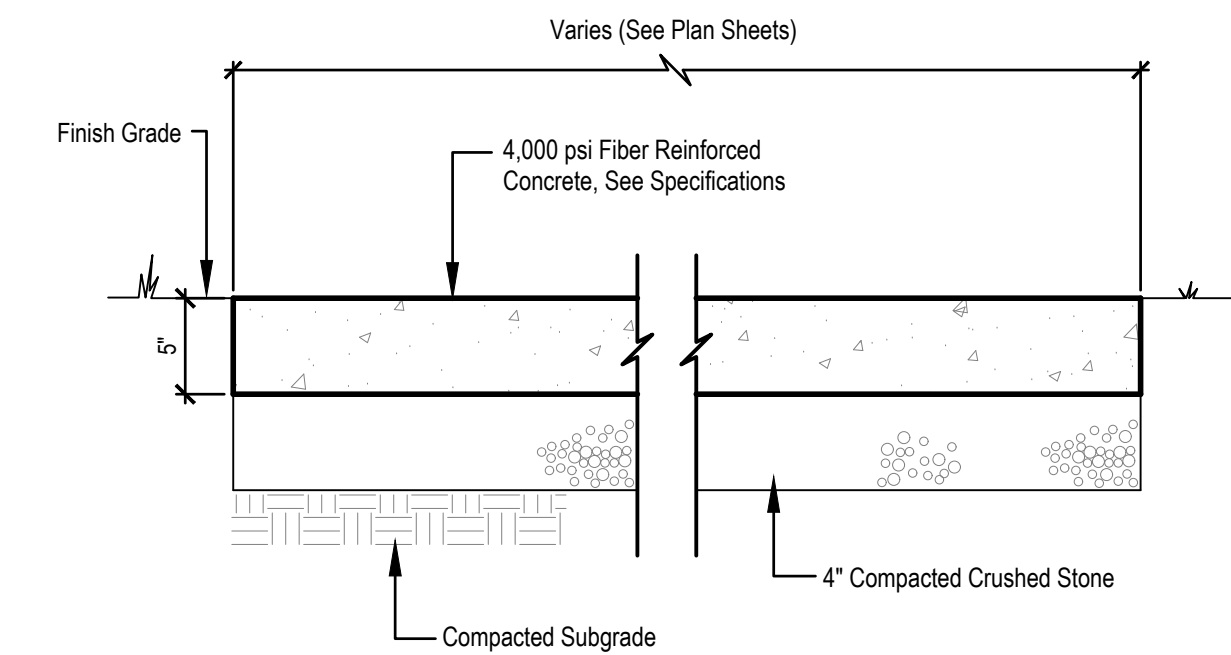

NOTES:
1. Control joints, expansion joints and edges of sidewalks indicated as hand-tooled shall be dressed after each finishing operation.
2. Provide expansion joints at intersection with another sidewalk, between walks and building slabs, and at other points as indicated on the drawings.
3. Refer to plan drawings for locations of control and expansion joints.

2 **STANDARD CONCRETE PAVEMENT**
Not to scale

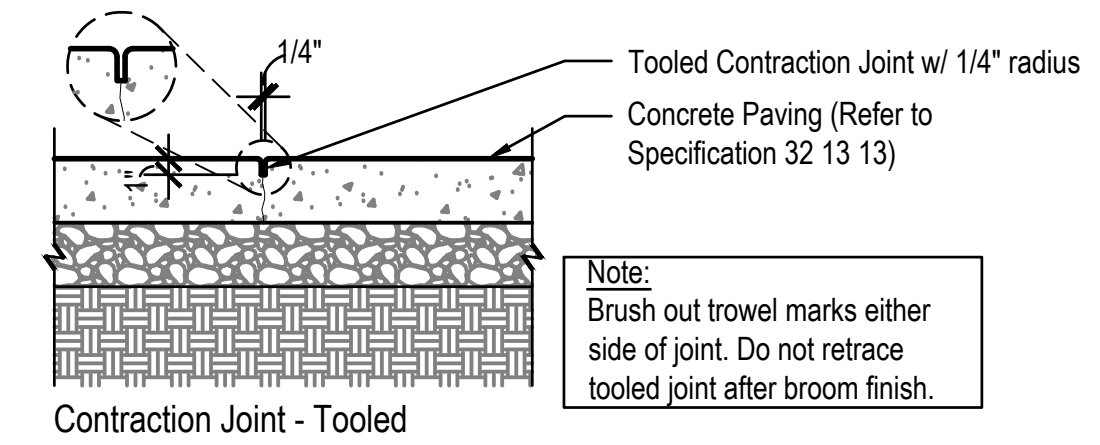

Contraction Joint - Tooled

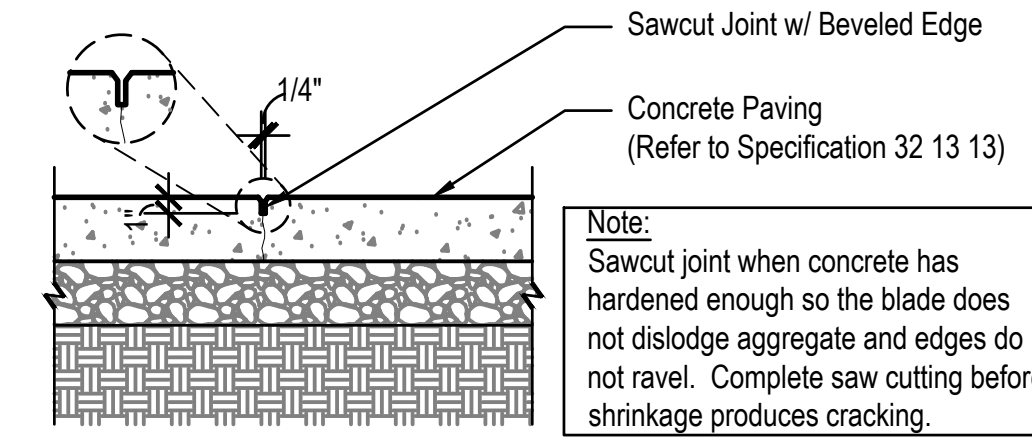

Contraction Joint - Double Sawcut

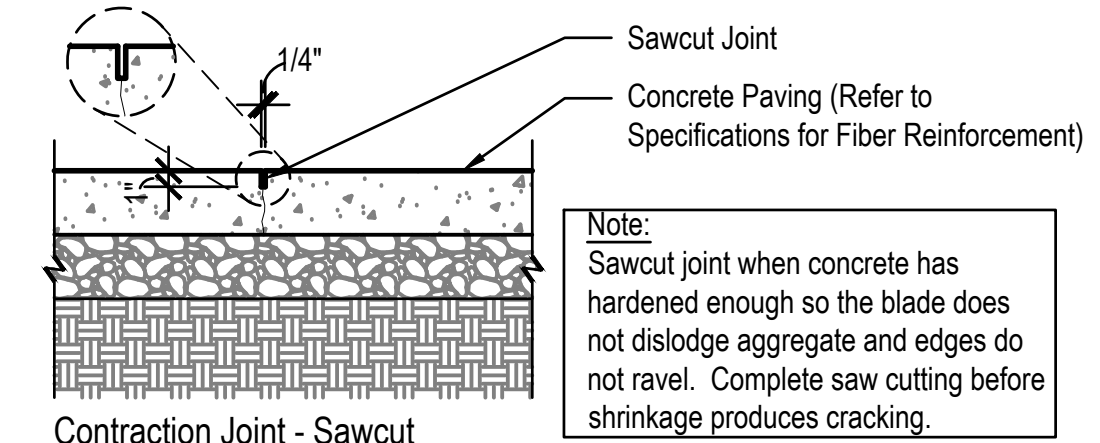

Contraction Joint - Sawcut

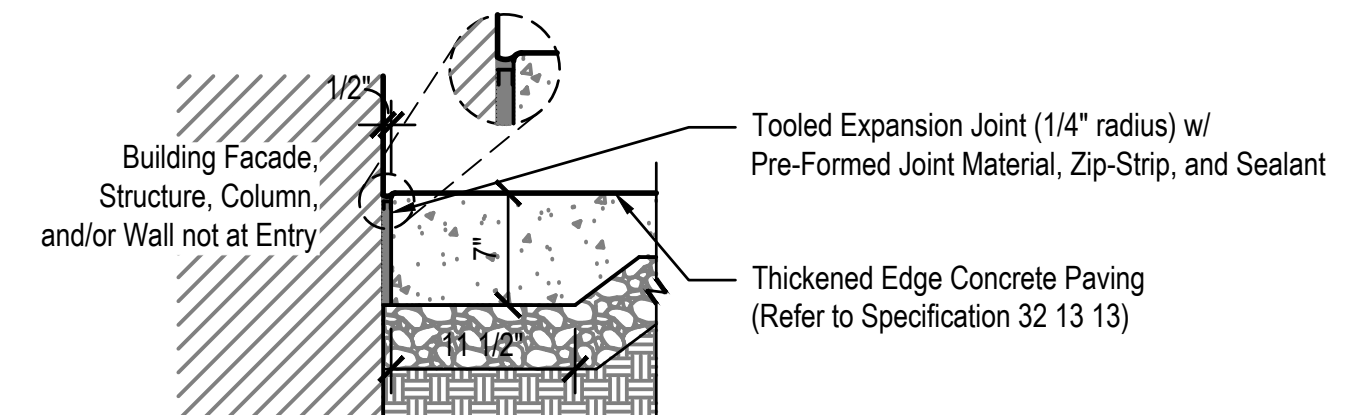

Expansion Joint @ Vertical Construction (Not @ Building Entry)

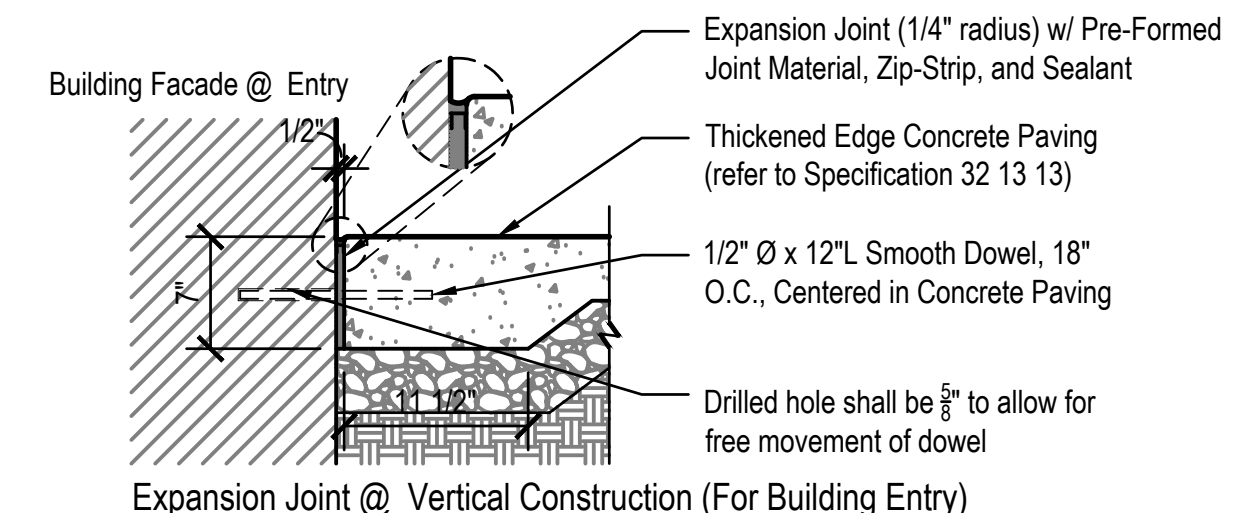

Expansion Joint @ Vertical Construction (For Building Entry)

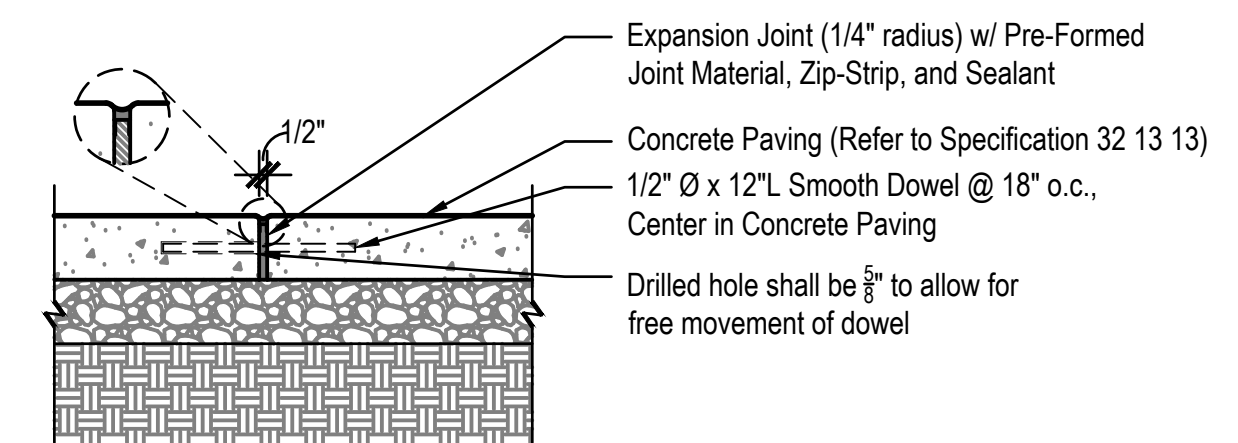

Expansion Joint @ Paving Slab

1 **CONCRETE JOINTING**
Scale: 1" = 1'-0"

Revision	Date	Description

Date: 2024-03-08
Project No: 24-1727
Drawn by: DC
Checked by: LM

These Drawings and Specifications, and all copies thereof are and shall remain the property and copyright of the Landscape Architect. They shall be used only with respect to this Project and are not to be used on any other Project or Work without prior written permission from the Landscape Architect.

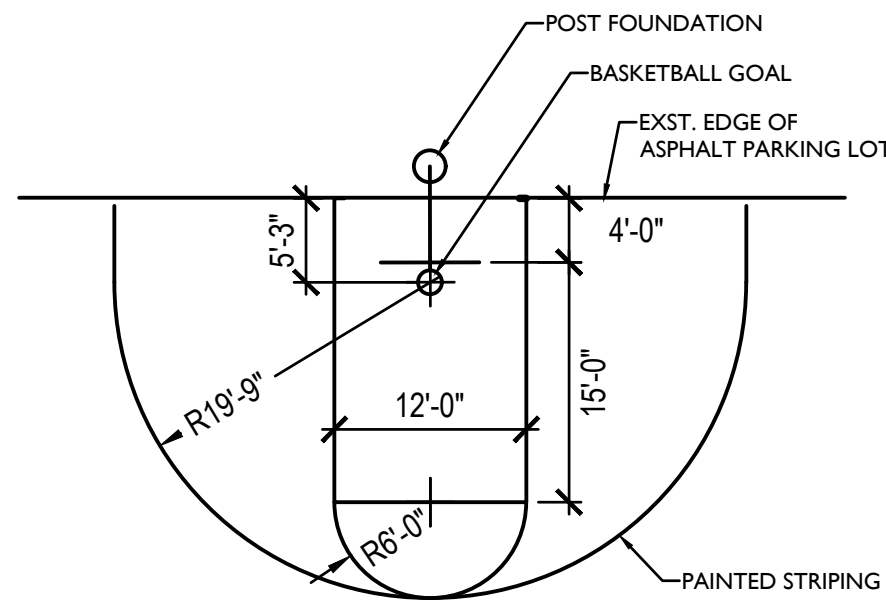

5 HALF COURT BASKETBALL
Not to scale

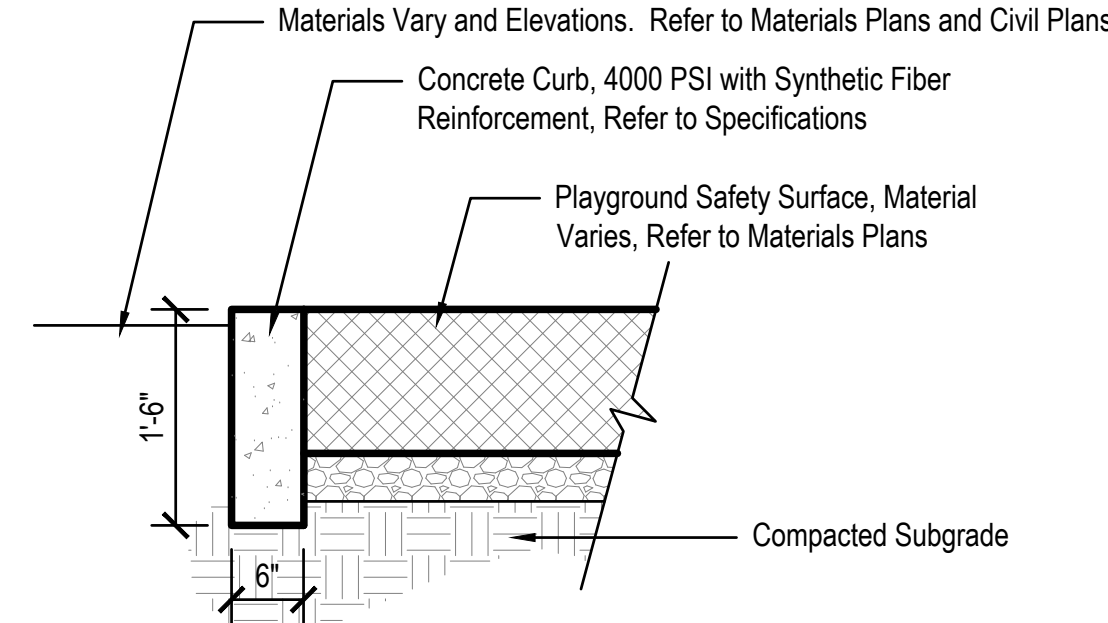

4 CURB, 6" PLAYGROUND
Scale: 3/4" = 1'-0"

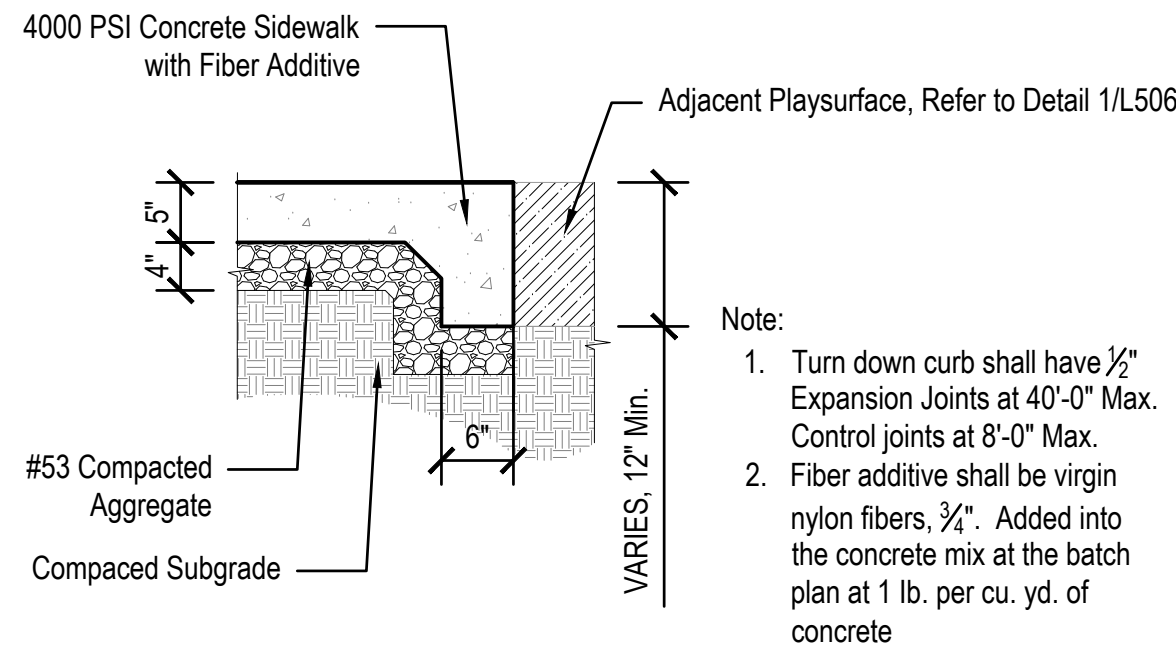

3 CURB, SIDEWALK TURNDOWN AT PLAYGROUND
Scale: 3/4" = 1'-0"

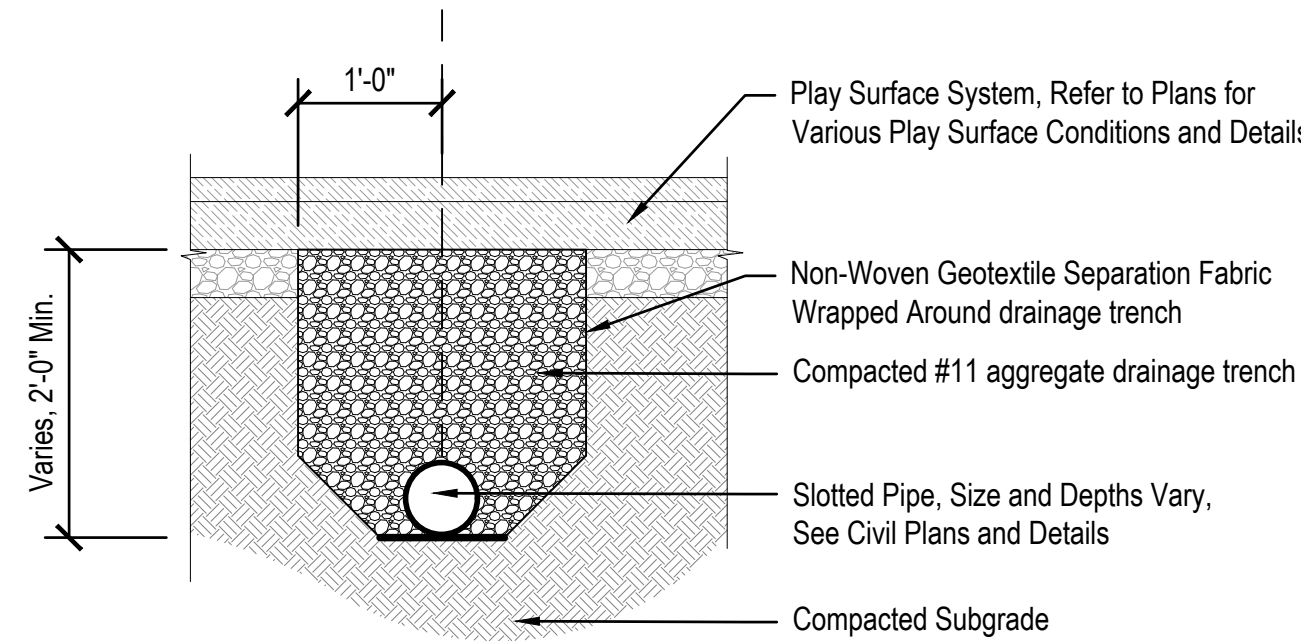

2 PLAYSURFACE, UNDERDRAIN
Scale: 3/4" = 1'-0"

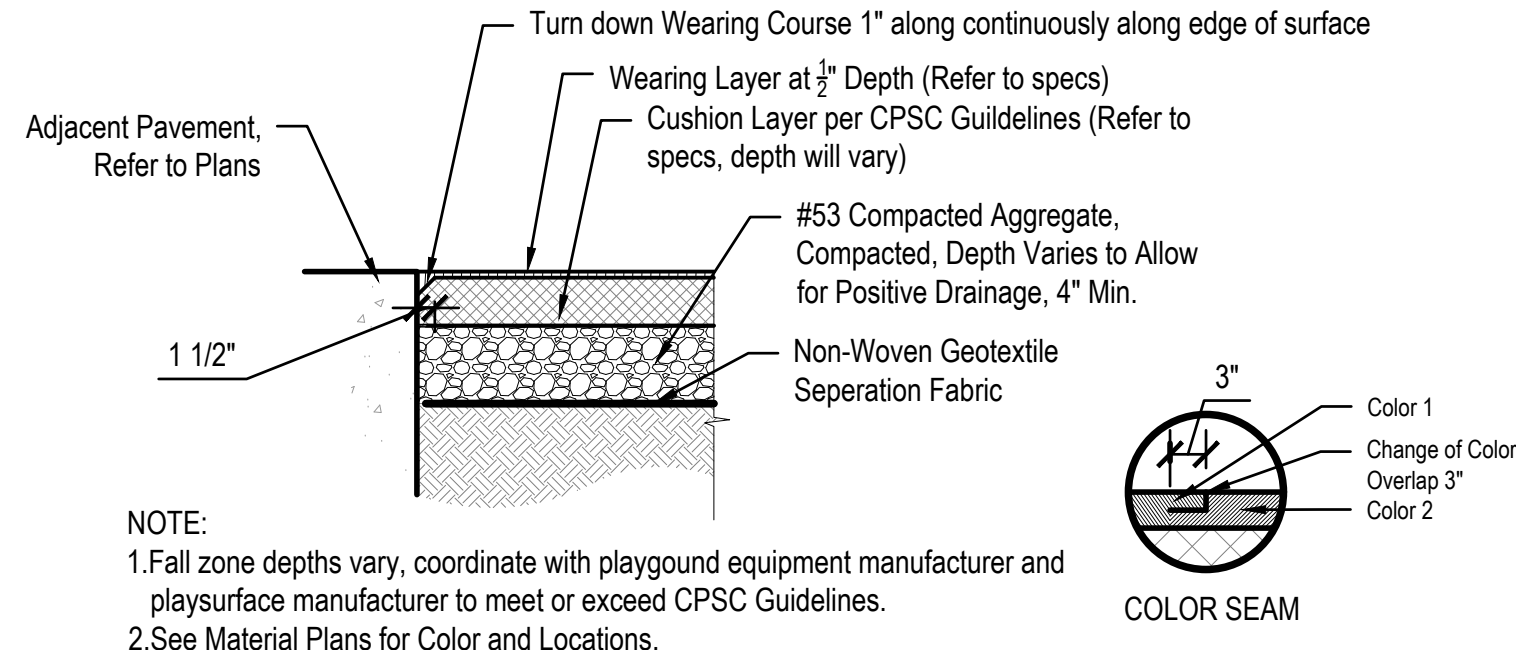

1 PLAYSURFACE, POURED IN PLACE ON AGGREGATE
Scale: 3/4" = 1'-0"

Revision	Date	Description

Date:	2024-03-08
Project No:	24-1727
Drawn by:	DC
Checked by:	LM

These Drawings and Specifications, and all copies thereof are and shall remain the property and copyright of the Landscape Architect. They shall be used only with respect to this Project and are not to be used on any other Project or Work without prior written permission from the Landscape Architect.