







1. REFER TO SHEET C201 FOR STRUCTURE TABLE.
2. REFER TO SHEET C101 FOR GENERAL NOTES.
3. SEE SUBSURFACE DRAIN PLAN (C610) FOR MORE DETAILS.
4. ALL TRUNCATED DOME PLATES SHALL BE BLACK.
5. ALL TRAFFIC CONTROL AND STREET SIGNAGE AND POSTS SHALL BE BLACK.
6. A 4" WIDE YELLOW THERMOPLASTIC STRIPING SHALL BE PLACED ON TOP OF CURBS ADJACENT TO ALL FIRE HYDRANTS ON ANY INTERNAL STREET WITHIN THIS SUBDIVISION - EXTENDING 10' OUT FROM ANY HYDRANT IN EITHER DIRECTION.

**ORIGINATING BENCHMARK:**  
BRASS DISK SET IN NORTHWEST WINGWALL OF A 32 FOOT CONCRETE  
BRIDGE OVER THE STANBURY AND SCHULTZ REGULATED DRAIN MONUMENT  
IS LEVEL WITH THE ROAD SURFACE. IT IS LOCATED 2 MILES SOUTH OF  
STATE ROAD 67, 281 FEET EAST OF THE CENTERLINE OF COUNTY ROAD  
600W N. AND 12.5 FEET NORTH OF THE CENTERLINE OF COUNTY ROAD  
705 N.  
ELEVATION = 856.83 (NAVD 88)

**TBM #1 CUT 'X' IN NINE TOP FLANGE BOLT ON FIRE HYDRANT AT NW  
CORNER OF INTERSECTION OF 750N & MCCORD STREET  
ELEVATION=856.09**

**TBM #2 TOP SSW FLANGE BOLT ON FIRE HYDRANT ALONG WEST SIDE OF  
600W AT GRAVEL DRIVE NEAR NORTHEAST CORNER OF SITE  
ELEVATION=856.34**

**TBM #3 TOP SSW FLANGE BOLT ON FIRE HYDRANT ALONG WEST SIDE OF  
600W 1090' SOUTH OF INTERSECTION OF 600W & 750N  
ELEVATION=859.93**

**TBM #4 TOP SSW FLANGE BOLT ON FIRE HYDRANT ALONG WEST SIDE OF  
600W 1595' SOUTH OF INTERSECTION OF 600W & 750N  
ELEVATION=860.32**

**TBM #5 TOP SSW FLANGE BOLT ON FIRE HYDRANT ALONG WEST SIDE OF  
600W 2070' SOUTH OF INTERSECTION OF 600W & 750N  
ELEVATION=869.04**

**TBM #6 TOP SSW FLANGE BOLT ON FIRE HYDRANT ALONG WEST SIDE OF  
600W 3225' SOUTH OF INTERSECTION OF 600W & 750N  
ELEVATION=867.60**

CONTRACTOR SHALL VERIFY LOCATION AND DEPTH OF ALL EXISTING UTILITIES PRIOR TO CONSTRUCTION TO CONFIRM THERE ARE NO CROSSING CONFLICTS. CONFLICTS THAT ARE DISCOVERED AFTER CONSTRUCTION BEGINS ARE SOLELY THE CONTRACTOR'S RESPONSIBILITY.

	PROPOSED SANITARY MANHOLE
	PROPOSED FIRE HYDRANT ASSEMBLY
	EXISTING CONTOUR
	EXISTING SANITARY SEWER
	EXISTING STORM SEWER
	PROPOSED SANITARY SEWER
	PROPOSED STORM SEWER
	PROPOSED GRADE
	PROPOSED CONTOUR
	PROPOSED WATER LINE
	PROPOSED SWALE
	CONSTRUCTION LIMITS
	PROPOSED 5' SIDEWALK (BY HOME BUILDER) (DEVELOPER SHALL INSTALL SIDEWALKS ALONG ALL COMMON AREAS)
	ADA RAMP TO BE INSTALLED
	RIP--RAP
	LOT NUMBER PAD ELEVATION
	PROPOSED 4" UNDERDRAINS
	LAKE SPILLWAY ROUTING
MFF XXX.X	MINIMUM FINISH FLOOR ELEVATION IS BASED OFF OF THE BELOW
	1. (1) FOOT ABOVE THE NEAREST UPSTREAM OR DOWNSTREAM SANITARY MANHOLE, WHICHEVER IS LOWEST.
	2. 15' (1.25') ABOVE THE ROAD ELEV.
	3. 6" (0.5') ABOVE THE MLAG
MLAG XXX.X	MINIMUM LOWEST ADJACENT GRADE (FLOOD PROTECTION)

STR.NO.	STR. TYPE	CASTING TYPE	T.O.C.	INCOMING PIPE DATA	OUTGOING PIPE DATA
EX.536	EX. MH	EXIST	855.17	15" R.C.P. (W) INV.=849.15	
528	TYPE "A" INLET	NEENAH R-2560	854.50		12" R.C.P. (E) INV.=851.44
529	DBL. TYPE "A" INLETS	NEENAH R-3501-TR&TL	856.35	12" R.C.P. (W) INV.=850.99	15" R.C.P. (E) INV.=850.99
530	TYPE "A" INLET	NEENAH R-3501-1L	856.05	15" R.C.P. (W) INV.=850.86	15" R.C.P. (E) INV.=850.86
532	TYPE "A" INLET	NEENAH R-2560	853.64	12" R.C.P. (E) INV.=850.14	15" R.C.P. (S) INV.=850.14
533	TYPE "C" MH	NEENAH R-2501	853.96	15" R.C.P. (N) INV.=849.75 12" R.C.P. (W) INV.=849.75 15" R.C.P. (E) INV.=849.75	24" R.C.P. (S) INV.=849.75
534C	TYPE "A" INLET	NEENAH R-2560	853.54		12" R.C.P. (E) INV.=849.7
534A	TYPE "C" MH	NEENAH R-2560	853.80	24" R.C.P. (N) INV.=849.48 12" R.C.P. (W) INV.=849.48	24" R.C.P. (SE) INV.=849.48
534B	TYPE "A" INLET	NEENAH R-3501-TR	854.69	12" R.C.P. (NE) INV.=850.11	12" R.C.P. (W) INV.=850.11
534	TYPE "C" MH	NEENAH R-3501-TR	854.73	24" R.C.P. (NW) INV.=849.42 12" R.C.P. (E) INV.=849.42	12" R.C.P. (S) INV.=849.42
535	TYPE "A" INLET	NEENAH R-3501-TR	854.78	24" R.C.P. (N) INV.=849.32	24" R.C.P. (S) INV.=849.32
536A	TYPE "A" INLET	NEENAH R-2560	853.62		12" R.C.P. (SW) INV.=850.33
537	TYPE "A" INLET	NEENAH R-3402-E	854.47		12" R.C.P. (E) INV.=850.7
538	TYPE "A" INLET	NEENAH R-3402-E	853.81		15" R.C.P. (W) INV.=850.11
539	TYPE "A" INLET	NEENAH R-3501-TR	853.76		12" R.C.P. (W) INV.=850.33
540	TYPE "A" INLET	NEENAH R-3501-TR	853.96	12" R.C.P. (E) INV.=850.21	12" R.C.P. (W) INV.=850.21

EXTR. NO.	STR. TYPE / CASTING TYPE	T.O.C.	INCOMING PIPE DATA		OUTGOING PIPE DATA	
744	48" SAN MH	857.60			8 SDR-35 PVC (S) INV.=852.68	
750	48" SAN MH	855.20	8" PVC (E)	INV.=844.91	8 PVC (N)	INV.=844.91
751	48" SAN MH	855.00	8" PVC (S)	INV.=845.56	8 PVC (W)	INV.=845.46
752	48" SAN MH	854.80	8" PVC (E) 8" PVC (W) 8" PVC (S)	INV.=846.13 INV.=846.13 INV.=846.90	8 PVC (N)	INV.=845.84
753	48" SAN MH	854.70	8" PVC (SW)	INV.=849.67	8 PVC (N)	INV.=847.41
754	48" SAN MH	856.40	8" PROPOSED SANITARY (SW)	INV.=850.62	8 PVC (NE)	INV.=850.07
755	48" SAN MH	857.00	8 PROPOSED SANITARY (NE) INV.=850.07			
756	48" SAN MH	855.50	8 PVC (E) INV.=847.30			
757	48" SAN MH	856.10	8 PVC (W) INV.=847.32			
EX	EX. MH	853.40	8" PVC (S)	INV.=843.08		
EX.743	EX. MH	858.80	8" SDR-35 PVC (N)	INV.=851.94		





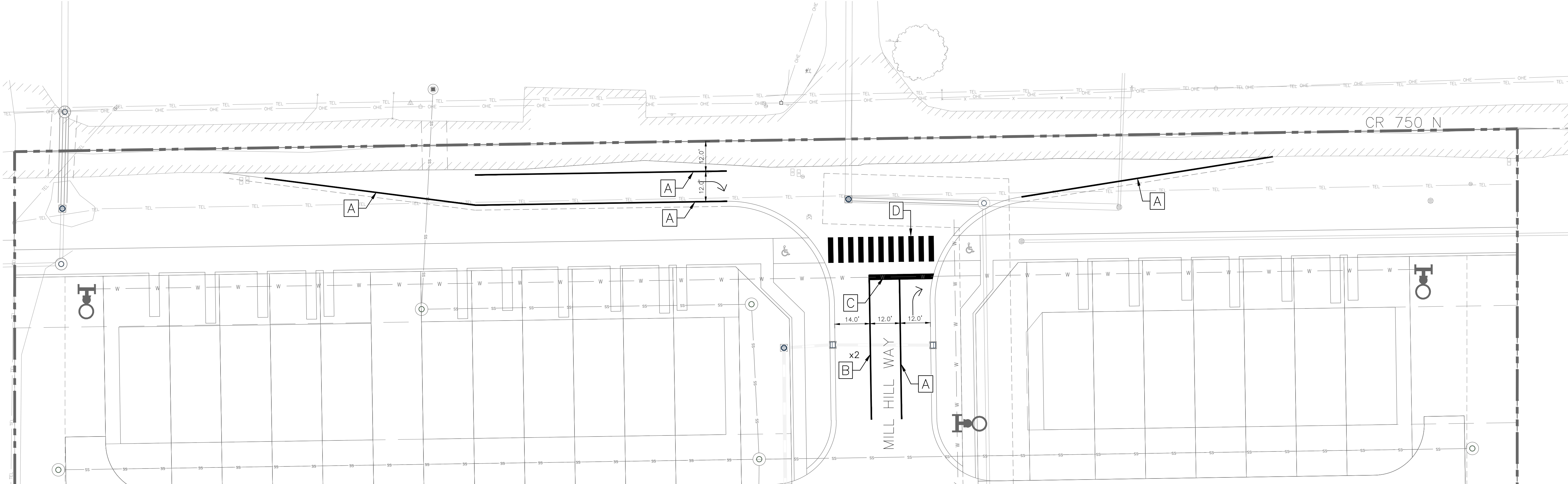

This document, together with the concepts and designs presented herein, as an instrument of service, is intended only for the specific purpose and client for which it was prepared. Rouse of and improper reliance on this document without written authorization and adaptation by Kinley-Horn and Associates, Inc. shall be without liability to Kinley-Horn and Associates, Inc.



## NOTES

1. MILL EXISTING MARKINGS AS NECESSARY THAT ARE IN CONFLICT WITH PROPOSED MARKINGS
2. A 4" WIDE YELLOW THERMOPLASTIC STRIPING SHALL BE PLACED ON TOP OF CURB ADJACENT TO ALL FIRE HYDRANT ON ANY INTERNAL STREET WITHIN THIS SUBDIVISION - EXTENDING 10' OUT FROM ANY HYDRANT IN EITHER DIRECTION

## LEGEND

- |   |   |
|---|---|
|  | 4" WHITE THERMOPLASTIC SINGLE WHITE EDGE LINE   |
|  | 4" YELLOW, THERMOPLASTIC, DOUBLE LINE           |
|  | 24" WIDE THERMOPLASTIC STOP BAR                 |
|  | 24" WIDE WHITE THERMOPLASTIC CROSS WALK STRIPES |
|  | THERMOPLASTIC LANE INDICATION ARROW             |

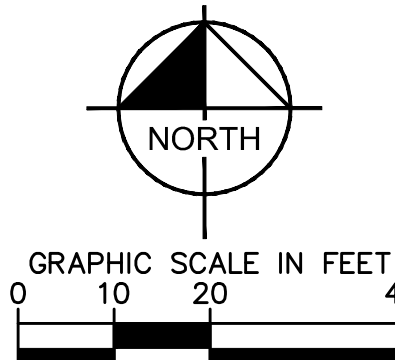

Indiana Utilities Protection Servi

**Call 811**  
before you dig

## AMPTON WALK SECTION 4

GRAND  
COMMUNITIES,  
LLC

APPROVAL PENDING  
NOT FOR  
CONSTRUCTION

SCALE: AS NOTED

# «Kimlev» Horn

© 2023 KIMLEY-HORN AND ASSOCIATES, INC.  
 100 EAST 96TH STREET, SUITE 300,  
 INDIANAPOLIS, IN 46240  
 CONTACT: JOHN McWHORTER  
 PHONE: 317-912-4123

MAIL: John.McWhorter@kimley-horn.com

DEVISIONS

DATE	DV
------	----





ROAD NAME SIGN	2
STOP SIGN	6
SPEED LIMIT SIGN	1
LIGHTING	5
NO PARKING THIS SIDE	

1. ALL TRAFFIC CONTROL SIGNS SHALL MEET CHAPTER 2D: GUIDE SIGNS—CONVENTIONAL ROADS OF THE MUTCD MANUAL LATEST EDITION.
2. ALL TRAFFIC CONTROL AND STREET SIGNS SHALL UTILIZE THE TOWN OF MCCORDSVILLE STANDARD POLE. SEE TOWN'S SPECIFICATIONS.
3. BLACK POWDER—COATED POSTS ARE REQUIRED FOR ALL TRAFFIC CONTROL & STREET SIGNAGE.
4. LIGHT POLE INSTALLATION SUBJECT TO FUTURE ROUNDABOUT CONSTRUCTION. CONTRACTOR TO COORDINATE WITH THE TOWN OF MCCORDSVILLE PRIOR TO INSTALLATION.

1. ALL TRAFFIC CONTROL SIGNS SHALL MEET CHAPTER 2D: GUIDE SIGNS—CONVENTIONAL ROADS OF THE MUTCD MANUAL LATEST EDITION.
2. ALL TRAFFIC CONTROL AND STREET SIGNS SHALL UTILIZE THE TOWN OF MCCORDSVILLE STANDARD POLE. SEE TOWN'S SPECIFICATIONS.
3. BLACK POWDER—COATED POSTS ARE REQUIRED FOR ALL TRAFFIC CONTROL & STREET SIGNAGE.
4. LIGHT POLE INSTALLATION SUBJECT TO FUTURE ROUNDABOUT CONSTRUCTION. CONTRACTOR TO COORDINATE WITH THE TOWN OF MCCORDSVILLE PRIOR TO INSTALLATION.



Drawing name: K:\IND\_DEV\170227003\_Hampton\_Walk\_Sec4\_McCordville.IN\1 Design\CADD\planSheets\WATER PLAN.dwg C700 Sep 22, 2023 12:33pm by: boyGee  
This document, together with the concepts and designs presented herein, is intended only for the specific purpose and client for which it was prepared. Reuse of and improper reliance on this document without written authorization and adaptation by Kimley-Horn and Associates, Inc. shall be without liability to Kimley-Horn and Associates, Inc.

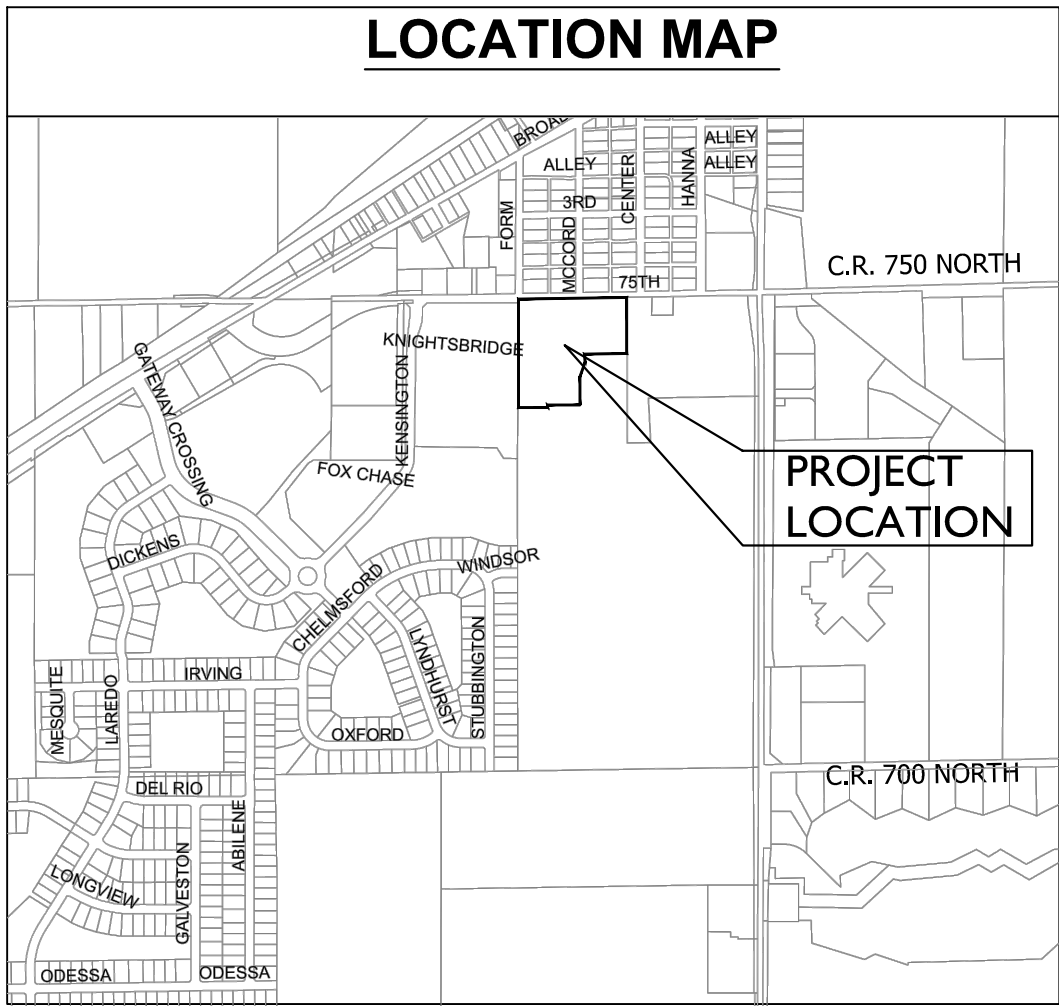
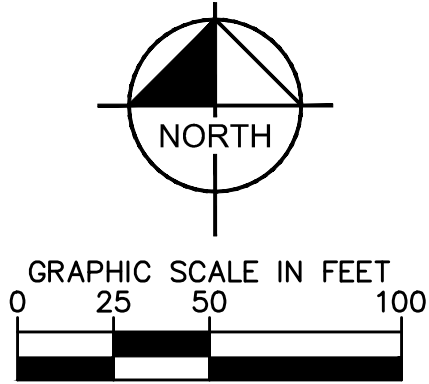
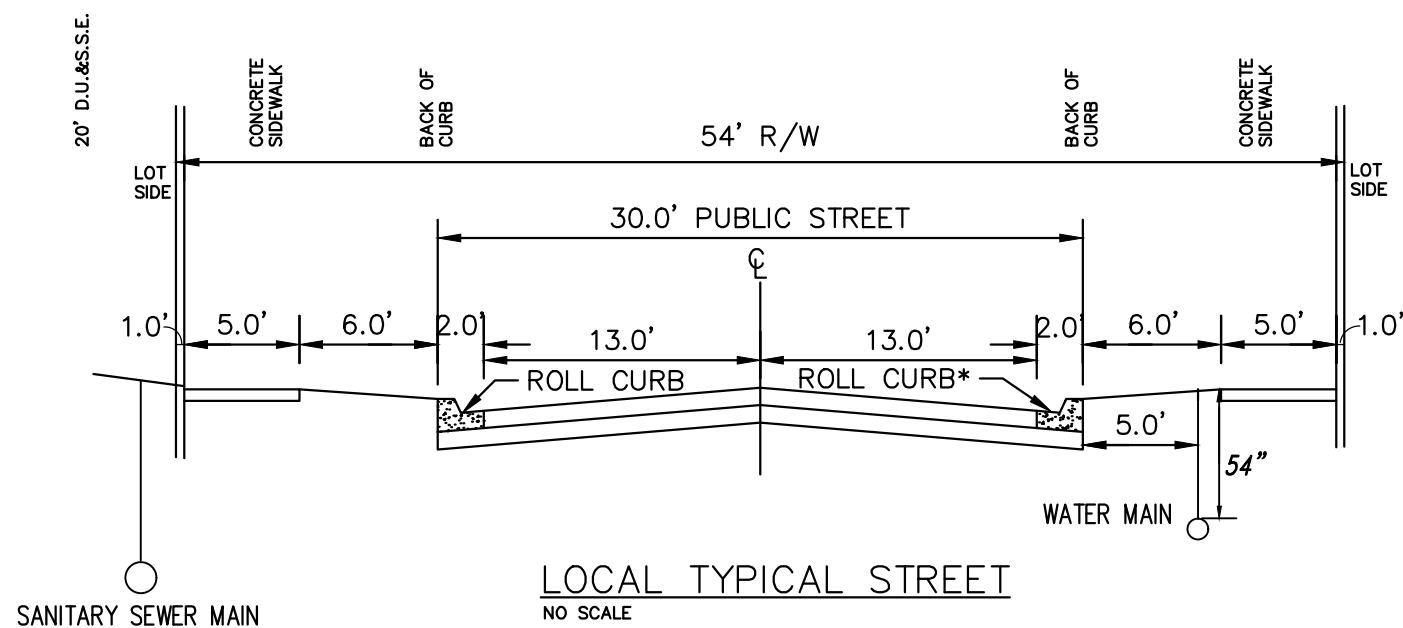
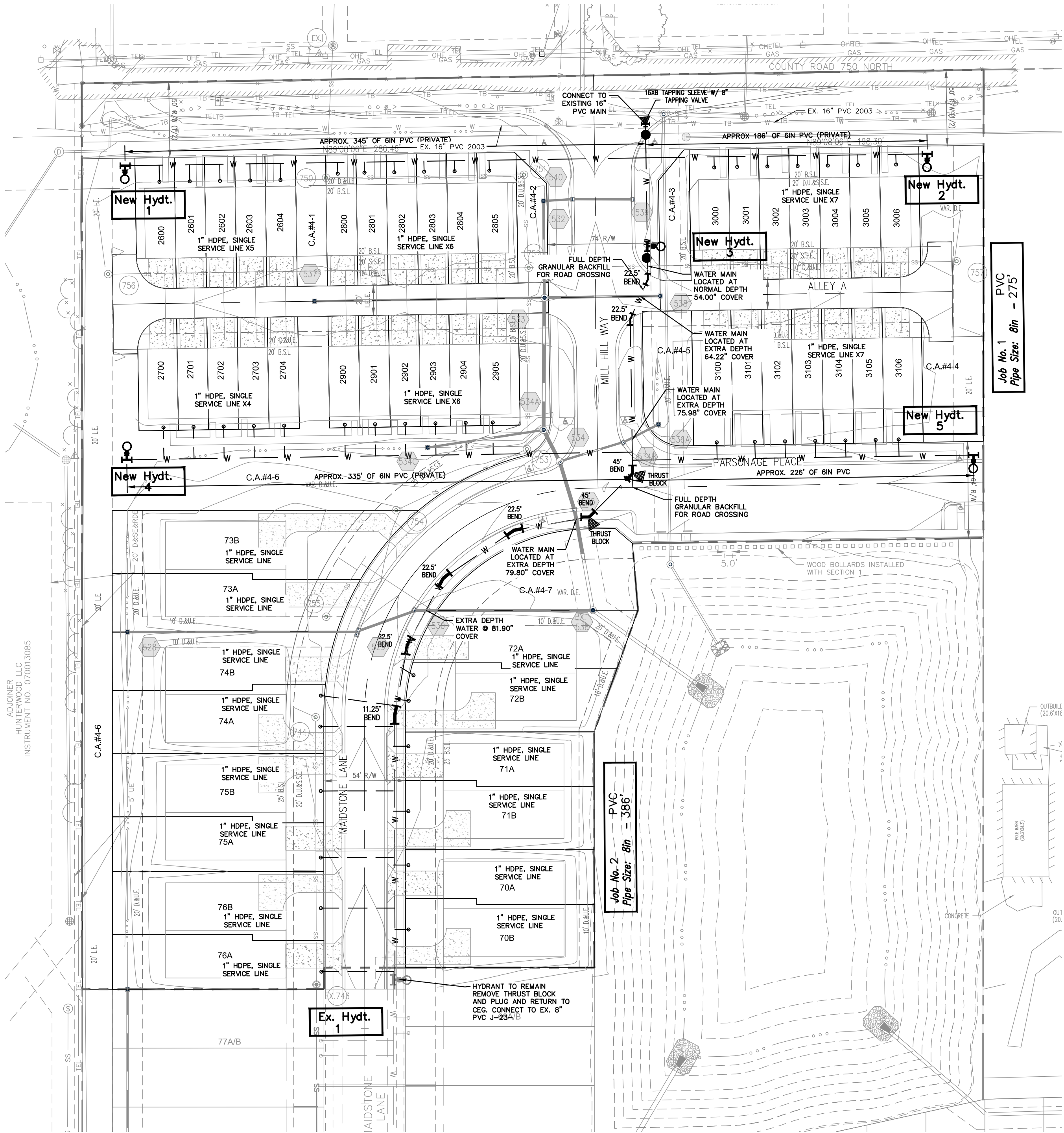

PROPOSED LEGEND

HYDRANT

HYDRANT WITH VALVE

VALVE

BEND

REDUCER

BLOWOFF

KICKER BLOCK

CROSS

TEE

PLUG

PROPOSED WATER

EXISTING WATER

1 - 1 - INCH WATER SERVICE LATERAL W/ 3/4 - INCH METER PIT FOR SINGLE SERVICES

NOTES

1. SEE CITIZENS 2023 WATER STANDARDS FOR THE INSTALLATION OF WATER MAINS, SERVICE LINES, METERS AND APPURTENANCES LATEST VERSION.

2. MINIMUM COVER OVER TOP OF ALL WATERMAINS TO BE 54" FROM FINISH GRADE.

3. VALVES ARE TO BE PLACED IN GRASS AREAS.

4. STANDARD PRACTICE "O" INSTALLATION OF RESTRAINTS MUST BE FOLLOWED DURING CONSTRUCTION OF WATER MAIN. ANY QUESTIONS, ASK CEG INSPECTOR.

5. ALL WATER MAINS MUST MAINTAIN A MINIMUM OF 10' HORIZONTAL SEPARATION AND A MINIMUM OF 18" VERTICAL SEPARATION FROM ALL SANITARY AND STORM SEWERS.

6. FULL DEPTH GRANULAR BACKFILL IS REQUIRED ON ALL ROAD CROSSINGS.

7. CONTRACTOR SHALL INSTALL TRACING WIRE ALONG ALL PIPE INSTALLATIONS.

8. HYDRANTS SHALL BE INSTALLED WITH A STORZ CONNECTION. REFER TO TABLE 7.07.1 OF THE 2023 CEG WATER STANDARDS MANUAL.

NOTE: ALL FIRE HYDRANTS SHOWN GRAPHICALLY TO BE INSTALLED BETWEEN CURB AND WALK PER CITIZENS STANDARDS.

CITIZENS WATER PROJECT LEGEND				
Project Name:		HAMPTON WALK SEC. 4		
Project Number:		J-23-107		
JOB #	Street Name	Pipe Size	Pipe Type	Total Pipe
1	MILL HILL WAY	8"	PVC	275'
2	MAIDSTONE LANE	8"	PVC	386'
# of Service Lines			TOTAL	1,704'
50	SERVICE LINE PIPE	1"	HDPE	1,200'

Project Name  
Project Number  
Dist. Map. No.  
Map Grid No.  
Tax Code  
Pressure Dist.  
Drafter  
Date

HAMPTON WALK, SECTION 4  
J-23-107  
846  
IN30\_0402  
50  
30016  
CUMBERLAND  
KIMLEY HORN/PCW  
09/21/2023

Indiana Utilities Protection Service



before you dig

Kimley»Horn

© 2023 KIMLEY-HORN AND ASSOCIATES, INC.  
500 EAST 96TH STREET, SUITE 300,  
INDIANAPOLIS, IN 46240  
PHONE: 317-912-4123  
EMAIL: john.mohr@kimley-horn.com  
WWW.KIMLEY-HORN.COM

SCALE: AS NOTED

DESIGNED BY: JSM

DRAWN BY: GPB

CHECKED BY: JSM

APPROVAL PENDING  
NOT FOR  
CONSTRUCTION

GRAND  
COMMUNITIES,  
LLC

WATER PLAN  
SECTION 4

ORIGINAL ISSUE:  
09/22/2023

KHA PROJECT NO.  
170227003

SHEET NUMBER  
C700

REVISIONS

DATE

BY



Drawing name: K:\IND\_LEV\170227003\_Hampton\_Walk\_Sec4\_McCordville.IN\1 Design\CADD\PlanSheets\LANDSCAPE PLAN.dwg LANDSCAPE PLAN Sep 22, 2023 12:07pm by: Jay/Gee  
This document, together with the concepts and designs presented herein, is intended only for the specific purpose and client for which it was prepared. Reuse of and improper reliance on this document without written authorization and adaptation by Kimley-Horn and Associates, Inc. shall be without liability to Kimley-Horn and Associates, Inc.

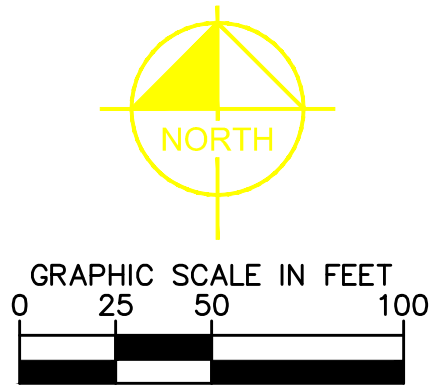
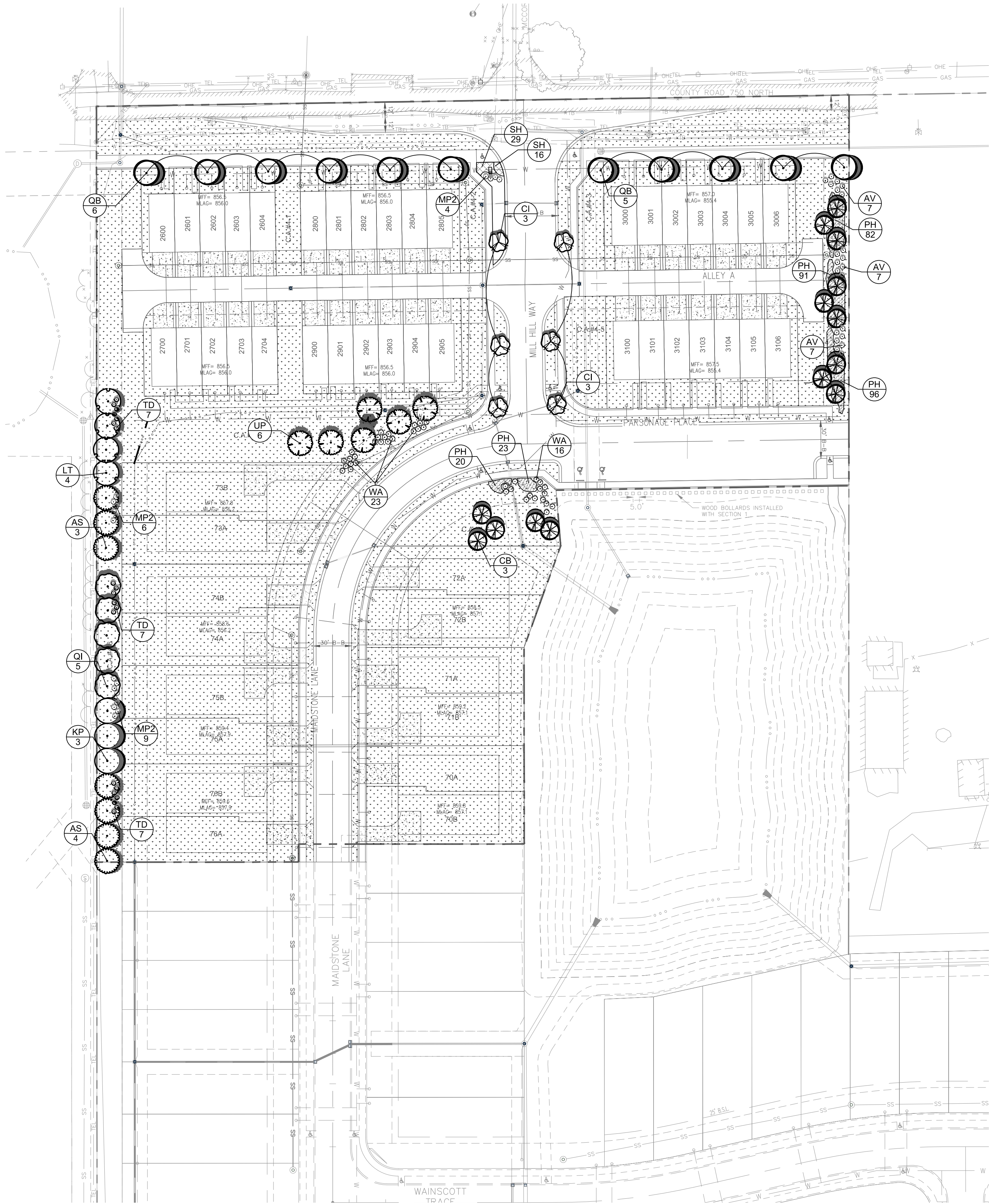

ORIGINAL ISSUE: 09/22/2023		HAMPTON WALK SECTION 4			SCALE: AS NOTED DESIGNED BY: JSM DRAWN BY: GPB CHECKED BY: JSM	 © 2023 KIMLEY-HORN AND ASSOCIATES, INC. 500 EAST 96TH STREET, SUITE 300, INDIANAPOLIS, IN 46240 PHONE: 317-912-4123 EMAIL: John.McMurtre@kimley-horn.com WWW.KIMLEY-HORN.COM	REVISIONS		BY				
SHEET NUMBER		LANDSCAPE PLAN					No.		DATE				
L100		GRAND COMMUNITIES, LLC											



