

Z:\2023\23005L-MEYER NAJEM, LAND DEV, MCCORDSVILLE POLICE STATION\DWG\2301-SITE PLAN\DWG plotted by STEVEN OFORUKE on 2/22/2023 2:04:38 PM (last saved by SCORUKE on 2/20/2023 2:58:27 PM
Xrefs: X:36\24E.DWG & 23005L_BASE SITE.DWG & 23005L_ARCH BASE.DWG & 23005L_BASE TOP.DWG & 23005L.DWG

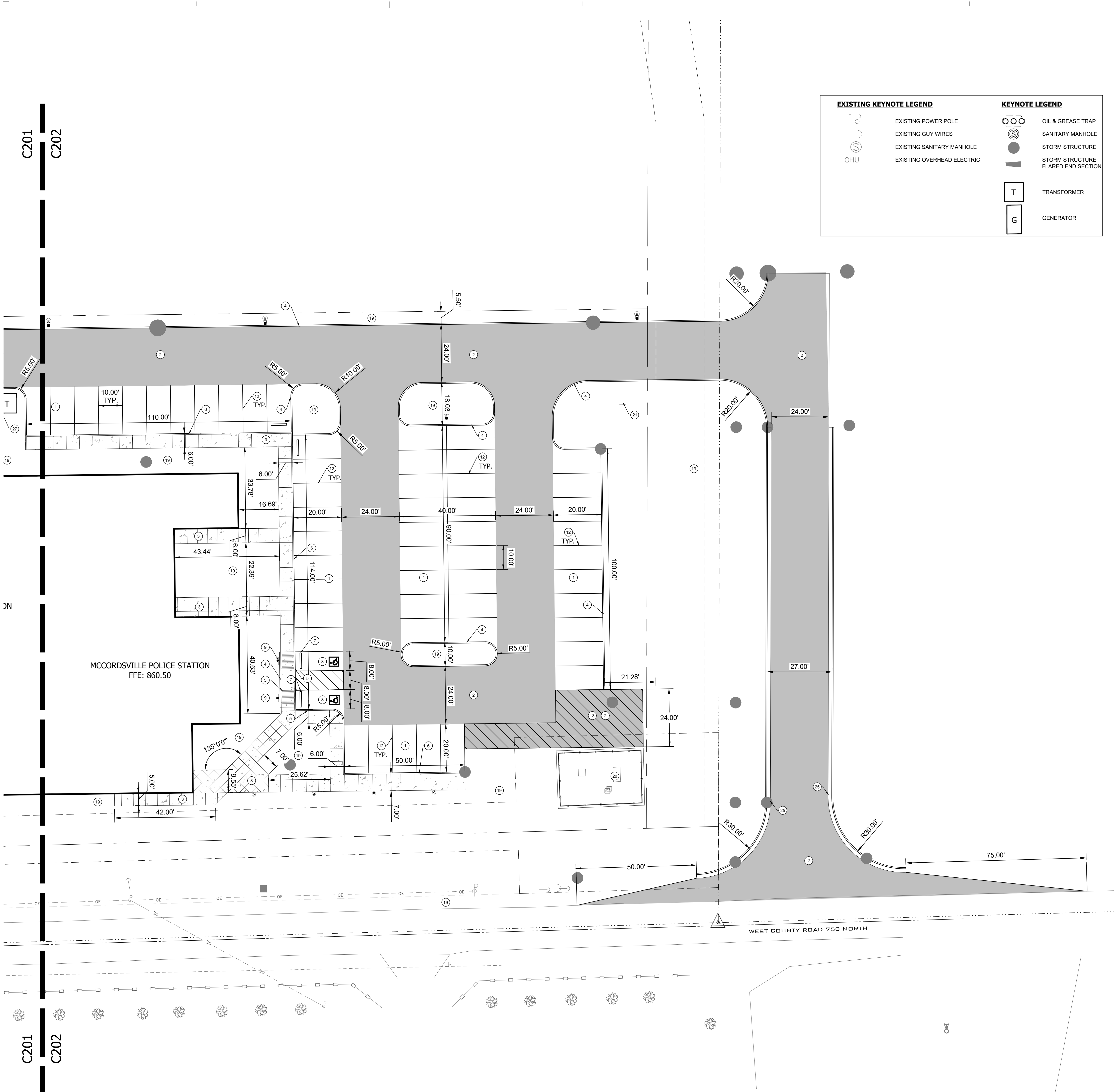

EXISTING KEYNOTE LEGEND		KEYNOTE LEGEND	
	EXISTING POWER POLE		OIL & GREASE TRAP
	EXISTING GUY WIRES		SANITARY MANHOLE
	EXISTING SANITARY MANHOLE		STORM STRUCTURE
	EXISTING OVERHEAD ELECTRIC		STORM STRUCTURE FLARED END SECTION
			TRANSFORMER
			GENERATOR

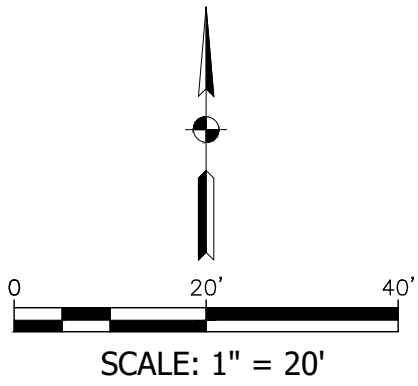

GENERAL SITE NOTES

- THE CONTRACTOR SHALL ENSURE THAT ALL NECESSARY PERMITS AND APPROVALS HAVE BEEN OBTAINED FROM AGENCIES HAVING JURISDICTION OVER THE WORK PRIOR TO COMMENCING CONSTRUCTION ACTIVITIES. THE CONTRACTOR SHALL OBTAIN AND PAY THE COST OF ALL PERMITS THAT HAVE NOT BEEN SECURED BY THE OWNER.
- THE CONTRACTOR SHALL COMPLY WITH THE CONSTRUCTION SAFETY STANDARDS AS ISSUED BY THE U.S. DEPARTMENT OF LABOR OCCUPATIONAL HEALTH AND SAFETY ADMINISTRATION AS SET FORTH IN FINAL RULE 29, PART 1926, WHERE SUCH REGULATIONS APPLY TO THE WORK.
- LOCATIONS OF UTILITIES SHOWN WITHIN THESE PLANS ARE BASED UPON INFORMATION OBTAINED FROM UTILITY COMPANIES OR THEIR REPRESENTATIVES AND FIELD EVIDENCE OF IMPROVEMENTS VISIBLE ON THE GROUND SURFACE. EXACT LOCATIONS OF UNDERGROUND UTILITIES HAVE NOT BEEN VERIFIED. THE CONTRACTOR SHALL NOTIFY UTILITY COMPANIES AND REQUEST FIELD LOCATIONS OF SUCH WITHIN THE WORK AREA PRIOR TO COMMENCING EXCAVATION ACTIVITIES. THE CONTRACTOR SHALL REPORT ANY VARIATIONS FROM THE LOCATIONS SHOWN THAT MAY PRESENT A CONFLICT WITH EXECUTION OF THE WORK TO THE ENGINEER IN ADVANCE OF CONSTRUCTION.
- THE CONTRACTOR SHALL COORDINATE WITH THE RESPECTIVE UTILITY COMPANIES AND SHALL PAY THE COST OF PROTECTION, RELOCATION, REMOVAL, CONNECTION, AND/OR RECONNECTION OF UTILITIES AS NECESSARY FOR EXECUTION OF THE WORK.
- MATERIALS AND WORKMANSHIP SHALL COMPLY WITH ALL APPLICABLE CODES, SPECIFICATIONS, LOCAL ORDINANCES, INDUSTRY STANDARDS AND UTILITY COMPANY REGULATIONS.
- IF IT WILL BE NECESSARY TO RELOCATE EXISTING UTILITIES, THE EXPENSE OF SUCH RELOCATION SHALL BE THE RESPONSIBILITY OF THE DEVELOPER. ALL UTILITY POLES SHALL BE LOCATED WITHIN ONE FOOT OF THE PROPOSED RIGHT-OF-WAY.
- NO EARTH DISTURBING ACTIVITY MAY COMMENCE WITHOUT AN APPROVED STORM WATER MANAGEMENT PERMIT.
- ALL DIMENSIONS ARE TO FACE OF CURB, EDGE OF PAVEMENT OR FACE OF BUILDING

SITE DEVELOPMENT PLAN NOTES

- ALL DIMENSIONS ARE MEASURED TO THE FACE OF CURB, EDGE OF PAVEMENT OR THE FACE OF BUILDING UNLESS OTHERWISE SHOWN.
- BEARINGS, DIMENSIONS AND EASEMENTS ARE SHOWN FOR REFERENCE. REFER TO RECORDED PLATS AND SURVEYS FOR ADDITIONAL PROPERTY INFORMATION.
- REFER TO ARCHITECTURAL PLANS FOR BUILDING DIMENSIONS AND DETAILS.
- TRANSVERSE EXPANSION JOINTS ARE TO BE PROVIDED IN CONCRETE SIDEWALKS AND COMBINED WALKS/CURBS WHERE SHOWN AND AT INTERVALS NOT TO EXCEED 12 x THE WIDTH OF THE WALK.
- EXPANSION JOINTS SHALL BE INSTALLED IN CONCRETE PAVEMENTS AND WALKS AT ALL LOCATIONS WHERE PAVEMENTS AND WALKS ABUT A VERTICAL SURFACE SUCH AS A CURB, WALL, COLUMN, ETC.
- CONTRACTION JOINTS SHALL BE PROVIDED AT EQUAL INTERVALS BETWEEN EXPANSION JOINTS IN CONCRETE WALKS. INSTALL CONTRACTION JOINTS AS SHOWN BUT IN NO CASE AT INTERVALS GREATER THAN 1.5 x THE WIDTH OF THE WALK.

SITE PLAN KEY NOTE LEGEND

- 1 LIGHT DUTY ASPHALT (SEE DETAIL SHEETS)
- 2 HEAVY DUTY ASPHALT (SEE DETAIL SHEETS)
- 3 4" THICK PROPOSED CONCRETE SIDEWALK (SEE DETAIL SHEETS)
- 4 CONCRETE STANDING CURB (SEE DETAIL SHEETS)
- 5 CONCRETE CURB TAPER (SEE DETAIL SHEETS)
- 6 COMBINED CURB AND SIDEWALK (SEE DETAIL SHEETS)
- 7 CONCRETE PARKING BUMPER (SEE DETAIL SHEETS)
- 8 ADA PARKING (SEE DETAIL SHEETS)
- 9 ADA SIGN (SEE DETAIL SHEETS)
- 10 ADA ACCESSIBLE RAMP (SEE DETAIL SHEETS)
- 11 FLUSH CONDITION CONCRETE SIDEWALK
- 12 PARKING STRIPE, 4" WHITE PAINT STRIPE (SEE DETAIL SHEETS)
- 13 NO PARKING ZONE, 4" WHITE PAINT STRIPE. (SEE DETAIL SHEETS)
- 14 6' TALL BLACK ALUMINUM / WROUGHT IRON STYLE ANTI-RAM BARRIER SLIDING SECURITY GATE. (SEE DETAIL SHEETS)
- 15 6' TALL BLACK ALUMINUM SECURITY FENCE / WROUGHT IRON STYLE. (SEE DETAIL SHEETS)
- 16 30" X 30" X 6' MASONRY BRICK COLUMN (BRICK & COLOR BY OWNER / ARCHITECT). (SEE DETAIL SHEETS)
- 17 6' TALL MASONRY BRICK WALL (BRICK TO MATCH BUILDING). (SEE DETAIL SHEETS)
- 18 6' TALL BRICK MASONRY DUMPSTER ENCLOSURE (12x20'). BRICK & COLOR BY OWNER. (SEE DETAIL SHEETS)
- 19 LANDSCAPE / TURF AREA. SEE 'L' SERIES PLANS.
- 20 EXISTING SANITARY LIFT STATION AREA
- 21 8' X 3' X 5' MASONRY MONUMENT SIGN
- 22 EXISTING DEVELOPMENT POND
- 23 EXISTING DEVELOPMENT AMENITY TRAIL
- 24 HEAVY DUTY CONCRETE PAVEMENT
- 25 CURB & GUTTER
- 26 PER MANUFACTURERS SPECIFICATIONS
- 27 PER NINESTAR SPECIFICATIONS



REVISIONS



PREPARED FOR:

Meyer Najem
11787 Lantern Rd. #100
Fishers, IN 46038
(317) 577-0007

PROJECT TITLE:

LAND DEVELOPMENT
MCCORDSVILLE
POLICE DEPARTMENT

SEAL | DATE

PRELIMINARY
.....
NOT TO BE USED FOR
CONSTRUCTION



8365 Keystone Crossing, Suite 201
Indianapolis, IN 46240 (317) 202-0864

Drawn By
SO

Issue Date
03/01/2023

Checked By
MM

Project No:
23005L

Sheet Title:

SITE PLAN

SHEET NUMBER:
C202

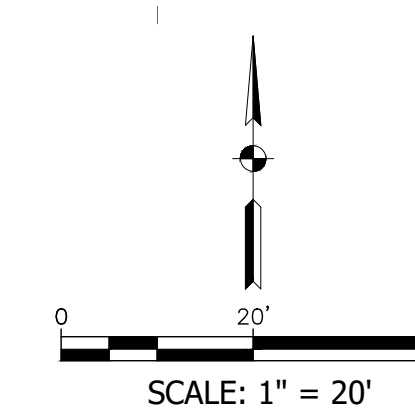

1. THE CONTRACTOR SHALL ENSURE THAT ALL NECESSARY PERMITS AND APPROVALS HAVE BEEN OBTAINED FROM AGENCIES HAVING JURISDICTION OVER THE WORK PRIOR TO COMMENCING CONSTRUCTION ACTIVITIES. THE CONTRACTOR SHALL OBTAIN AND PAY THE COST OF ALL PERMITS THAT HAVE NOT BEEN SECURED BY THE OWNER.
2. THE CONTRACTOR SHALL COMPLY WITH THE CONSTRUCTION SAFETY STANDARDS AS ISSUED BY THE U.S. DEPARTMENT OF LABOR OCCUPATIONAL HEALTH AND SAFETY ADMINISTRATION AS SET FORTH IN FINAL RULE 29, PART 1926, WHERE SUCH REGULATIONS APPLY TO THE WORK.
3. LOCATIONS OF UTILITIES SHOWN WITHIN THESE PLANS ARE BASED UPON INFORMATION OBTAINED FROM UTILITY COMPANIES OR THEIR REPRESENTATIVES AND FIELD EVIDENCE OF IMPROVEMENTS VISIBLE ON THE GROUND SURFACE. EXIST LOCATIONS OF UNDERGROUND UTILITIES HAVE NOT BEEN VERIFIED. THE CONTRACTOR SHALL NOTIFY UTILITY COMPANIES AND REQUEST FIELD LOCATIONS OF SUCH WITHIN THE WORK AREA PRIOR TO COMMENCING EXCAVATION ACTIVITIES. THE CONTRACTOR SHALL INSTRUCT ANY VANDALISM OR CONSTRUCTION SHOW THAT MAY PRESENT A COMPAT WITH EXECUTION OF THE WORK TO THE ENGINEER IN ADVANCE OF CONSTRUCTION.
4. THE CONTRACTOR SHALL COORDINATE WITH THE RESPECTIVE UTILITY COMPANIES AND SHALL PAY THE COST OF PROTECTION, RELOCATION, REMOVAL, CONNECTION, AND/OR RECONNECTION OF UTILITIES AS NECESSARY FOR EXECUTION OF THE WORK.
5. MATERIALS AND WORKMANSHIP SHALL COMPLY WITH ALL APPLICABLE CODES, SPECIFICATIONS, LOCAL ORDINANCES, INDUSTRY STANDARDS AND UTILITY COMPANY REGULATIONS.
6. IF IT WILL BE NECESSARY TO RELOCATE EXISTING UTILITIES, THE EXPENSE OF SUCH RELOCATION SHALL BE THE RESPONSIBILITY OF THE DEVELOPER. ALL UTILITY POLES SHALL BE LOCATED WITHIN ONE FOOT OF THE PROPOSED RIGHT-OF-WAY.
7. NO EARTH DISTURBING ACTIVITY MAY COMMENCE WITHOUT AN APPROVED STORM WATER MANAGEMENT PERMIT.
8. ALL DIMENSIONS ARE TO FACE OF CURB, EDGE OF PAVEMENT OR FACE OF BUILDING.

1. ALL DIMENSIONS ARE MEASURED TO THE FACE OF CURB, EDGE OF PAVEMENT OR THE FACE OF BUILDING UNLESS OTHERWISE SHOWN.
2. BEARINGS, DIMENSIONS AND EASEMENTS ARE SHOWN FOR REFERENCE. REFER TO RECORDED PLATS AND SURVEYS FOR ADDITIONAL PROPERTY INFORMATION.
3. REFER TO ARCHITECTURAL PLANS FOR BUILDING DIMENSIONS AND DETAILS.
4. TRANSVERSE EXPANSION JOINTS ARE TO BE PROVIDED IN CONCRETE SIDEWALKS AND COMBINED WALKS/CURBS WHERE SHOWN AND AT INTERVALS NOT TO EXCEED 12 x THE WIDTH OF THE WALK.
5. EXPANSION JOINTS SHALL BE INSTALLED IN CONCRETE PAVEMENTS AND WALKS AT ALL LOCATIONS WHERE PAVEMENTS AND WALKS ABUT A VERTICAL SURFACE SUCH AS A CURB, WALL, COLUMN, ETC.
6. CONTRACTION JOINTS SHALL BE PROVIDED AT EQUAL INTERVALS BETWEEN EXPANSION JOINTS IN CONCRETE WALKS. INSTALL CONTRACTION JOINTS AS SHOWN BUT IN NO CASE AT INTERVALS GREATER THAN 1.5 x THE WIDTH OF THE WALK.

- 1 LIGHT DUTY ASPHALT (SEE DETAIL SHEETS)
- 2 HEAVY DUTY ASPHALT (SEE DETAIL SHEETS)
- 3 4" THICK PROPOSED CONCRETE SIDEWALK (SEE DETAIL SHEETS)
- 4 CONCRETE STANDING CURB (SEE DETAIL SHEETS)
- 5 CONCRETE CURB TAPER (SEE DETAIL SHEETS)
- 6 COMBINED CURB AND SIDEWALK (SEE DETAIL SHEETS)
- 7 CONCRETE PARKING BUMPER (SEE DETAIL SHEETS)
- 8 ADA PARKING (SEE DETAIL SHEETS)
- 9 ADA SIGN (SEE DETAIL SHEETS)
- 10 ADA ACCESSIBLE RAMP (SEE DETAIL SHEETS)
- 11 FLUSH CONDITION CONCRETE SIDEWALK
- 12 PARKING STRIPE. 4" WHITE PAINT STRIPE. (SEE DETAIL SHEETS)
- 13 NO PARKING ZONE. 4" WHITE PAINT STRIPE. (SEE DETAIL SHEETS)
- 14 6' TALL BLACK ALUMINUM / WROUGHT IRON STYLE ANTI-RAM BARRIER SLIDING SECURITY GATE. (SEE DETAIL SHEETS)
- 15 6' TALL BLACK ALUMINUM SECURITY FENCE / WROUGHT IRON STYLE. (SEE DETAIL SHEETS)
- 16 30" X 30" X 6' MASONRY BRICK COLUMN (BRICK & COLOR BY OWNER / ARCHITECT). (SEE DETAIL SHEETS)
- 17 6' TALL MASONRY BRICK WALL (BRICK TO MATCH BUILDING). (SEE DETAIL SHEETS)
- 18 6' TALL BRICK MASONRY DUMPSTER ENCLOSURE (12'X20'). BRICK & COLOR BY OWNER. (SEE DETAIL SHEETS)
- 19 LANDSCAPE / TURF AREA. SEE 'L' SERIES PLANS.
- 20 EXISTING SANITARY LIFT STATION AREA
- 21 8' X 3' X 5' MASONRY MONUMENT SIGN
- 22 EXISTING DEVELOPMENT POND
- 23 EXISTING DEVELOPMENT AMENITY TRAIL
- 24 HEAVY DUTY CONCRETE PAVEMENT
- 25 CURB & GUTTER
- 26 PER MANUFACTURERS SPECIFICATIONS
- 27 PER NINESTAR SPECIFICATIONS

[illegible]

Z:\2023\23005L-MEYER NAJEM, LAND DEV. MCCORDSVILLE POLICE STATION\DWGS\201-SITE PLAN.DWG plotted by STEVEN O'ROURKE on 2/22/2023 1:51:43 PM last saved by SOROURKE on 2/20/2023 2:58:27 PM
Xrefs: X36X24E.DWG & 23005L_BASE SITE.DWG & 23005L_ARCH BASE.DWG & 23005L_PLAT.DWG & 23005L_BASE TOPO.DWG & 42X30.DWG